

Parts List

DOVER

COMMERCIAL SUPER-SIX



JULY
1929

SERIAL NO. 10001
AND UPWARD

HUDSON MOTOR CAR COMPANY
DETROIT, MICHIGAN, U. S. A.

Printed in U. S. A.

Vj kú'F qewo gpv'Eqtvgu{ "qh
"J GV'O go dgt'Tle'Rkpf gt

DESMOND V. CROSSLEY
18 RED OAK AVE.
SCARBOROUGH, CANADA
HUDSON CITY, N.Y.

PARTS LIST

DOVER

JULY
1929

IMPORTANT

The use of genuine Dover parts will insure the satisfactory operation of your car.

There are Hudson-Essex distributors and dealers in all principal cities and towns, who will supply genuine Dover parts.

Hudson Motor Car Company
DETROIT, MICHIGAN

Warranty

The factory obligation with respect to replacement of alleged defective parts is fully covered by our warranty as follows:

"We warrant each new vehicle manufactured by us, whether passenger car or commercial vehicle, to be free from defects in material under normal use and service, our obligation under this warranty being limited to making good any part or parts thereof which shall, within ninety (90) days after delivery of such vehicle to the original purchaser, be returned to us with transportation charges prepaid, and which our examination shall disclose to our satisfaction to have been thus defective.

"This warranty is expressly in lieu of all other warranties expressed or implied, and of all other obligations or liabilities on our part, and we neither assume nor authorize any other person to assume for us any other liability in connection with the sale of our vehicles.

"This warranty shall not apply to any Dover commercial car which shall have been repaired or altered outside of our factory in any way so as, in our judgment, to affect its stability or reliability, or which has been subject to misuse, negligence, or accident, or which shall have been operated at a speed exceeding the factory rated speed, or loaded beyond the factory rated load capacity.

"We make no warranty whatsoever in respect to tires, rims, ignition apparatus, tops, upholstery, horns, or other signaling devices, batteries, speedometers, or other trade accessories."

HUDSON MOTOR CAR COMPANY

Detroit, Michigan

The factory does not participate in any labor costs incident to the replacement of parts under the warranty. The warranty under which Dover commercial cars are sold will be interpreted by the Distributor or Dealer from whom the vehicle was purchased.

INSTRUCTIONS FOR ORDERING PARTS

- 1—Order parts through the nearest Distributor or Dealer.
- 2—Always give PART NUMBER and NAME of each part ordered.
- 3—Mail and Parcel Post orders should be accompanied by an amount sufficient to cover POSTAGE.
- 4—Specify how shipments are to be made.
- 5—Orders for parts should be written separately from correspondence pertaining to other matters.

TELEGRAPH CODE

To save expense, to expedite ordering and for your convenience, we list below a brief General Code covering miscellaneous instructions, questions and answers relative to the shipment of parts:

- | | |
|---|---|
| <i>Sultex</i> —Ship to me (us) by express. | <i>Sulwire</i> —When and how did you ship parts |
| <i>Sulcline</i> —Ship by express to | called for in my (our) telegram of |
| <i>Sulgate</i> —Ship to me (us) by freight. | <i>Sultwich</i> —When and how will you ship parts |
| <i>Sulmost</i> —Ship to me (us) by parcel post. | called for in my (our) telegram of |
| | <i>Sulteen</i> —When and how will you ship parts |
| | called for in my (our) letter of |

INDEX

	Page No.
Accelerator.....	23
Accessories.....	38
Axle—front.....	5
Axle—rear.....	7-9
Battery Suspension.....	13
Body Parts.....	41
Bonnet.....	37
Brakes—front.....	5
Brakes—rear.....	9
Bumpers.....	13
Carburetor.....	21
Clutch.....	23
Controls.....	26-31
Brake Control.....	27
Carburetor Gas Control.....	21
Hand Control Levers (Gear Shift and Hand Brake).....	26
Pedal Control (Clutch and Brake).....	29
Drag Link.....	35
Fenders.....	36
Fan.....	14
Floor Mats and Pads.....	40
Frame.....	11
Gasoline Tank.....	13
Horn.....	38
Instruments and Mountings.....	38
Oil Pressure Gauge.....	38
Instrument Lamp.....	38
Shutter Control.....	14
Gasoline Gauge.....	38
Ammeter.....	38
Speedometer.....	38
Lamps.....	37
Motor.....	14-21
Oil Reservoir Group.....	18
Camshaft and Crankshaft.....	18
Flywheel.....	20
Timing Sprockets and Chain.....	19
Generator Drive Shaft Group.....	20
Generator Coupling.....	20
Distributor Drive Shaft Group.....	20
Oil Pump Group.....	20-21
Cylinder.....	15
Exhaust Manifold.....	18
Piston.....	19
Connecting Rod.....	19
Valve and Tappet Group.....	19
Cylinder Head.....	18
Cylinder Side Plate.....	17
Front Cover.....	17
Motor Support Plates.....	17
Cylinder Studs, Nuts and Plugs.....	17
Muffler and Exhaust Pipe.....	21
Radiator.....	13
Rims—Demountable.....	10
Running Boards.....	36
Splash Guards.....	36
Springs—front.....	10
Springs—rear.....	11
Starting Crank.....	39
Starter Button and Wire.....	37
Steering Gear.....	33-35
Tire Carrier.....	36
Tools.....	38
Transmission.....	23
Universal Joints and Propeller Shaft.....	33
Vacuum Tank Connections and Gasoline Pipes.....	21
Wheels—front.....	9-10
Wheels—rear.....	10
Wiring.....	31
R. H. Drive Parts.....	39-40

FRONT AXLE

Illus. No.	Part No.	Description	Specifications	Per Car
1	CX 64275	FRONT AXLE ASSEMBLY		1
1	CX 63195	FRONT AXLE CENTER ASSEMBLY		1
2	GZ 18974	Taper pin	No. 4x1 1/4	2

STEERING SPINDLE

3	BX 61237	SPINDLE AND BUSHING ASSEMBLY—R. H.		1
4	BX 63238	SPINDLE AND BUSHING ASSEMBLY—L. H.		1
5	BX 64360	BACKING PLATE ASSEMBLY—R. H.		1
6	BX 64361	BACKING PLATE ASSEMBLY—L. H.		1
7	BZ 3488	Nut	7/16"-20x29/64"	8
8	BZ 70298	Bolt	7/16"-20x1 1/4"	4
8	BZ 70299	Bolt	7/16"-20x2-11/16"	4
9	BM 70439	Welch plug	59/64"	4
	BZ 70626	Welch plug	1 1/8"	2
10	BX 63190	Pivot pin		2
	BX 64271	Pivot pin		2
11	BX 63199	Pivot pin lock		2
	BZ 18108	Grease nipple pipe extension		2
12	BX 62830	Spindle dust shield		2
13	BX 70110	Bearing		2
14	BX 62735	Spindle bearing dust shield		2
15	BX 63194	Bushing—upper		2
	BX 63853	Bushing—lower		2
16	BX 63201	Shim	.010" thick	4
16	BX 63200	Shim	.005" thick	4
17	BX 70294	Nut—spindle		2
18	BX 62714	Washer—spindle nut		2
19	BX 62706	Steering arm—R. H.		1
20	BX 62707	Steering arm—L. H.		1
21	BX 70333	Bolt	5/16"-18x1 1/4"	2
	BX 122	Nut	5/16"-18x5/16"	2
22	BX 60206	Steering arm ball		2
23	BZ 72	Steering arm ball nut		2
	BZ 18108	Grease nipple pipe extension		2

FRONT WHEEL BEARINGS

	18248	BEARING ASSEMBLY—inner	Timken No. 2554-2530	2
24	18272	Cone and rollers—inner bearing	Timken No. 2554	2
25	18271	Cup—inner bearing	Timken No. 2520	2
	18249	BEARING ASSEMBLY—outer	Timken No. 2382-2320	2
26	18274	Cone and rollers—outer bearing	Timken No. 2382	2
27	18273	Cup—outer bearing	Timken No. 2320	2
28	BZ 60522	Dust washer	Felt	2
29	BZ 62713	Dust washer retainer—inner		2
30	BZ 60523	Dust washer retainer—outer		2

TIE ROD

	CX 63636	TIE ROD ASSEMBLY (Includes steering arm balls)		1
31	CX 63781	Tie rod		1
32	BX 63791	Tie rod socket complete—R. H. (Includes steering arm ball)		1
33	BX 63796	Tie rod socket complete—L. H. (Includes steering arm ball)		1
34	BX 63663	Tie rod socket clamp		2
35	BX 70560	Tie rod socket clamp bolt		2
36	BZ 62	Tie rod socket clamp bolt nut		2
37	BZ 63783	Tie rod ball dust cover assembly		2
38	BZ 63784	Tie rod ball dust cover retainer		2

FRONT BRAKES

39	BX 63994	BRAKE SHOE ASSEMBLY (2 shoes)		2
40	BX 62930	Brake shoe retracting spring		2
41	BX 64334	Camshaft and crank assembly		2
42	BX 63989	Camshaft dust shield		2
43	BX 63984	Brake crank lever—L. H.		1
	BX 63985	Brake crank lever—R. H.		1
44	BX 70361	Brake crank lever clamp bolt		2
45	BR 611	Brake crank lever clamp bolt nut		2
46	BX 64336	Cam plate and blocks assembly		2
47	BX 63986	Reinforcement plate and anchor pin assembly		2
48	BT 398	Anchor pin nut		4

When ordering give letter prefix with symbol number—Example: BX 61531.

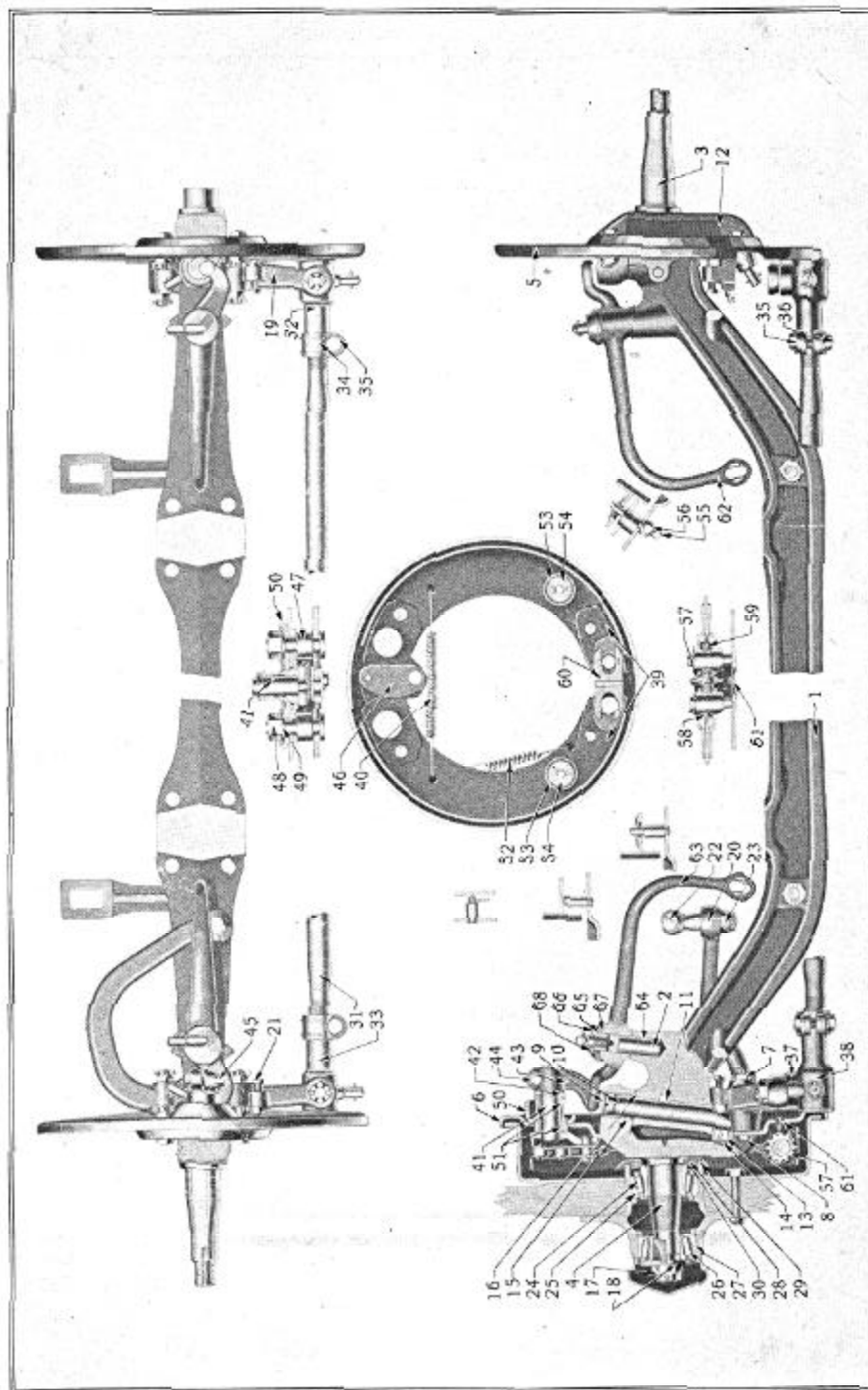

Front Axle Assembly

FRONT BRAKES—Continued

Illus. No.	Part No.	Description	Specifications	Per Car
49	BX 70532	Anchor pin shakeproof lockwasher		4
50	BX 63959	Carrier bracket assembly		2
...	BX 63905	Carrier plate and blocks assembly		2
51	BX 30871	Carrier bracket bushing		4
...	BX 63962	Backing plate assembly—R. H.		1
...	BX 63963	Backing plate assembly—L. H.		1
52	BX 63977	Brake shoe silencing spring		2
53	BX 31613	Brake shoe spacer pin and eccentric washer		4
54	BX 31912	Brake shoe spacer pin spring		4
55	BX 64309	Eccentric assembly		2
56	BZ 62	Eccentric nut		2
57	BX 63958	Adjusting screw assembly		2
58	BX 63975	Adjusting screw pivot nut—L. H.		1
59	BX 63976	Adjusting screw pivot nut—R. H.		1
60	BX 63980	Adjusting screw spring (flat)		2
61	BX 63974	Adjusting screw cover plate		2
62	BX 64272	Brake operating lever—R. H.		1
63	BX 64273	Brake operating lever—L. H.		1
64	BX 64274	Brake operating lever pivot pin		2
65	BX 62739	Brake operating lever take-up spring		2
66	BX 62740	Brake operating lever dust shield		2
67	BX 62741	Brake operating lever dust washer		2
68	BX 61492	Brake operating lever dust washer (leather)		2

REAR AXLE

...	CY 63607	REAR AXLE ASSEMBLY	5-6/10 to 1	1
-----	----------	--------------------	-------------	---

HOUSING

1	CY 64422	HOUSING ASSEMBLY		1
...	BY 62697	Brake spider—R. H.		1
2	BY 62698	Brake spider—L. H.		1
...	GY 545	Rivet—button head	5/16"x1"	12
...	BY 63609	Brake dust shield assembly—R. H.		1
3	BY 63610	Brake dust shield assembly—L. H.		1
...	BY 564	Rivet—button head	3/4"x3/8"	8
4	BY 60505	Cover—housing		1
5	BZ 1157	Cap screw—housing cover	3/8"-16x3/4" hex.	10
6	BY 2655	Gasket—housing cover		1
7	BM 322	Pipe plug—housing cover		1

DIFFERENTIAL AND CARRIER

8	CY 63189	CARRIER AND GEAR SET ASSEMBLY	5-6/10 to 1	1
9	CY 60769	CARRIER AND CAP ASSEMBLY (less gears)		1
10	BY 52160	Cap screw—bearing cap	7/16"-14x1 1/2" square	4
11	BM 13143	Stud—carrier to pinion housing	3/8"-16x1-21/32"	4
12	BM 110	Nut—carrier to pinion housing stud	3/8"-16x3/4" hex.	4
13	BY 60209	Lock—bearing adjusting nut		2
...	BY 2655	Gasket—differential carrier		1
14	BM 304	Cap screw—carrier to housing	3/8"-16x1"	10
15	BY 60495	Adjusting nut—carrier bearing		2
16	18255	Bearing—differential	Timken No. 336 & 3320	2
...	18276	Cone and rolls—differential bearing	Timken No. 336	2
...	18275	Cup—differential bearing	Timken No. 3320	2
17	BY 62605	Case—assembly—R. H. and L. H.		1
18	BY 60219	Stud—differential case	3/8"-24x3/8"-16x2 1/2"	4
19	BZ 124	Nut—case stud	3/8"-24 castle	4
20	BY 60480	Gear—differential	18 teeth	2
21	BY 9766	Pinion—differential	10 teeth	4
22	BY 60529	Spider		1
23	BY 62855	Drive gear	5-6/10 to 1	1
24	BY 62859	Drive pinion	5-6/10 to 1	1
25	BY 18167	Bolt—drive gear	3/8"-24x1-7/16" spl.	8
26	BY 18164	Nut—drive gear bolt	3/8"-24x21/64" spl.	8
27	BY 62578	Lock plate—drive gear bolt nut		4

PINION HOUSING

28	BY 62355	PINION SHAFT HOUSING ASSEMBLY (Includes bearing cups)	5-6/10 to 1	1
29	BY 60492	Shim—pinion shaft housing		As req.
29	BY 60494	Shim—pinion housing		As req.
...	18253	Bearing—pinion front	Timken No. 2691V & 2620	1

When ordering give letter prefix with symbol number—Example: BX 61531.

PINION HOUSING—Continued

Illus. No.	Part No.	Description	Specifications	Per Car
30	18280	Cone and rolls—pinion front bearing	Timken No. 2691V	1
31	18279	Cup—pinion front bearing	Timken No. 2620	1
...	70089	Bearing—pinion rear	Timken No. 3188 & 3120	1
32	70094	Cone and rolls—pinion rear bearing	Timken No. 3188	1
33	2442	Cup—pinion rear bearing	Timken No. 3120	1
34 BY	70436	Nut—pinion	3/4"-18 castle	1
35 BM	9553	Washer—pinion nut	21/32"x1 1/8" plain	1
36 BY	60501	Lock—pinion adjusting nut	1/16" thick, 2" O. D.	1
37 BY	61258	Lock nut—pinion adjusting nut	1 1/8"-20x9/32" spl.	2
38 BY	62116	ADJUSTING NUT ASSEMBLY		1
39 BY	60498	Dust washer	Felt	1
40 BY	60503	Retainer—pinion dust washer		2
41 BY	62113	Dust collar—pinion		1
42 BY	60538	Key—pinion shaft to flange		1

DRIVE SHAFT

43 CY	61246	DRIVE SHAFT ASSEMBLY		2
44 BY	60496	Thrust button		2
45 BY	51701	Felt washer		2
46 BY	51677	Retainer—inner for felt washer		2
47 BY	51678	Retainer—outer for felt washer		2
48 BM	12172	Nut—wheel to shaft	3/8"-18 castle	2
49 BZ	18257	Washer—drive shaft nut		2
50 BY	51646	Key—wheel to shaft		2

REAR WHEEL BEARINGS

51	55109	BEARING ASSEMBLY	Timken No. 415TV & 412A	2
...	52146	Cone and rolls	Timken No. 415TV	2
...	12346	Cup	Timken No. 412A	2
52 BY	62748	BEARING ADJUSTING CAP ASSEMBLY (Includes bearing cup and felt washer)		2
53 BY	60491	Felt washer—adjusting cap		2
54 BZ	394	Bolt—adjusting cap	3/8"-16x1 1/2"	8
55 BY	60497	Shim—adjusting cap	.005" thick	As req.
55 BY	60488	Shim—adjusting cap	.015" thick	As req.

REAR WHEEL BRAKES

56 BX	63994	BRAKE SHOE ASSEMBLY (set 1 wheel)		2
57 BX	62930	Brake shoe retracting spring		2
58 BX	64334	Camshaft and crank assembly		2
59 BX	30871	Camshaft bushing		4
60 BX	63989	Camshaft dust shield		2
62 BY	62947	Brake crank lever—L. H.		1
...	62948	Brake crank lever—R. H.		1
63 BX	70361	Brake crank lever clamp bolt		2
64 BR	611	Brake crank lever clamp bolt nut		2
65 BX	64336	Cam plate and blocks assembly		2
66 BX	63986	Reinforcement plate and anchor pin assembly		2
67 BX	70532	Anchor pin shakeproof lockwasher		4
68 BT	398	Anchor pin nut		4
69 BX	63959	Carrier bracket assembly		2
...	64362	Backing plate assembly—R. H.		1
...	64363	Backing plate assembly—L. H.		1
71 BX	63977	Brake shoe silencing spring		2
72 BX	31613	Brake shoe spacer pin washer		4
73 BX	31912	Brake shoe spacer pin spring		4
74 BX	64309	Eccentric assembly		2
75 BZ	62	Eccentric nut		2
76 BX	63958	Adjusting screw assembly		2
77 BX	63975	Adjusting screw pivot nut—L. H.		1
78 BX	63976	Adjusting screw pivot nut—R. H.		1
79 BX	63980	Adjusting screw spring (plate type)		2
80 BX	63974	Adjusting screw cover plate		2

FRONT WOOD WHEELS

...	CW 63568	FRONT WOOD WHEEL ASSEMBLY		2
...	BZ 63574	FRONT WOOD HUB ASSEMBLY		2
...	BZ 145	Bolt—hub	3/8"-16x2-3/16"	16
...	BZ 70147	Nut—hub bolt	3/8"-16x5/16"	16
...	CW 63582	Brake drum		2

When ordering give letter prefix with symbol number—Example: BX 61531.

FRONT WOOD WHEELS—Continued

Illus. No.	Part No.	Description	Specifications	Per Car
BZ	63580	Oil shield		2
BZ	62792	Brake inspection hole cover		2
BZ	7819	Screw	$\frac{1}{4}$ "-20x $\frac{3}{4}$ "	2
BZ	60522	Dust washer		2
BZ	60523	Outer retainer—dust washer		2
BZ	60524	Inner retainer—dust washer		2
	18248	BEARING ASSEMBLY—inner	Timken No. 2554 & 2520	2
	18272	Cone and rolls—inner bearing	Timken No. 2554	2
	18271	Cup—inner bearing	Timken No. 2520	2
	18249	BEARING ASSEMBLY—outer	Timken No. 2382 & 2320	2
	18274	Cone and rolls—outer bearing	Timken No. 2382	2
	18273	Cup—outer bearing	Timken No. 2320	2
BZ	63584	Hub cap		2
BZ	70596	Rubber ferrule	$\frac{3}{4}$ "	2

REAR WOOD WHEELS

CW	63569	REAR WOOD WHEEL ASSEMBLY		2
BZ	63576	Hub—rear wheel		2
BZ	145	Bolt—hub	$\frac{5}{8}$ "-16x2-3/16"	16
BZ	70147	Nut—hub bolt		16
CW	63577	Brake drum		2
BZ	63581	Oil shield		2
BZ	62792	Brake inspection hole cover		2
BZ	70531	Screw	$\frac{1}{4}$ "-20x $\frac{3}{4}$ "	2
	55109	BEARING ASSEMBLY	Timken No. 415TV & 412A	2
	52146	Cone and rolls	Timken No. 415TV	2
	12346	Cup	Timken No. 412A	2
BZ	63584	Hub cap		2
BZ	70596	Rubber ferrule	$\frac{3}{4}$ "	2

DEMOUNTABLE RIMS

CW	63693	RIM ASSEMBLY	20" base	5
BZ	28417	Lock—rim		5
BZ	62590	Stud—rim lock		5
BZ	63604	Clamp—rim		20
BZ	63605	Bolt—rim clamp		20
BZ	30785	Nut—rim clamp bolt		20

FRONT SPRINGS (All Models)

CZ	63350	FRONT SPRING ASSEMBLY	8 leaves, 1-21/32" thick	2
CZ	63454	Leaf No. 1 (Includes bushings)	16 1/2" ctr. to frt.; 19 1/2" rear to ctr.	2
CZ	63455	Leaf No. 2	16 1/4" ctr. to frt.; 19 1/4" rear to ctr.	2
CZ	63456	Leaf No. 3 (Includes clips)	14" ctr. to frt.; 16 1/2" rear to ctr.	2
CZ	63457	Leaf No. 4	12" ctr. to frt.; 12" rear to ctr.	2
CZ	63458	Leaf No. 5 (Includes frt. clip)	10" ctr. to frt.; 11 1/2" rear to ctr.	2
CZ	63459	Leaf No. 6	7 3/4" ctr. to frt.; 9 1/4" rear to ctr.	2
CZ	63460	Leaf No. 7	5 3/4" ctr. to frt.; 6 3/4" rear to ctr.	2
CZ	63461	Leaf No. 8	3 3/4" ctr. to frt.; 4 3/4" rear to ctr.	2
BZ	63465	Leaf clip—small		4
BZ	63444	Leaf clip—medium		4
BZ	63466	Leaf clip—large		4
BZ	63464	Center bolt	$\frac{3}{8}$ "-16x2 1/2"	2
BM	110	Nut—center bolt	$\frac{3}{8}$ "-16x	2
BZ	11175	Bushing—front end	$\frac{3}{8}$ "x $\frac{1}{2}$ "x1-15/16" plain	2
BZ	11176	Bushing—rear end	$\frac{3}{8}$ "x $\frac{1}{2}$ "x1-15/16" drilled	2
BZ	60462	Bolt—front	$\frac{3}{8}$ "-18x3-21/32"	2
BM	12172	Nut—front bolt	$\frac{3}{8}$ "-18 castle	2
BZ	60444	Sleeve—front bolt		2
BZ	60461	Shackle bolt	$\frac{3}{8}$ "-18x3 1/2" special	3
BZ	63515	Shackle bolt—thin head	$\frac{3}{8}$ "-18x3 1/2"	1
BY	18093	Nut—shackle bolt	$\frac{3}{8}$ "-18x3 1/2" special	4

When ordering give letter prefix with symbol number—Example: BX 61531.

FRONT SPRINGS (All Models)—Continued

Illus. No.	Part No.	Description	Specifications	Per Cat
...	BZ 60459	Shackle—plain.....		2
...	BZ 60460	Shackle—tapped.....		2
...	BZ 63414	Clip.....	"U" bolt.....	2
...	BY 3433	Nut—clip.....	$\frac{1}{2}$ "-20x7/16".....	8
...	BZ 62049	Rubber bumper.....		2
...	BZ 60718	Strap—bumper.....		2

REAR SPRINGS (All Models)

...	CZ 64311	REAR SPRING ASSEMBLY.....	53 $\frac{1}{8}$ " Ctr. to Ctr.....	2
...	CZ 64342	Spring leaf No. 1.....	53 $\frac{1}{8}$ " Ctr. to Ctr.....	2
...	CZ 64343	Spring leaf No. 2.....	53 $\frac{1}{8}$ " long.....	2
...	CZ 64344	Spring leaf No. 3.....	49" long.....	2
...	CZ 64345	Spring leaf No. 4.....	44 $\frac{1}{2}$ " long.....	2
...	CZ 64346	Spring leaf No. 5.....	40" long.....	2
...	CZ 64347	Spring leaf No. 6.....	35 $\frac{1}{2}$ " long.....	2
...	CZ 64348	Spring leaf No. 7.....	31" long.....	2
...	CZ 64349	Spring leaf No. 8.....	26 $\frac{1}{2}$ " long.....	2
...	CZ 64350	Spring leaf No. 9.....	22" long.....	2
...	CZ 64351	Spring leaf No. 10.....	17 $\frac{1}{2}$ " long.....	4
...	CZ 64352	Spring leaf No. 11.....	13 $\frac{1}{2}$ " long.....	4
...	CZ 64353	Spring leaf No. 12.....	8 $\frac{3}{4}$ " long.....	2
...	BZ 64340	Leaf clip—small.....		2
...	BZ 64341	Leaf clip—large.....		4
...	BZ 70629	Center bolt.....		2
...	BM 110	Nut—center bolt.....		2
...	BZ 11175	Bushing—spring eye.....	$\frac{3}{8}$ " x $\frac{1}{2}$ "-15/16" plain.....	4
...	BZ 60462	Bolt—spring front end.....	$\frac{3}{8}$ "-18x3-21/32" special.....	2
...	BM 12172	Nut—front spring bolt.....	$\frac{3}{8}$ "-18 castle.....	2
...	BZ 60444	Sleeve—front spring bolt.....		4
...	BZ 60461	Shackle bolt.....	$\frac{3}{8}$ "-18x3" special.....	2
...	BY 18093	Nut—shackle bolt.....	$\frac{3}{8}$ "-18x $\frac{3}{4}$ " special.....	2
...	BZ 60459	Shackle.....	Plain.....	2
...	BZ 60460	Shackle.....	Threaded.....	2
...	BZ 64312	Clip—rear spring.....	"U" bolt.....	2
...	BY 3433	Nut—rear spring clip.....	$\frac{1}{2}$ "-20x11/16" special.....	2
...	BZ 60466	Strap—rear spring clip.....		2
...	BZ 60467	Plate—rear spring.....		8

FRAME

...	CF 64453	FRAME ASSEMBLY (Domestic only).....		1
...	CF 64455	FRAME ASSEMBLY—L. H. D. (Export).....		1
...	CF 63676	SIDE MEMBER ASSEMBLY—R. H. (Domestic only).....		1
1	CF 63677	SIDE MEMBER ASSEMBLY—L. H. (Domestic only).....		1
...	CF 63674	SIDE MEMBER ASSEMBLY—R. H. (Export).....		1
...	CF 63675	SIDE MEMBER ASSEMBLY—L. H. (Export).....		1
...	BZ 60946	Reinforcement—side member kickup—R. H.....		1
...	BZ 60947	Reinforcement—side member kickup—L. H.....		1
...	CF 62729	Side member brace—R. H.....		1
...	CF 62730	Side member brace—L. H.....		1
3	BF 63627	Front end—R. H.....		1
4	BF 63628	Front end—L. H.....		1
5	BZ 61259	Frame rear end assembly—R. H.....		1
6	BZ 61260	Frame rear end assembly—L. H.....		1
...	BY 3197	Rivet.....	$\frac{5}{16}$ " x $\frac{3}{4}$ ".....	37
...	GZ 18241	Rivet.....	$\frac{5}{16}$ " x $2\frac{1}{8}$ ".....	2
...	GZ 18250	Rivet.....	$\frac{7}{16}$ " x $1\frac{15}{16}$ ".....	1
...	GZ 18239	Rivet.....	$\frac{5}{16}$ " x $2\frac{1}{4}$ ".....	2
...	GZ 18240	Rivet.....	$\frac{5}{16}$ " x $3\frac{1}{2}$ ".....	2
7	BZ 60443	Front motor support bracket.....		2
8	BZ 64153	Rear motor support bracket—R. H.....		1
9	BZ 64154	Rear motor support bracket—L. H.....		1
...	BM 63244	Rear motor support brace.....		1
10	BZ 60445	Body bracket—front.....		1
11	BZ 60446	Body bracket—large.....		1
12	BZ 63518	Running board channel and idler bracket assembly—R. H.....		1
...	BZ 63519	Running board channel and idler bracket assembly—L. H.....		1
13	BZ 62726	Running board channel and bracket assembly—center.....		4
14	BZ 62733	Idler lever support.....		2
15	BZ 60447	Running board bracket.....		2
...	BZ 62731	Running board channel.....		2
16	BZ 63412	Running board channel—front and rear.....		4
...	BZ 60449	Front spring rear bracket assembly.....		2

When ordering give letter prefix with symbol number—Example: BX 61531.

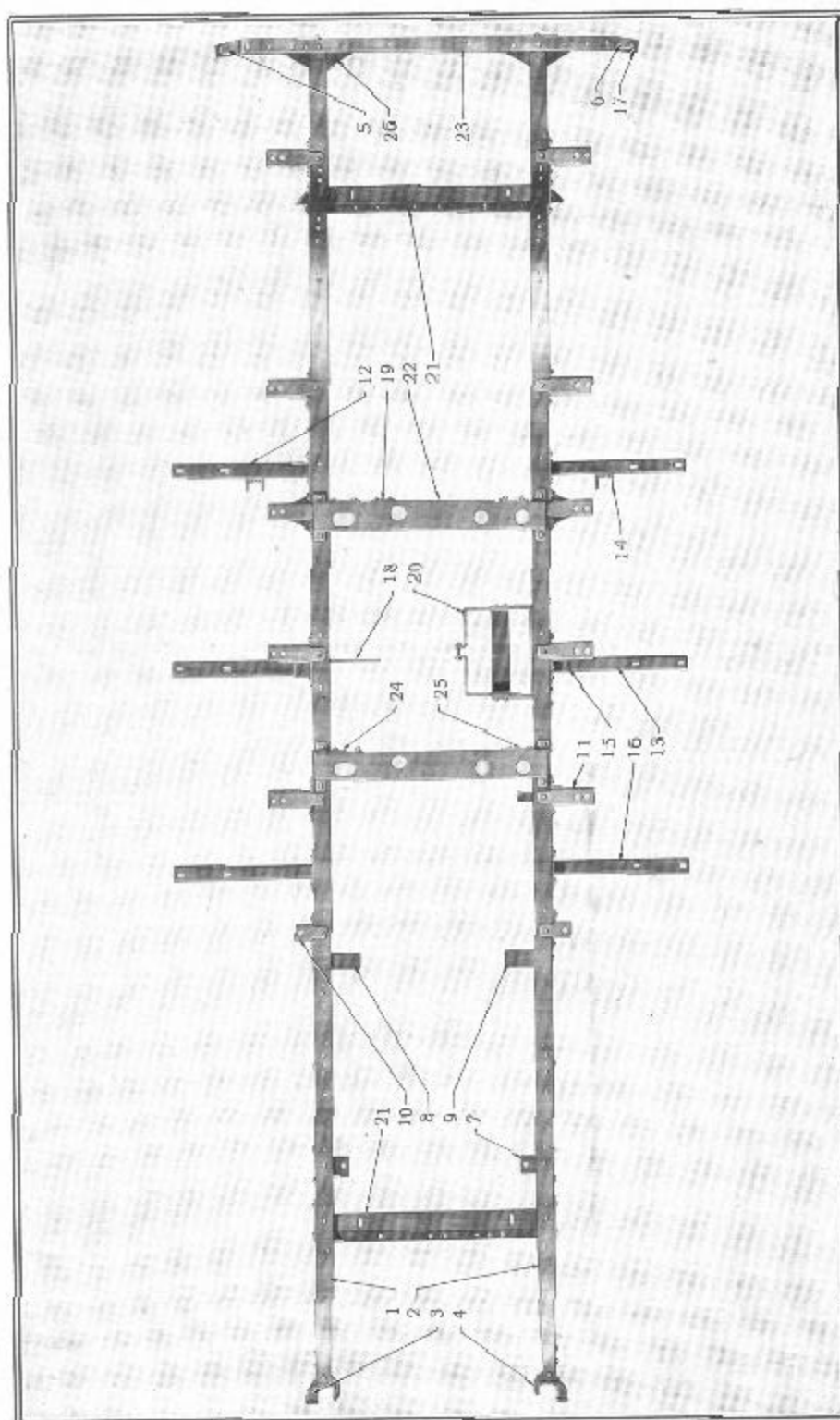

Frame Assembly

FRAME—Continued

Illus. No.	Part No.	Description	Specifications	Per Car
17	BZ 11175	Bushing—spring bracket		2
...	BZ 60457	Rear spring front bracket—R. H.		1
...	BZ 60458	Rear spring front bracket—L. H.		1
...	BZ 60451	Bracket—starting crank		1
18	BZ 63742	Muffler hanger—front		1
19	BZ 60453	Muffler hanger—rear		1
20	BZ 62118	Storage battery tray	Rubber case battery	1
...	BZ 62052	Propeller shaft safety bracket		1
...	BX 395	Bolt—safety bracket	5/16"-18x5/8"	2
...	BZ 122	Nut—safety bracket bolt	5/16"-18x5/16"	2

CROSS MEMBERS

21	CZ 63593	Front and rear middle cross member	27 1/4" long	2
22	CZ 62734	Brake cross member	27 1/2" long	2
23	CZ 62783	Rear cross member	44" long	2
...	BZ 60437	Plate—front and rear middle member		2
24	BZ 60441	Gusset—R. H. middle and brake member		2
25	BZ 60442	Gusset—L. H. middle and brake member		2
26	BZ 60439	Gusset—rear member		2

BUMPERS

...	CZ 81685	FRONT BUMPER ASSEMBLY		1
...	GY 12182	Bolt—front bumper to frame	7/16"-14 x 1"	4
...	BZ 82487	Reinforcement		2
...	CZ 82488	Inside bar—R. H.		1
...	CZ 82489	Inside bar—L. H.		1
...	CZ 82490	Outside bar		2
...	BZ 82491	Finish plate		2
...	BZ 82531	Bolt—finish plate	3/4" x 1 1/4" carriage	2
...	BZ 70572	Nut—finish plate bolt		2
...	BZ 82492	Bolt—outside and inside bar—end		2
...	BZ 70481	Nut—outside and inside bar—bolt		2

GASOLINE TANK

...	CZ 64332	GAS TANK ASSEMBLY	11 1/2" gal. cap.	1
...	BZ 64496	Filler cap	2 1/4"-16 thread	1
...	BZ 30740	Gasket—filler cap	1 1/2" I. D. x 2 3/16" O. D.	1
...	BZ 2346	Drain plug	3/8" extension head	1
...	BZ 66333	Filler neck		1
...	BZ 63701	Gasoline gauge—tank unit assembly		1
...	BZ 12488	Screw—gauge to tank		5
...	BZ 70434	Screw—gasoline gauge	No. 8—32x1 1/4" brass	1
...	BZ 31310	Gasket—gauge tank unit		1
...	BZ 63734	Gasoline suction and vent tube assembly		1
...	BZ 5652	Screw—unit to tank	No. 10—24x3/8"	2
...	BZ 31353	Gasket—suction and vent tube unit		1

GASOLINE TANK STRAP

...	BZ 61460	GASOLINE TANK STRAP ASSEMBLY		2
...	BM 219	Bolt	5/16"-18x1 1/4"	2
...	GZ 18263	Bolt	5/16"-18x1 1/4"	4
...	BZ 122	Nut	5/16"-18x5/16"	6

RADIATOR

...	A 64384	RADIATOR COMPLETE		1
-----	---------	-------------------	--	---

SHELL AND SHUTTERS

...	A 83207	SHELL AND SHUTTERS ASSEMBLY		1
...	A 83206	Radiator shell assembly—less shutters		1
...	BZ 18218	Screw—shell to core	1/4"-20x3/8"	8
...	BM 272	Nut—shell to core screw	1/4"-20x3/8" hex.	8
...	BZ 83211	Name plate		1
...	BZ 28945	SHUTTER BLADE ASSEMBLY (specify color)		17
...	BZ 26808	Shutter rail assembly		2
...	BZ 83208	Shutter operating rail assembly		1
...	BZ 28895	Shutter bell crank		1
...	BZ 28896	Shutter bell crank bracket		1
...	BZ 81271	Starting crank hole cover		1

When ordering give letter prefix with symbol number—Example: BX 61531.

CORE

Illus. No.	Part No.	Description	Specifications	Per Car
...	CZ 64156	CORE, TANK AND SUPPORT ASSEMBLY		1
...	BZ 64157	Core anchorage and reinforcement strap		1
...	BZ 64323	Shim		4
...	BZ 70435	Bolt and nut	$\frac{1}{2}$ "-16x3 $\frac{3}{4}$ " carriage	2
...	BZ 60548	Shim	$\frac{1}{4}$ "x2 $\frac{1}{2}$ "x9 $\frac{1}{2}$ " pipe	1
...	BM 18118	Drain cock		1
...	BZ 64249	Filler neck		1
...	BZ 83212	Filler cap		1
...	BZ 62353	Gasket—filler cap		1
...	CZ 62211	Tie rod—radiator to cowl		1
...	BZ 62	Nut—tie rod	$\frac{1}{2}$ "-24x21/64	1
...	BZ 63606	Upper hose		1
...	BZ 62841	Lower hose		1
...	BZ 70328	Clamp—hose	2 $\frac{1}{2}$ "	4

SHUTTER CONTROL

...	BZ 79281	SHUTTER CONTROL BRACKET ASSEMBLY		1
...	BZ 76429	Knob—shutter control		1
...	BZ 29111	Ratchet		1
...	BZ 79272	Ratchet spring		1
...	BO 18464	Screw—bracket to instrument board	$\frac{1}{4}$ "-20x7/16" spec. hd.	2
...	GO 12120	Nut—bracket to instrument board screw	$\frac{1}{4}$ "-20x $\frac{1}{2}$ " sq.	2
...	BZ 84542	Operating rod		1
...	BZ 12481	Nut—operating rod		1
...	BZ 5774	Adjustable yoke end		1
...	BZ 8682	Clevis pin	$\frac{1}{4}$ "x $\frac{1}{2}$ "	1
...	BZ 18292	Bolt	$\frac{1}{4}$ "-20x1 $\frac{1}{2}$ "	1
...	BO 12120	Nut	$\frac{1}{4}$ "-20x $\frac{1}{2}$ "	1

FAN

...	BM 62670	FAN ASSEMBLY		1
...	BM 62671	Hub		1
...	BM 62672	Gasket—hub		1
...	BM 62666	Blade—inner		2
...	BM 62667	Blade—outer		1
...	BF 395	Bolt—blade to hub		4
...	BM 63302	Spindle		1
...	BM 30849	Fan spindle washer—fibre		1
...	BM 62673	Spring—spindle		1
...	BM 306	Ball—spindle		1
...	BM 30177	Ball retainer		1
...	BM 26538	Shim—spindle		1
...	BM 120	Pipe plug	$\frac{1}{8}$ " extension hd.	1
...	BY 18093	Nut—spindle		1
...	BM 30849	Washer—fan spindle	Fibre	1
...	BM 60082	Supporting arm		1
...	BM 60156	Lock—supporting arm		1
...	BM 62549	Belt		1
...	BM 63546	Fan pulley—on crankshaft		1

MOTOR

...	CM 63500	MOTOR ASSEMBLY		1
-----	----------	----------------	--	---

CYLINDER GROUP

...	CM 63505	CYLINDER AND PISTON ASSEMBLY		1
...	CM 63501	CYLINDER ASSEMBLY		1
...	BM 61916	Oil deflecting shield—camshaft		2
...	BM 9182	Screw—camshaft shield		4
...	BM 61970	Oil deflecting shield—cylinder		2
...	CZ 61978	Camshaft bearing dowel hole seal		3
...	BM 61600	OIL FILLER COMPLETE		1
...	BM 70382	Gasket—heat indicator plug		1
1	BM 61595	Cover—oil filler		1
2	BM 12498	Screw—oil filler	$\frac{1}{4}$ "-20x7/16"	1
3	BM 60081	Tube—oil filler		1
4	BM 61359	Oil level gauge		1
5	BM 63532	WATER INLET ELBOW		1
6	BM 60049	Gasket—water inlet elbow		1
...	BM 63550	Gasket—carburetor to manifold		1
...	BM 63004	Plug—heat indicator		1

When ordering give letter prefix with symbol number—Example: BX 61531.

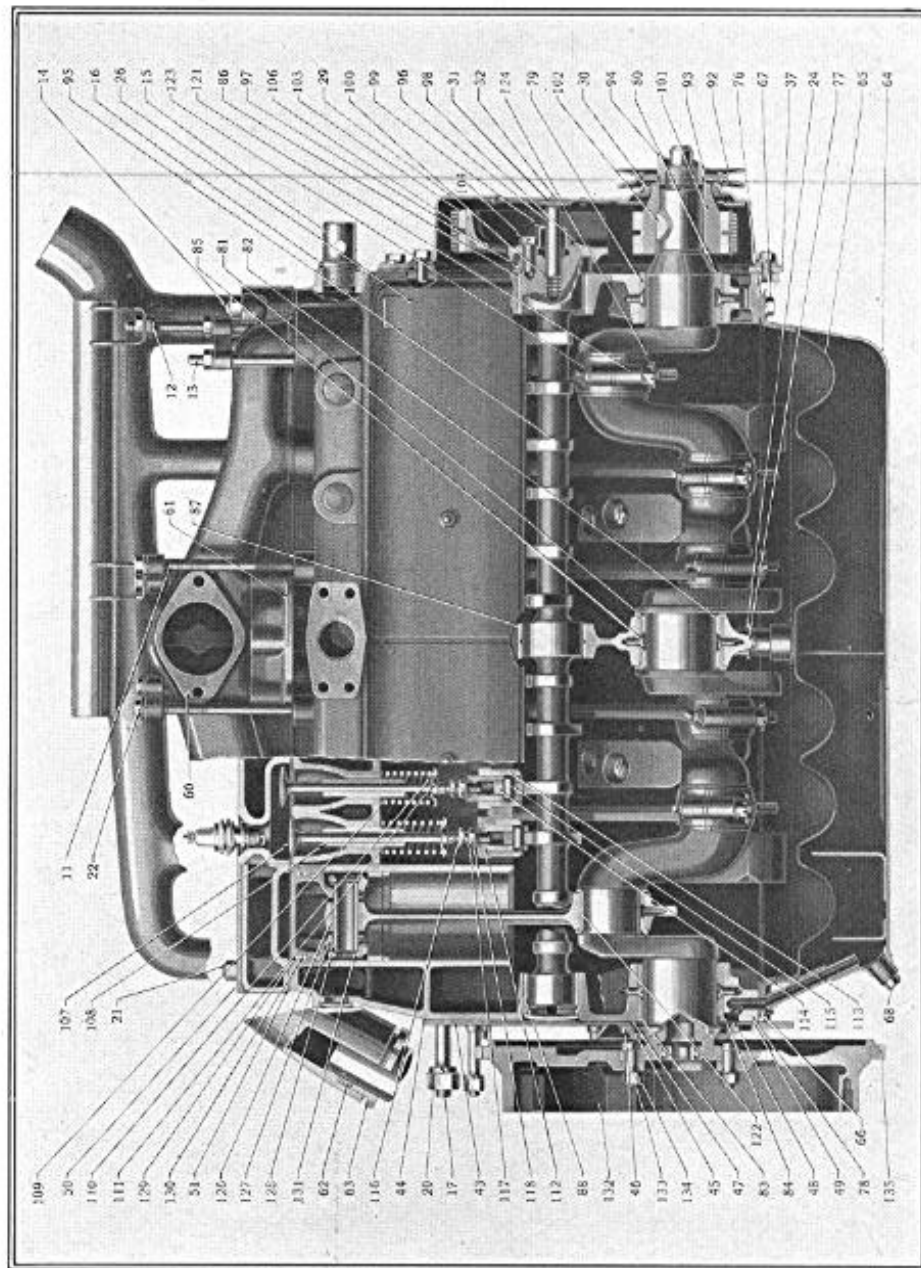

Motor—Side View

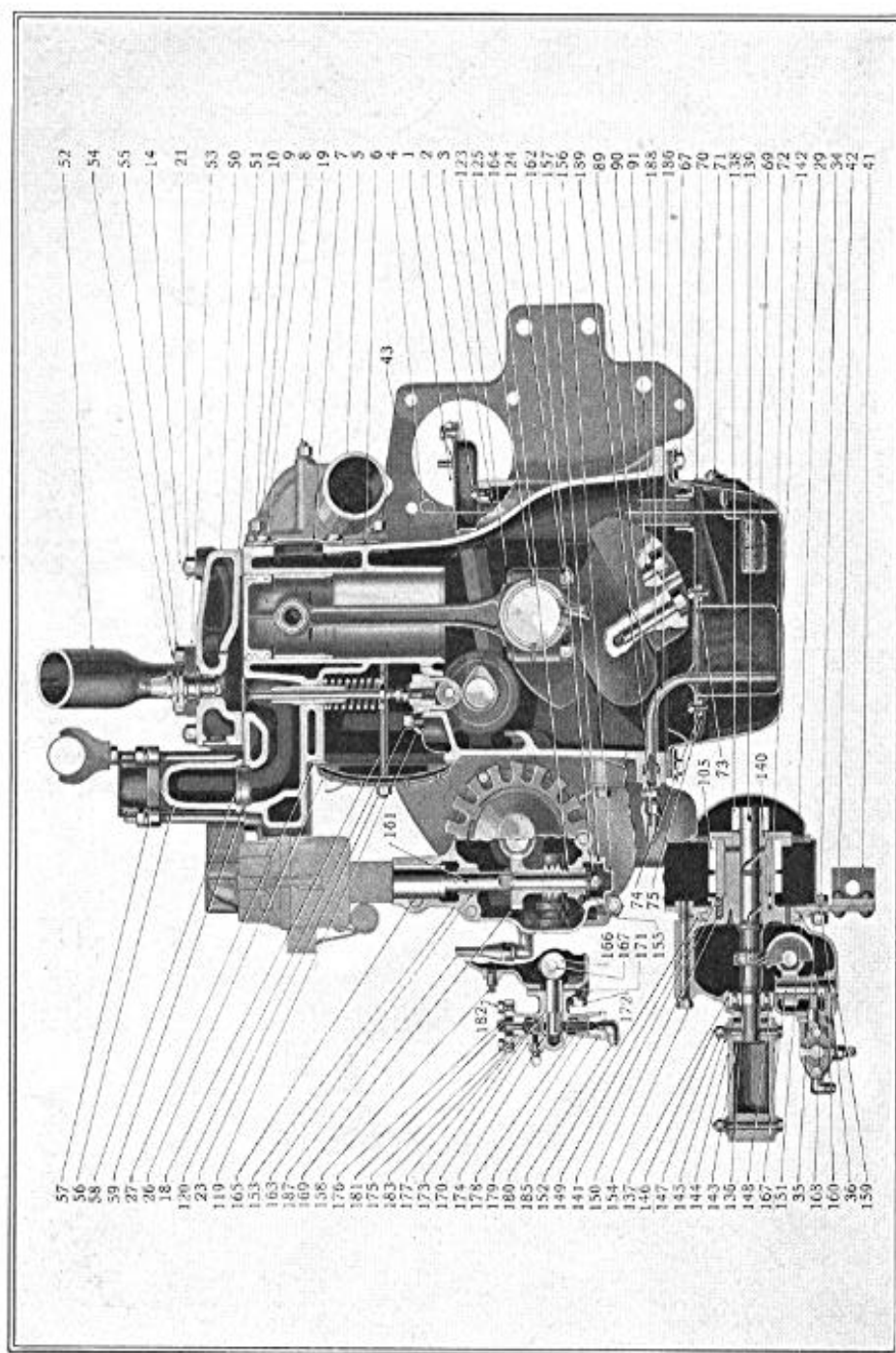

Motor—End View

CYLINDER GROUP—Continued

Illus. No.	Part No.	Description	Specifications	Per Car
7	BM 63541	WATER CIRCULATION INSPECTION PLATE		2
8	BM 63542	GASKET—WATER CIRCULATION INSPECTION PLATES		2
9	BM 219	Bolt	5/16"-18x3/4" U. S. S.	16
10	BO 70177	Washer	.317x3/4x1/32" sheet brass	16
...	BM 63543	COIL BRACKET		1

CYLINDER STUDS, NUTS AND PLUGS

...	BM 60041	Stud—center and rear bearing	1/2"-13 and 1/2"-20x3 1/4"	4
...	BM 60042	Stud—front bearing	1/2"-13 and 1/2"-20x4 1/4"	2
11	BM 63553	Stud—exhaust manifold—long		2
12	BM 63554	Stud—exhaust manifold—medium		3
13	BM 63555	Stud—exhaust manifold—short		3
...	BM 61549	Stud—exhaust manifold	5/16"-18x4 1/4"	1
14	BM 60076	Stud—cylinder head—short	3/4"-16x2 3/8"	17
14	BM 63544	Stud—cylinder head—medium		2
14	BM 61222	Stud—cylinder head—long		2
15	BM 60078	Stud—fan lever	1"-14 thread	1
16	BM 18243	Gasket—fan lever stud		1
17	BM 4946	Stud—cylinder to transmission	1/2"-13x3"	2
18	BM 60147	Stud—cylinder side plate	1/2"-20x5 1/2"	2
19	BM 13073	Stud—water inlet elbow	5/16"-18x1 1/4"	4
19	BM 63556	Stud—water manifold—long		1
...	BM 61685	Dowel—cylinder to transmission		2
20	BM 108	Nut—cylinder to transmission stud	1/2"-13x1 1/2" hex.	2
21	BM 110	Nut—cylinder head stud	3/4"-16x3/4"	21
22	BZ 122	Nut—exhaust manifold stud	5/16"-18x5/16"	21
23	BM 272	Nut—side plate stud	1/2"-20x1 1/2" hex.	2
24	BM 18382	Nut—bearing stud	1/2"-20x3/4" special	6
...	BM 13193	Welch plug	1 3/4"	1
...	BM 14112	Welch plug	1"	8

CYLINDER SIDE PLATE

26	BM 61368	SIDE PLATE COMPLETE		1
...	BM 61627	Baffle		2
...	BM 60134	Leather		1
...	BM 60133	Stiffener		2
27	BM 61615	Gasket		1
...	BM 272	Nut—side plate stud	1/2"-20x1 1/2" hex.	2

FRONT COVER

29	BM 62558	FRONT COVER ASSEMBLY		1
30	BM 60028	Felt washer		1
31	BM 23625	Thrust plate—camshaft		1
32	BM 4971	Rivet—thrust plate		2
...	BM 219	Bolt	5/16"-18x3/4"	13
34	BT 395	Bolt	5/16"-18x3/4"	2
35	BZ 122	Nut	5/16"-18x5/16"	6
36	BM 62552	Gasket—cover		1

FRONT SUPPORT PLATE

37	BM 63506	FRONT SUPPORT PLATE COMPLETE		1
...	BM 62076	Oil deflector—front plate		1
...	BM 62079	Gasket—oil deflector		1
...	BM 63563	Bracket pad	Rubber	1
...	BZ 1157	Bolt—front plate to cylinder	3/8"-16x3/4"	2
41	BM 63557	Bracket—front motor plate—R. H.		8
...	BM 63558	Bracket—front motor plate—L. H.		1
42	GY 84	Rivet—bracket to plate		2
...	BM 17976	Flared tube union	1/2" pipe x 3/4"-20	7
...	BM 70449	Bolt—support bracket to frame	1/2"-20x15/16"	1
...	BZ 72	Nut—bracket to frame bolt	1/2"-20 castle	1
...	BM 62554	Gasket—plate to cylinder		2
...	BM 60143	Oil guide—on front plate		1

REAR SUPPORT PLATE

43	BM 63241	REAR SUPPORT PLATE		1
...	BM 63244	REAR MOTOR SUPPORT BRACE		1
44	BM 61631	Gasket—plate to cylinder		1
...	BO 70449	Bolt—plate to support	1/2"-20x1 1/4"	2
...	BZ 72	Nut—plate to support bolt	1/2"-20 castle	4
...	BZ 1157	Bolt—plate to cylinder	3/8"-16x3/4"	5
...	BM 61658	Stud—starting motor	3/8"-16x3 1/8"	3

When ordering give letter prefix with symbol number—Example: BX 61531.

REAR SUPPORT PLATE—Continued

Illus. No.	Part No.	Description	Specifications	Per Car
...	BM 110	Nut—starting motor stud.....	$\frac{3}{8}$ "-16x $\frac{1}{2}$ "	6
45	BM 64450	Upper oil plate assembly—crankshaft.....		1
46	BM 70484	Screw—upper oil plate.....	$\frac{1}{4}$ "-20x $\frac{7}{16}$ "	7
47	BM 63591	Gasket—upper oil plate.....		1
48	BM 64451	Lower oil plate—crankshaft.....		1
49	BM 63592	Lower oil plate gasket—crankshaft.....		1
...	BM 63244	Rear motor brace.....		1

CYLINDER HEAD

50	CM 63504	CYLINDER HEAD ASSEMBLY.....		1
51	BM 63527	Gasket.....		1
...	BM 9751	Welch plug.....	$\frac{3}{8}$ "	3
...	BM 110	Nut—cylinder head stud.....	$\frac{3}{8}$ "-16x $\frac{3}{4}$ "	20

WATER OUTLET MANIFOLD

52	BM 63531	WATER OUTLET MANIFOLD.....		1
53	BM 63549	Gasket—manifold to cylinder.....		6
54	BM 13073	Stud—manifold to cylinder.....	$\frac{5}{16}$ "-18x $\frac{1}{4}$ "	12
55	BZ 122	Nut—manifold stud.....	$\frac{5}{16}$ "-18x $\frac{5}{16}$ "	12

EXHAUST MANIFOLD

56	BM 63530	EXHAUST MANIFOLD.....		1
57	BM 60046	Clamp.....		4
...	BZ 122	Nut—manifold studs.....	$\frac{5}{16}$ "-18x $\frac{5}{16}$ "	12
...	BZ 6440	Washer—manifold stud nut.....	$\frac{21}{64}$ "x $\frac{3}{8}$ "x $\frac{5}{64}$ "	12
58	BM 60043	Ring.....		6
59	BM 60047	Gasket.....		6
60	BM 63551	Gasket—exhaust manifold valve.....		1
61	BM 63552	Gasket—carburetor riser.....		1
62	BM 60075	Packing—manifold to exhaust pipe.....		3
63	BM 60065	Packing nut—manifold to exhaust pipe.....		1
...	BM 70470	Bolt—heater valve to manifold.....	$\frac{5}{16}$ "-18x1 $\frac{1}{2}$ "	3

OIL RESERVOIR

64	CM 63689	OIL RESERVOIR ASSEMBLY (less tray and gauge).....		1
65	BM 63691	Oil reservoir tray assembly (less screen).....		1
66	BM 62544	Gasket—reservoir to crankcase.....		2
67	BM 219	Bolt.....	$\frac{5}{16}$ "-18x $\frac{1}{4}$ "	24
68	BZ 2346	Drain plug.....	$\frac{3}{8}$ "	1
69	BM 63693	Oil level gauge assembly—oil pan unit.....		1
70	BO 70528	Screw—gauge to pan.....		5
71	BO 70434	Screw—gauge.....	No. 8-32x $\frac{1}{2}$ " brass	1
...	BM 62376	Baffle.....		6
...	BM 61359	Gauge—oil level.....	Bayonet type	1
72	BM 63695	Filter screen assembly.....		1
...	BM 62376	Baffle.....		6
74	BO 12126	Screw—filter screen to tray.....		2
75	BZ 12799	Nut—filter screen screw.....		2
...	BM 30900	Oil level gauge flange cover.....		1
...	BM 31263	Oil level gauge gasket.....		1

CRANKSHAFT AND CAMSHAFT BEARINGS

76	BM 62526	Cap—front bearing.....		1
77	BM 62527	Cap—middle bearing.....		1
78	BM 62528	Cap—rear bearing.....		1
...	BM 13569	Packing—front and rear caps.....		4
79	BM 63109	Front bearing—upper.....		1
80	BM 63110	Front bearing—lower.....		1
81	BM 63111	Center bearing—upper.....		1
82	BM 63112	Center bearing—lower.....		1
83	BM 63113	Rear bearing—upper.....		1
84	BM 63114	Rear bearing—lower.....		1
...	BM 63228	Front bearing shim.....	.003" thick	6
...	BM 63229	Front bearing shim.....	.004" thick	6
...	BM 63230	Front bearing shim.....	.050" thick	4
...	BM 63231	Center bearing shim.....	.003" thick	6
...	BM 63232	Center bearing shim.....	.004" thick	6
...	BM 63233	Center bearing shim.....	.050" thick	4
...	BM 63234	Rear bearing shim.....	.003" thick	6
...	BM 63235	Rear bearing shim.....	.004" thick	6
...	BM 63236	Rear bearing shim.....	.050" thick	4
85	BM 2335	Bearing retainer screw.....	$\frac{1}{4}$ " 20x $\frac{1}{2}$ "	6

When ordering give letter prefix with symbol number—Example: BX 61531.

CRANKSHAFT AND CAMSHAFT BEARINGS—Continued

Illus. No.	Part No.	Description	Specifications	Per Car
86	BM 60012	Bearing—camshaft—front		1
87	BM 60013	Bearing—camshaft—center		1
88	BM 60011	Bearing—camshaft—rear		1
...	BM 61074	Dowel—camshaft bearing		3
...	BM 61978	Seal—camshaft bearing dowel hole		3

CRANKSHAFT

89	CM 63503	CRANKSHAFT ASSEMBLY		1
90	BM 61670	Stud—weights	7/16"-20x2-9/16" spec.	8
91	BM 18404	Nut—weight stud	7/16"-20 castle	8
...	BT 18370	Clutch pilot ball bearing	N. D. 1202	1
92	BM 63546	Fan pulley		1
93	BM 63548	Washer—starting crank jaw		1
94	BM 63547	Starting crank jaw		1
...	BM 64450	Crankshaft oil plate assembly		1
...	BM 64452	Crankshaft oil plate assembly		1

CAMSHAFT

95	CM 63529	CAMSHAFT		1
96	BM 61613	Thrust button		1
97	BM 60701	Thrust washer		1
98	BM 61571	Plate		1
99	BM 61570	Guide		1
100	BM 61614	Spring		1

TIMING SPROCKETS AND CHAIN

101	BM 63545	CRANKSHAFT SPROCKET	19 teeth	1
102	BM 11799	Key—crankshaft sprocket	Woodruff No. A	1
103	BM 60019	Camshaft sprocket	38 teeth	1
104	BM 4934	Screw—camshaft sprocket	5/8"-16x1 1/4" special	3
105	BM 60120	Generator drive sprocket	16 teeth	1
106	BM 60139	Drive chain	Morse No. 28	1

VALVE AND TAPPET GROUP

107	BM 63797	VALVE		12
108	BM 61360	VALVE STEM GUIDE		12
109	BM 63773	Spring		12
110	BM 60111	Seat—valve spring		12
111	BM 60104	Retainer—spring seat	Horseshoe	12
...	BM 61640	TAPPET AND GUIDE ASSEMBLY		12
112	BM 61695	Tappet		12
113	BM 61697	Guide—tappet		12
114	BM 61696	Roller		12
115	BM 60106	Pin—roller		12
116	BM 61512	Adjusting screw		12
117	BM 60109	Nut—adjusting screw		12
118	BM 60099	Plate—adjusting screw		12
119	BM 60681	Clamp—tappet guide		6
120	BZ 908	Bolt—guide clamp		6

CONNECTING ROD

121	BM 63107	CONNECTING ROD COMPLETE—R. H. (Cylinders 1-2-4)		3
122	BM 63108	CONNECTING ROD COMPLETE—L. H. (Cylinders 3-5-6)		3
123	BM 62521	Bolt	3/4"-24x1-5/16" special	12
124	BM 50122	Nut	3/4"-24 castle	12
125	BM 62524	Shim	.003" thick	36
...	BM 62523	Shim	.005" thick	36
...	BM 62522	Shim	.050" thick	24
126	BM 60062	Bushing		6

PISTON

127	BM 63533	PISTON (See piston reference sheet for correct sizes)		6
128	BM 61516	Piston pin—furnished in standard, also .001, .002, .005, .010, .015 and .020 oversize		6
129	BM 63534	Piston ring—furnished in standard, also .005, .010, .020 and .030 oversize		6
130	BM 63535	Piston ring (oil regulating)—furnished in standard, also .005, .010, .020 and .030 oversize		12
131	BM 60063	Lock ring—piston pin		12

When ordering give letter prefix with symbol number—Example: BX 61531.

FLYWHEEL

Illus. No.	Part No.	Description	Specifications	Per Car
132	CM 62342	FLYWHEEL AND RING ASSEMBLY		1
133	BM 60023	Flywheel bolt		4
134	BY 18164	Nut—flywheel bolt	3/8"-24x21/64" hex.	4
...	BM 61446	Flywheel bolt nut lock		4
135	BM 62465	Flywheel ring		1

GENERATOR DRIVE GROUP

136	BM 60925	GENERATOR DRIVE SHAFT		1
137	GM 18317	Annular ball bearing	No. 203 annular	1
...	BZ 115	Key—drive shaft	Woodruff No. 9	1
138	BM 23628	Coupling—stationary		1
139	BM 16327	Pin—stationary coupling	3/16"x1 3/8" straight	1
140	BM 23629	Coupling—floating	Bronze	1
141	BM 57043	Thrust washer—generator sprocket		1
142	BT 10965	Pin—thrust washer	5/8"x5/16" straight	1
...	BM 60938	Sleeve		1
143	BM 60130	Coupling	1 1/4" I.D.x4" hose	1
144	BM 60127	Clamp—coupling		4
145	BM 18244	Bolt—coupling clamp	3/4"-20x2 1/2"	2
146	BM 272	Nut—clamp bolt	3/4"-20x 3/4" hex.	2
147	BM 61569	Oil deflector ring		1
148	BM 63183	GENERATOR STRAP ASSEMBLY		1
...	BM 8156	Generator strap screw—slotted head		1
...	BM 60138	Pin—generator strap	3/16"x1 3/8"	1
...	BM 63182	Generator bracket		1
...	BT 395	Bolt—generator bracket	5/16"-18x 3/8"	4

ECCENTRIC

149	BM 64160	ECCENTRIC		1
150	BM 23701	Spring	3/8" long	2
151	BM 64161	Gasket		3
152	BM 61431	Adjusting plate (not used with eccentric 64163)		1
...	BM 64162	Oil pump and distributor bolt spacer		3

OIL PUMP AND DISTRIBUTOR SUPPORT

153	BM 61269	SUPPORT ASSEMBLY—PUMP AND DISTRIBUTOR		1
154	GZ 18247	Bolt—support	5/16"-18x3 1/4"	2
...	GZ 18245	Bolt—support	5/16"-18x3 3/8"	1
...	BM 61076	Spacer		1
155	BZ 122	Nut—support bolt	5/16"-18x5/16"	1
156	RS 9956	Plug	1/2"-20x13/16" special	1
157	RS 9957	Gasket—support plug	McKimm	1
158	BM 120	Pipe plug	3/8"	1
159	BM 14112	Welch plug	1"	1
160	GZ 1240	Pin—oil pump gear shaft	5/8"x1" straight pin	1

OIL PUMP AND DISTRIBUTOR DRIVE

161	BM 60145	DISTRIBUTOR DRIVE SHAFT		1
162	BR 611	Nut—drive shaft		1
163	BM 60144	Bushing—upper		1
164	BM 60118	Bushing—lower		1
165	BM 60966	Lock stud		1
...	BM 794	Nut—lock stud		1
166	BM 62467	OIL PUMP GEAR AND ECCENTRIC ASSEMBLY		1
...		(Includes bushing)		1
167	BM 60115	Bushing—oil pump gear		1
168	BM 60124	Shaft—oil pump gear		1
169	BM 61648	Oil pump drive worm and distributor driven gear		1

OIL PUMP

...	BM 63637	OIL PUMP AND PLUNGER ASSEMBLY		1
170	BM 63638	Body		1
171	BM 60148	Gasket—pump to support		1
172	BT 395	Bolt—pump to support	5/16"-18x 3/8"	2
173	BM 63640	Main plunger		1
174	BM 63641	Main plunger spring		1
175	BM 63645	Distributor plunger and pin assembly		1
176	BM 19959	Spring—distributor plunger		2
177	BM 63642	Valve—upper and lower		2

When ordering give letter prefix with symbol number—Example: BX 61531.

OIL PUMP—Continued

Illus. No.	Part No.	Description	Specifications	Per Car
178	BM 63643	Spring—oil pump valve		2
179	BM 63644	Seat—oil pump valve		1
180	BM 70510	Gasket—oil pump valve seat		1
181	BM 63649	Cover—oil pump body		1
182	BM 63650	Gasket—oil pump body cover		1
183	BM 18195	Bolt	$\frac{1}{4}$ "-28x $\frac{1}{2}$ "	2
185	BM 11829	Inlet union elbow—center	$\frac{1}{4}$ "x $\frac{1}{2}$ "-20	1
GO 12214		Union elbow—upper and lower	$\frac{1}{4}$ "x7/16"-20	1

OIL PIPES AND FITTINGS

186	BM 60559	PIPE ASSEMBLY—filter to crankcase		1
BM 64270		PIPE ASSEMBLY—crankcase to pump		1
BM 64246		Union—crankcase to pump pipe		1
BM 11829		Elbow		1
187	BM 63354	PIPE ASSEMBLY—pump to front plate		1
BM 64501		PIPE ASSEMBLY—pump to union		1
BM 63352		PIPE ASSEMBLY—union to gauge		1
188	BM 5655	Clamp—filter to crankcase pipe		1
189	BM 13077	Union—filter to crankcase pipe	$\frac{1}{2}$ "-20x $\frac{1}{2}$ "-18	1
BM 11828		Nut—oil pipe	$\frac{5}{16}$ " flared tube	2
BM 11842		Nut—oil pipe	$\frac{1}{4}$ " flared tube	2
BO 12112		Union—pump to union pipe	$\frac{1}{4}$ " flared tube	1
BM 17976		Union—oil pump inlet	$\frac{1}{4}$ "-20	1
BM 12214		Elbow—pump to union pipe	$\frac{1}{4}$ " pipe x 7/16"-20	1
BM 11829		Elbow—crankcase to pump to front plate	$\frac{1}{4}$ " pipe x $\frac{1}{2}$ "-20	2
GO 13733		Clip—pump to gauge pipe		1
BM 63358		Oil pump to union tube covering		1

MUFFLER AND EXHAUST PIPE

A 63741		MUFFLER ASSEMBLY		1
CM 63743		Exhaust pipe		1
BM 16499		Clamp—exhaust pipe		2
BM 219		Bolt—exhaust pipe clamp	$\frac{5}{16}$ "-18x $\frac{3}{4}$ "	4
BZ 12275		Bolt—exhaust pipe clamp	$\frac{5}{16}$ "-18x1"	2
BZ 122		Nut—exhaust pipe clamp bolt	$\frac{5}{16}$ "-18x5/16" hex.	6
CZ 61373		Tail pipe		1
BZ 60729		Clamp—tail pipe		1
BZ 12275		Bolt—tail pipe clamp	$\frac{5}{16}$ "-18x1"	2
BZ 122		Nut—tail pipe clamp bolt	$\frac{5}{16}$ "-18x5/16" hex.	2

CARBURETOR

The carburetor and riser assembly and all the parts will be serviced direct by the Marvel Carburetor Co., Flint, Michigan.

BM 63550		Carburetor to manifold gasket		1
----------	--	-------------------------------	--	---

VACUUM TANK CONNECTIONS AND GASOLINE PIPES

BZ 18318		Bolt—vacuum tank to dash	$\frac{1}{4}$ "-20x $\frac{3}{4}$ "	4
BM 272		Nut—vacuum tank bolt	$\frac{1}{4}$ "-20x $\frac{3}{4}$ "	4
GO 12214		Union elbow	$\frac{1}{4}$ " pipe x 7/16"-20	1
BZ 62949		PIPE ASSEMBLY—gas tank to vacuum tank		1
BZ 63359		PIPE ASSEMBLY—vacuum tank to carburetor		1
BZ 63363		PIPE ASSEMBLY—vacuum tank suction		1
GO 13733		Clip	Single	5
GO 14054		Clip	Double	2
BZ 63351		Clip—oil tube and gas line		3
BZ 63664		Clip—gas line and choke wire		1
BO 12126		Screw—clip to frame	No. 10-32x $\frac{3}{8}$ "	3
BZ 12799		Nut—clip to frame screw	No. 10-32x $\frac{3}{8}$ "	3
BM 70591		Union nut	$\frac{1}{4}$ " flared tube	2
BM 70593		Tube sleeve—vacuum tank to carburetor		2
BM 11828		Union nut—suction tube	$\frac{5}{16}$ " flared tube	2

MOTOR CONTROL

1 BZ 81823		CHOKE WIRE AND TUBE ASSEMBLY		1
BZ 82690		Choke button and wire assembly		1
2 BO 70121		Shakeproof lockwasher		1
3 BZ 70122		Choke tube clamp nut		1

When ordering give letter prefix with symbol number—Example: BX 61531.

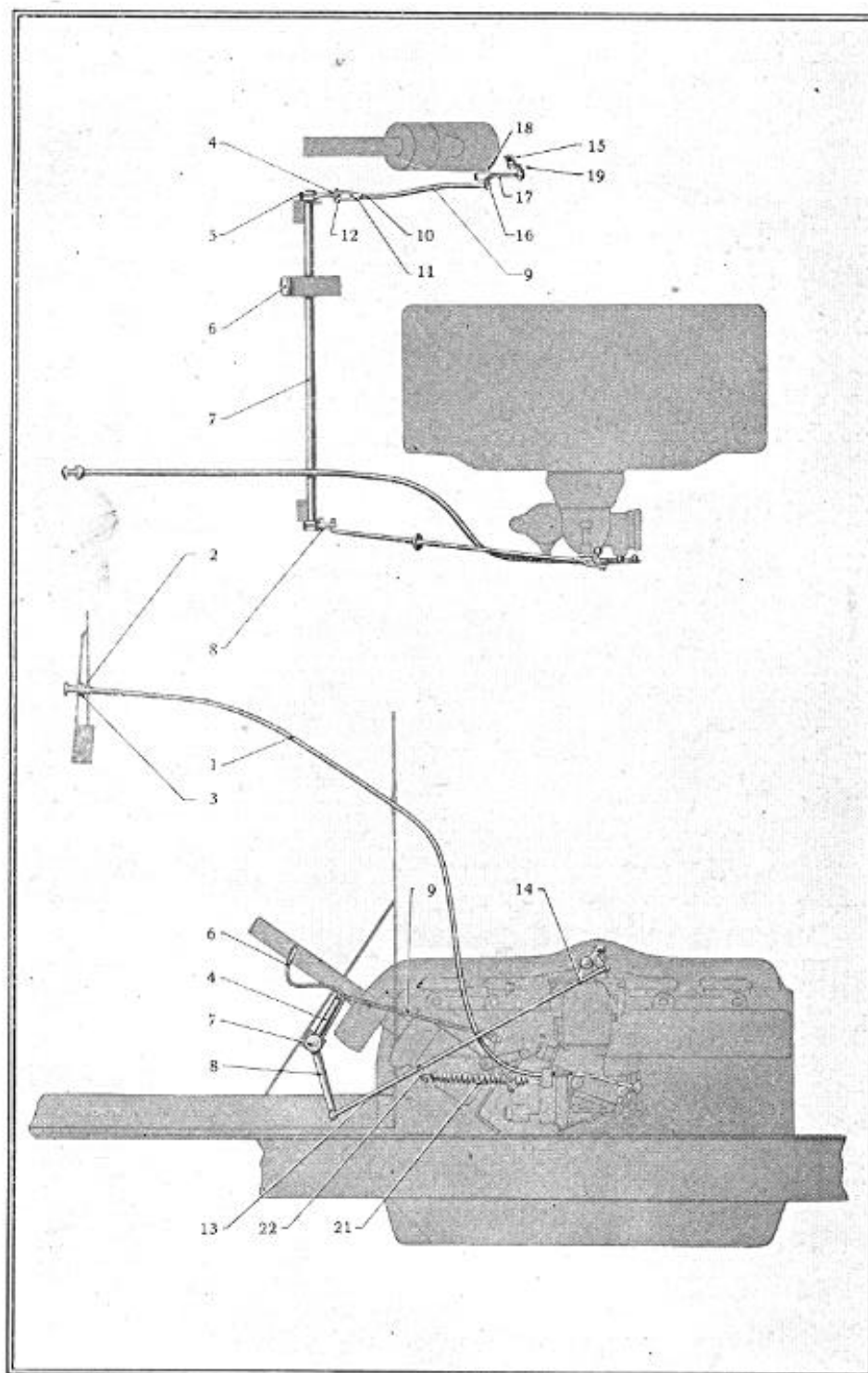

MOTOR CONTROL—Continued

Mass. No.	Part No.	Description	Specifications	Per Car
4	BZ 62808	Accelerator pedal shaft lever—steering gear end		1
5	BZ 7911	Accelerator pedal shaft lever taper pin		1
6	BZ 61517	Accelerator pedal		1
7	BZ 7911	Accelerator pedal taper pin		1
8	BZ 62807	Accelerator pedal shaft		1
9	BZ 60574	Accelerator pedal shaft lever—carburetor end		1
10	BZ 62802	Accelerator pedal shaft to steering gear rod		1
11	BZ 12799	Accelerator pedal shaft to steering gear rod nut		1
12	BO 5771	Accelerator pedal shaft to steering gear rod yoke		1
13	BZ 5825	Accelerator pedal shaft to steering gear rod clevis pin		1
14	BZ 63369	Accelerator pedal shaft to carburetor rod		1
15	BZ 18053	Accelerator pedal shaft to carburetor rod lock nut		1
16	BO 5771	Accelerator pedal shaft to carburetor rod yoke		1
17	BZ 5825	Accelerator pedal shaft to carburetor rod yoke clevis pin		1
18	BZ 62806	Throttle control rod thru pin—on steering gear		1
19	BZ 5527	Throttle control rod collar		1
20	BZ 62803	Throttle control rod bell crank		1
21	BZ 62804	Throttle control rod bell crank pivot		1
22	BZ 62805	Throttle control rod bell crank to steering gear lever link		1
23	BZ 63030	Throttle control lever—on steering gear throttle tube		1
24	BZ 60711	Throttle control retracting spring—carburetor to clip		1
25	BZ 63371	Throttle control retracting spring clip		1

CLUTCH

BR 63600	CLUTCH ASSEMBLY		
1 BR 62276	Clutch cover		
2 BR 62290	Gasket—clutch cover		
3 BZ 908	Bolt—cover to flywheel	5/16"-18x 3/4"	
4 BR 70133	Filler plug	3/8" extension	
5 BR 62277	Pressure plate		
6 BM 219	Bolt—toggle arm	5/16"-18x 3/4"	
7 BR 62463	DRIVING PLATE ASSEMBLY		
8 BR 598	Cork—driving plate		
9 BR 62280	Shifting finger		
10 BR 62281	Toggle bracket		
11 BM 18404	Nut—toggle bracket	7/16"-20x17/32" castle	
12 BR 62282	Gasket—toggle bracket	Copper	
13 BR 18224	Throwout bearing		
14 BR 63599	Retainer—throwout bearing		
15 BR 62285	Throwout cross		
16 BR 63598	Shifting sleeve		
17 BR 62288	Pin—toggle arm		
18 BR 62289	Lock plate—toggle arm		
19 BR 62510	Spring—main		
20 BZ 9773	Pipe plug	1 1/2" headless	
21 BR 63601	Washer—throwout bearing retainer		
22 BR 29523	Toggle arm screw lock plate		

TRANSMISSION

CT 62307	TRANSMISSION ASSEMBLY	5-6/10 to 1	1
CT 62311	Case		1
BT 60360	Lock screw—bearings and countershaft		3
BZ 2346	Oil level plug		1
BT 62344	Oil drain plug		1
BM 12117	Gasket—oil drain plug		1
BM 113	Bolt	3/4"-13x2 1/2"	2
BM 4946	Bolt	3/8"-13x2 1/2"	2
BM 108	Nut	3/8"-13x 1/2"	2
BM 14112	Welch plug		3
BT 62343	MAINSHAFT DRIVE GEAR ASSEMBLY		1
BT 18370	Pilot ball bearing—front		1
BM 70285	Steel ball—drive gear		1
BT 61656	Bushing—main drive gear		1
BT 62680	Oil seal—drive gear bearing		1
BT 70085	Bearing—main drive gear	N. D.-1207	1
BT 62296	BEARING CAP—front		1
BZ 12275	Bolt	5/16"-18x1"	3
BY 3205	Clevis pin	7/16"x2 3/8"	1
BT 60346	Gasket—bearing cap		1
BT 60326	Mainshaft		1
BT 60331	Second and high-speed gear		1
BT 60332	Low and reverse gear		1
BT 18226	Bearing—rear	Hyatt N. C. 306	1
BT 60366	Inner sleeve—rear bearing		1

When ordering give letter prefix with symbol number—Example: BX 61531.

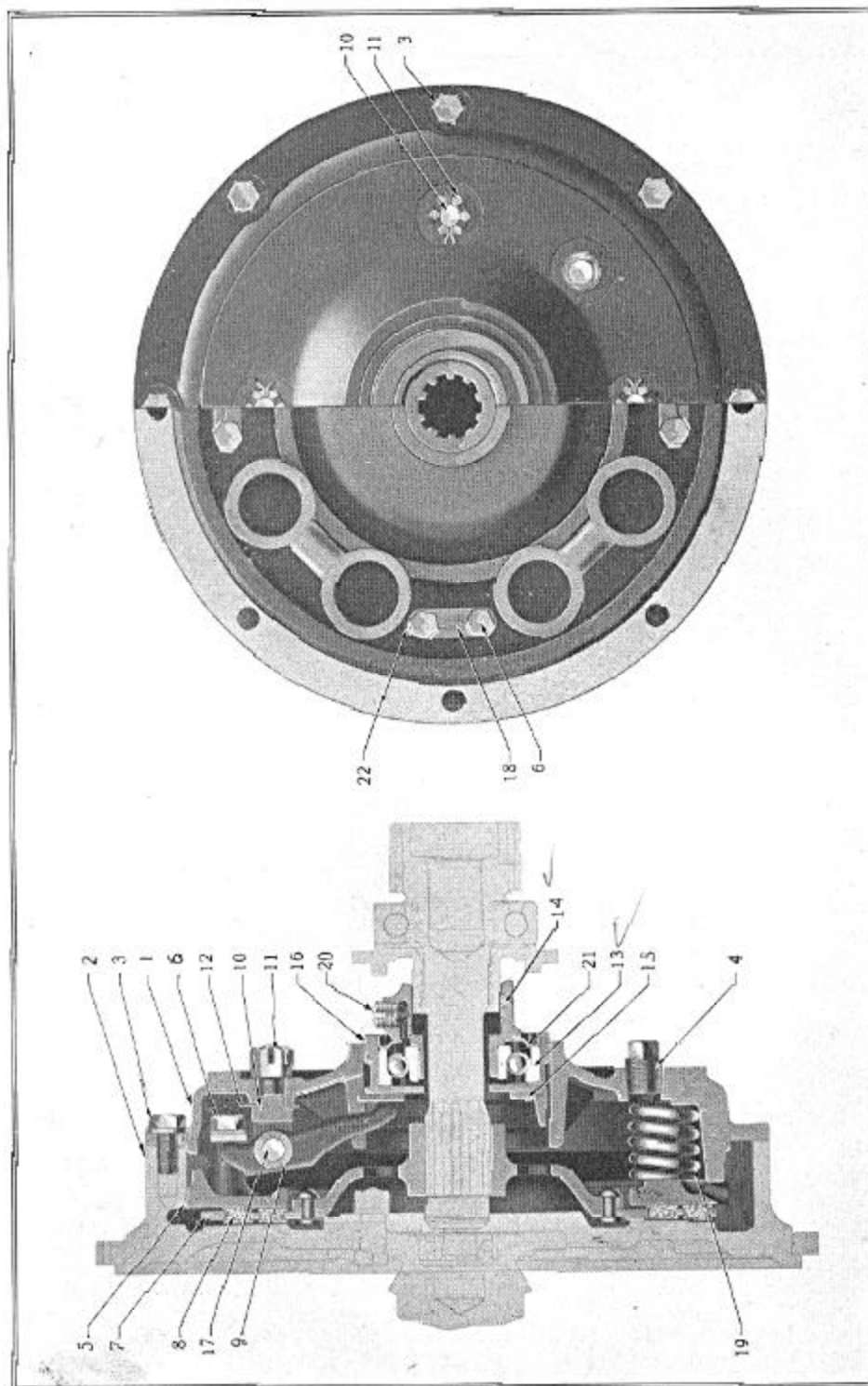

Clutch Assembly

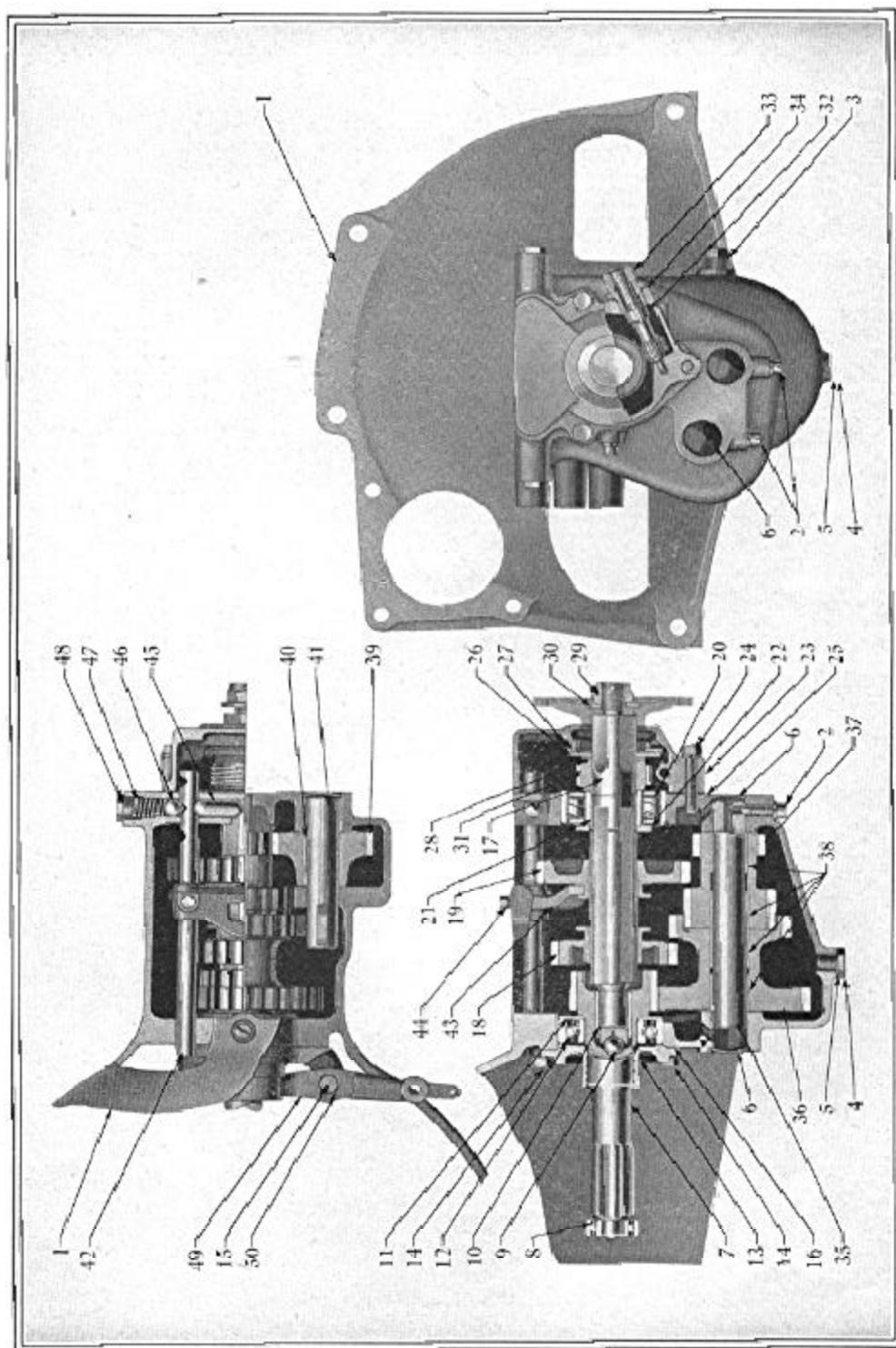

Transmission Assembly

TRANSMISSION—Continued

illus. No.	Part No.	Description	Specifications	Per Car
22	BT 62165	Retainer—bearing.....		1
23	BT 60337	Bearing cap—rear.....		1
24	GM 1374	Bolt—rear cap.....		3
25	BT 60347	Gasket—rear cap.....		1
26	BT 61483	Steel washer.....		1
27	BT 61484	Bronze washer.....		1
28	BT 10965	Dowel pin.....		1
28	BT 60352	Shim.....		2
28	BT 60353	Shim.....		2
29	BM 12172	Nut—mainshaft.....	5/8"-18x9/16"	1
30	BM 9553	Washer—mainshaft nut.....		1
31	BT 64425	SPEEDOMETER DRIVE GEAR.....	5-6/10 to 1	1
32	BT 64426	Speedometer pinion.....	5-6/10 to 1	1
33	BT 23871	Sleeve.....		1
34	BT 22753	Shim.....		3
35	BT 60327	Countershaft.....		1
36	BT 61057	DRIVE AND INTERMEDIATE GEAR ASSEMBLY.....	32 and 24 teeth	1
37	BT 61060	LOW AND REVERSE GEAR ASSEMBLY.....	18 and 14 teeth	1
38	BT 62684	Bushing.....		4
39	BT 61059	REVERSE IDLER GEAR ASSEMBLY.....	20 teeth	1
40	BT 63180	Bushing.....		1
41	BT 60328	Shaft—reverse idler gear.....		1
42	BT 60358	Shifting shaft—second and high.....		1
42	BT 60359	Shifting shaft—low and reverse.....		1
43	BT 60354	Shifting fork.....		2
44	BT 60355	Screw—shifting fork.....	5/16"-24x1-3/16" special	2
45	BT 60363	Shaft lock.....		2
46	GM 6846	Steel ball.....	7/16"	2
47	BT 60361	Spring—shifter lock plunger.....		2
48	BT 60362	Cap—plunger spring.....		2
49	BR 64494	Clutch yoke assembly.....		1
50	BR 60357	Bushing—clutch yoke.....		1

CONTROL LEVERS

HS 62690	CONTROL LEVER AND HOUSING ASSEMBLY.....	1
1 BS 60950	GEAR SHIFT LEVER ASSEMBLY.....	1
2 BS 60399	Cover—lever.....	1
3 GO 18219	Screw—cover.....	4
4 BS 60364	Spring—lever.....	1
5 BS 29170	Ball—lever.....	1
6 BS 60406	Screw—lever pivot.....	1
6 BS 62689	GEAR SHIFT LEVER HOUSING.....	1
7 BZ 908	Bolt.....	4
8 BS 60403	Cover—housing oil hole.....	1
9 BS 60425	Gasket—housing to transmission case.....	1
10 GO 18219	Screw—oil hole cover.....	2

HAND BRAKE

11 BS 63596	Hand brake lever.....	1
12 BS 62329	Extension spring.....	1
13 BS 62330	Hook—extension spring.....	1
14 BS 62331	Bushing—lever.....	1
15 BS 62332	Bracket—lever.....	1
16 BR 1308	Bolt—bracket.....	2
17 BS 62327	Nut—bracket bolt.....	2
17 BS 62328	Latch—inside.....	1
18 BZ 8683	Latch—outside.....	1
19 BM 12440	Clevis pin.....	1
20 BZ 6440	Clevis pin.....	1
21 BS 62323	Washer—pivot.....	1
22 BS 62872	Rod—latch.....	1
23 BS 6705	Ratchet.....	2
BM 110	Bolt—ratchet.....	2
BS 62325	Nut—ratchet bolt.....	2
BS 62326	Spacer—ratchet.....	2
21 BS 62333	Spacer—ratchet to frame.....	2
BS 411	Shaft—brake lever pivot.....	1
BS 753	Washer.....	1
BS 62334	Taper pin.....	1
25 BS 22861	Spring—pivot.....	1
26 BS 12123	Grip—lever latch.....	1
BS 7435	Screw—grip.....	2
	Nut—grip screw.....	2

When ordering give letter prefix with symbol number—Example: BX 61531.

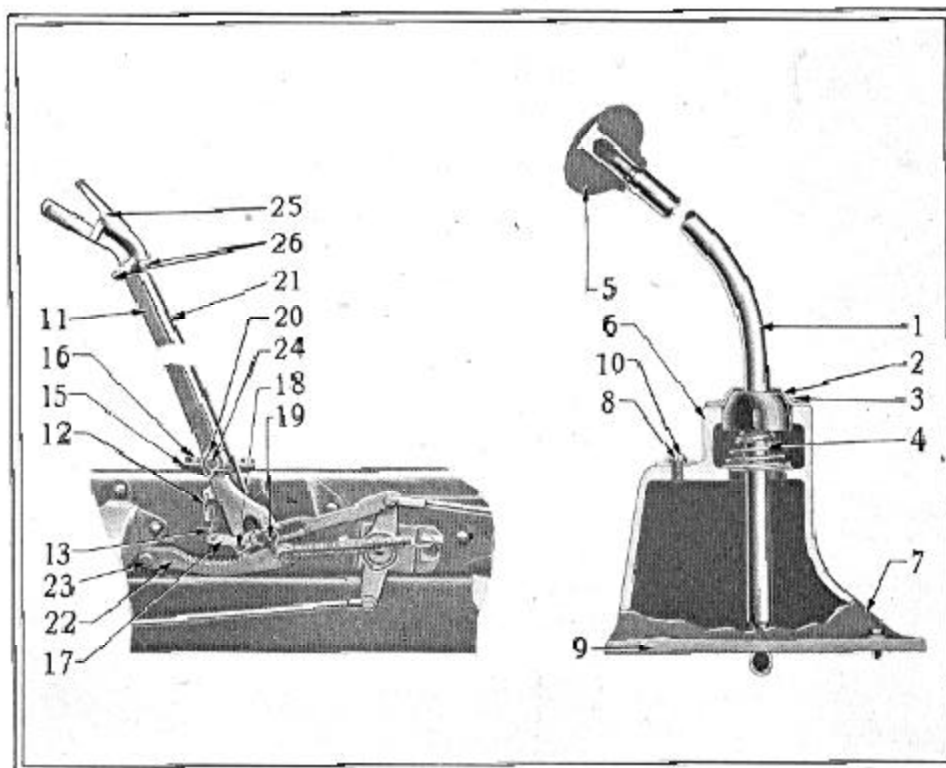

Hand Control Levers

BRAKE CONTROL RODS AND LEVERS

Illus. No.	Part No.	Description	Specifications	Per Car
1	BZ 52763	Rod—pedal to cross shaft		1
2	BZ 63856	Rod—cross shaft to front idler		2
3	BZ 63854	Rod—front idler to front control lever		2
...	BZ 6777	Yoke—pedal to cross shaft rod and front idler to front control lever rod		1
...	BR 611	Nut—pedal to cross shaft rod and front idler to front control lever rod		1
...	BZ 8693	Clevis pin—pedal to cross shaft rod		1
5	BZ 70301	Clevis pin—front idler to front control lever rod	5/16"x1-7/16"	2
6	BZ 8693	Clevis pin—cross shaft to front idler lever rod	5/16"x1-1/32"	2
7	BZ 62766	Rod—cross shaft to rear idler—L. H.		1
8	BZ 62767	Rod—cross shaft to rear idler—R. H.		1
9	BZ 63857	Rod—rear idler to rear control lever		2
...	BZ 5777	Yoke—rear idler to rear control lever rod		2
...	BR 611	Lock nut—rear idler to rear control lever rod		2
11	BZ 31855	Spring—front and rear rod		4
...	BZ 31856	Spring washer—horse shoe		4
12	BZ 29265	Front idler lever pivot		2
13	BZ 124	Front idler lever pivot nut		2
...	BZ 70119	Front idler lever pivot washer		4
14	BZ 62771	Front idler lever		2
15	BZ 62758	Brake cross shaft		1
...	BZ 2360	Key—Woodruff	Size "A"	3
16	BZ 62759	Cross shaft center lever		1
17	BZ 275	Bolt	1/8"x16x1 1/2"	1

When ordering give letter prefix with symbol number—Example: BX 61531.

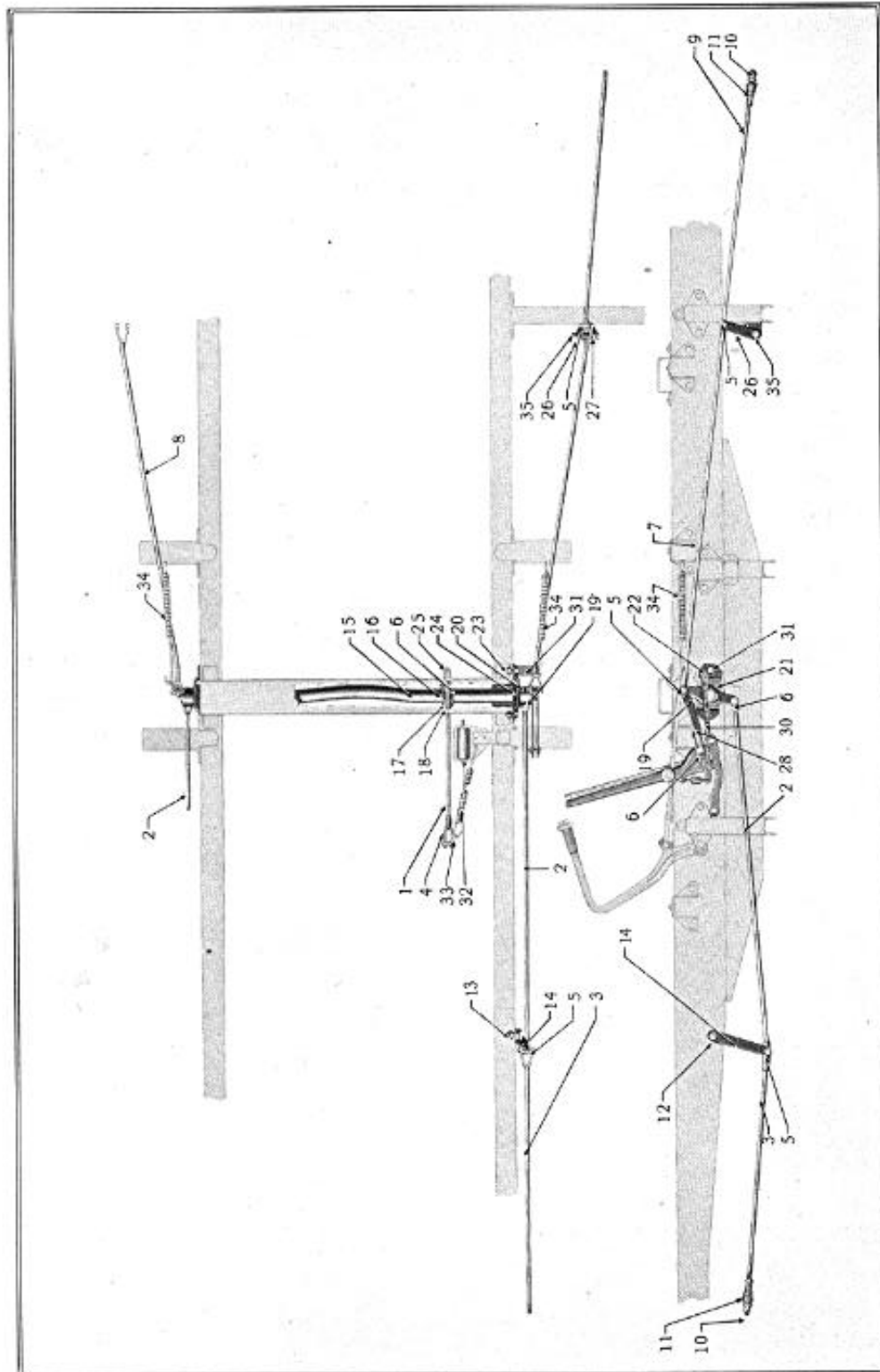

Brake Control Rods and Levers

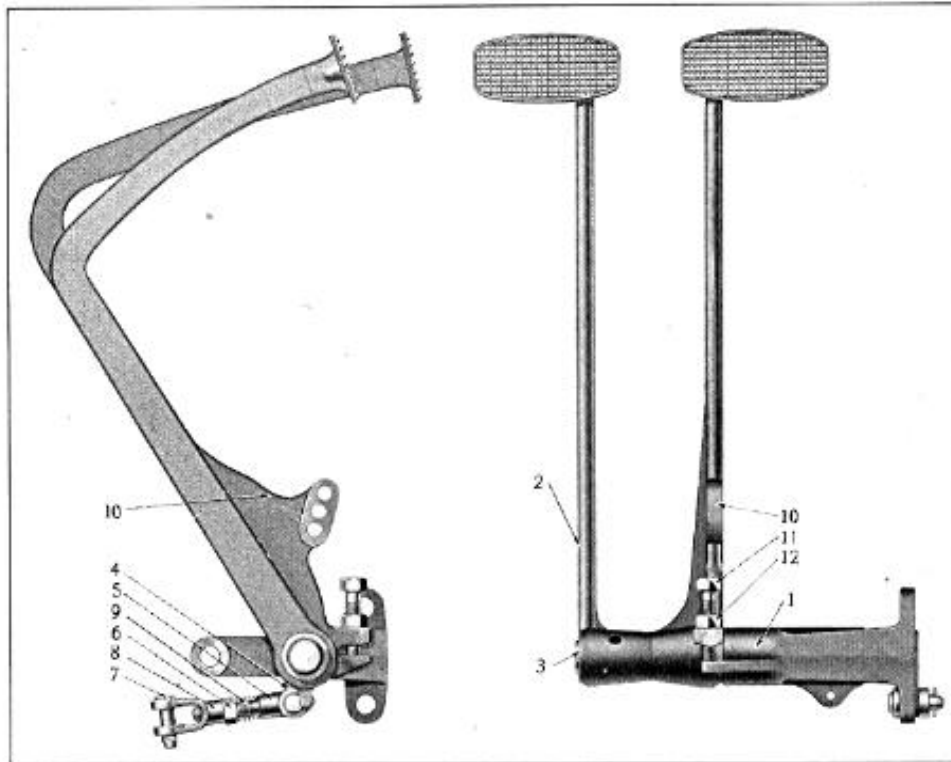

Pedal Control

BRAKE CONTROL RODS AND LEVERS—Continued

Illus. No.	Part No.	Description	Specifications	Per Car
18	BM 110	Nut.....	$\frac{3}{8}$ "-16x $\frac{1}{8}$ "	1
19	BZ 62760	Cross shaft end lever.....		2
20	BZ 711	Taper pin.....	No. 4-1 $\frac{1}{4}$ "	2
21	BZ 62761	Cross shaft bracket.....		2
22	BZ 908	Bolt.....	$\frac{5}{16}$ "-18x $\frac{1}{8}$ "	4
23	BZ 122	Nut.....	$\frac{5}{16}$ "-18x $\frac{5}{16}$ "	4
24	BZ 62762	Cross shaft felt.....		2
25	BZ 62765	Foot brake play link.....		1
26	BZ 8683	Clevis pin.....	$\frac{5}{16}$ "x1-1/32"	1
26	BZ 62768	Rear brake idler lever—outer.....		2
27	BZ 63859	Rear brake idler lever—inner.....		2
27	BZ 13506	Rear brake idler lever spring.....		2
28	BZ 62773	Link—hand brake lever to cross shaft.....		1
29	BZ 8683	Clevis pin.....	$\frac{5}{16}$ "x1-1/32"	1
30	BZ 62774	Hand brake lever return spring.....		1
31	BZ 62775	Hand brake lever return spring clip.....		1
32	BZ 62778	Brake pedal and stop light switch spring.....		1
33	BX 30868	Brake control spring clip.....		2
34	BZ 29275	Brake release spring.....		1
35	BY 32051	Clevis pin—rear idler lever—lower.....		2

PEDAL CONTROL

...	BZ 63277	PEDAL CONTROL ASSEMBLY.....		1
1	BZ 61428	BRACKET ASSEMBLY.....		1
...	BR 1308	Bolt.....	$\frac{3}{8}$ "-16x1 $\frac{1}{2}$ "	2
...	GZ 7115	Bolt.....	$\frac{3}{8}$ "-16x1 $\frac{1}{4}$ "	1
...	BZ 60380	Bushing—pedal bracket.....		1

When ordering give letter prefix with symbol number—Example: BX 61531.

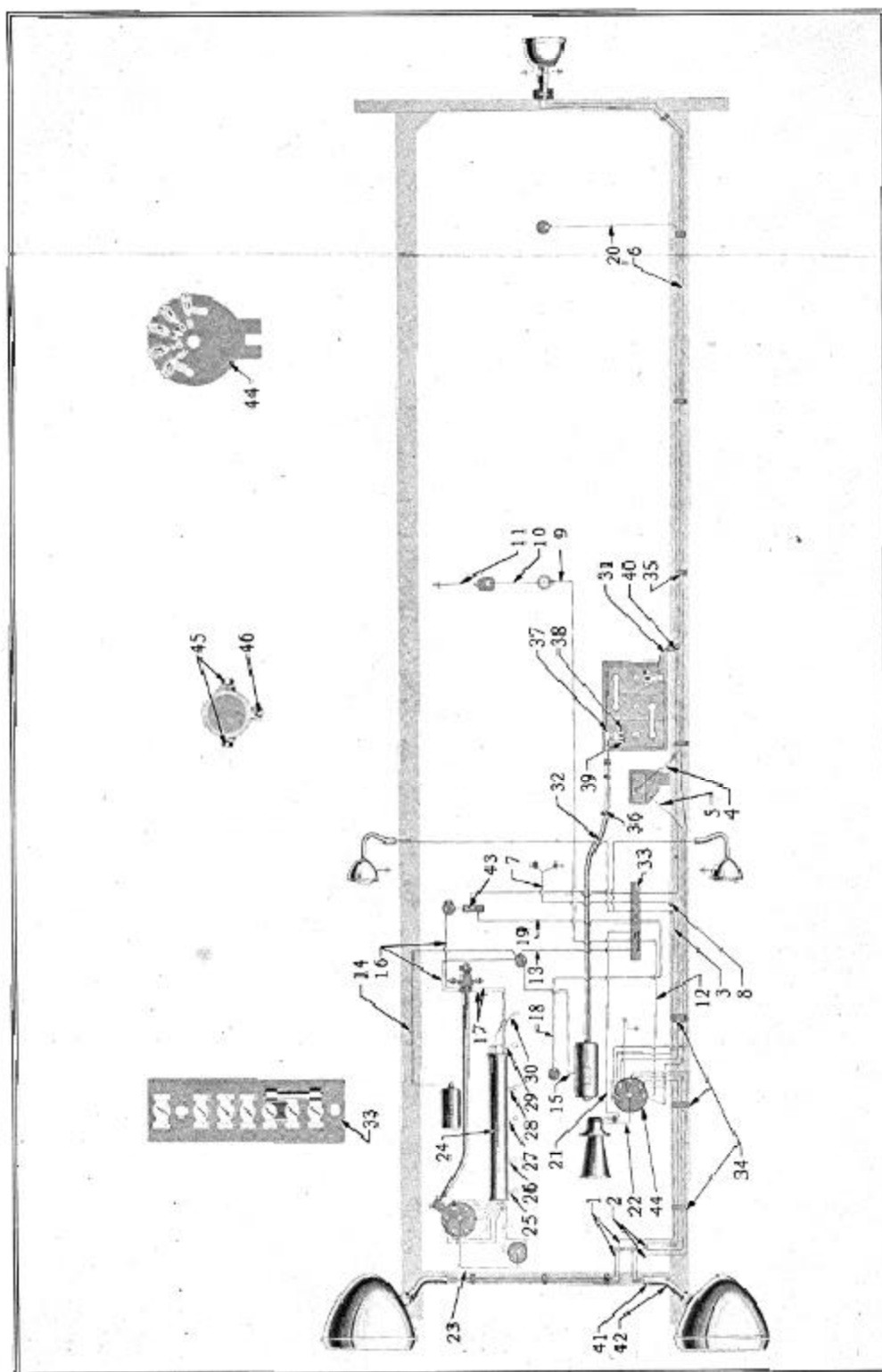

Wiring Diagram

PEDAL CONTROL—Continued

Illus. No.	Part No.	Description	Specifications	Per Car
2	BZ 64191	CLUTCH PEDAL		1
3	BZ 60390	Shaft—clutch pedal		1
4	BR 62509	Lever—clutch pedal		1
5	BZ 62299	Clutch link		1
6	BR 611	Nut—link	5/16"-24x17/64"	1
7	BZ 8683	Clevis pin	5/16"x1-1/32"	1
8	BY 60389	Adjustable link		1
9	BZ 8683	Clevis pin	5/16"x1-1/32"	1
9	BS 61475	Clutch pedal return spring		1
10	BZ 64190	BRAKE PEDAL		1
11	BZ 61708	Bushing—brake pedal hub		1
11	GM 1483	Bolt—hub	5/16"-18x1 3/8"	1
12	BZ 122	Nut—hub bolt		1

WIRING

1	BO 63005	Headlamp wire assembly—headlamp to main switch—R. H.		3
2	BO 63006	Headlamp wire assembly—headlamp to main switch—L. H.		3
4	BQ 63019	Stoplight wire assembly—stoplight to stoplight switch		1
5	BQ 63015	Stoplight wire assembly—stoplight switch to main switch		1
6	BQ 62431	Tail lamp wire assembly—tail lamp to main switch		1
7	BQ 81816	Instrument lamp wire assembly—instrument lamp to junction post		1
8	BQ 63522	Instrument lamp wire assembly—junction post to main switch		1
9	BQ 82081	Dome lamp wire assembly—dome lamp to junction block		1
10	BQ 79359	Dome lamp wire assembly—dome lamp to dome lamp switch		1
11	BQ 80037	Dome lamp wire assembly—dome lamp switch to ground		1
12	BO 63820	Feed wire assembly—main switch to junction block		1
13	BO 31424	Feed wire assembly—ammeter to junction block		1
14	BO 62508	Feed wire assembly—generator to ammeter		1
15	BO 63804	Feed wire assembly—starter post to ammeter		1
16	BO 31406	Ignition wire assembly—ammeter to electrolock		1
17	BO 63806	Ignition wire assembly—electrolock to coil		2
18	BO 64210	Coil to electrolock and electrolock to gauge wire assembly		1
18	BO 63814	Gasoline and oil gauge wire assembly—oil pan unit to junction block		1
19	BO 31414	Gasoline and oil gauge wire assembly—junction block to gauge switch		2
20	BO 63828	Gasoline and oil gauge wire assembly—gasoline tank unit to junction block		1
21	BO 63824	Horn wire assembly—horn to junction block		1
22	BO 63275	Horn wire assembly—horn to horn button		1
23	BM 63295	Coil wire assembly—coil to distributor—high tension		1
24	BM 63294	Spark plug cable tube and cable		1
24	BM 60113	Cable tube		1
24	BM 60112	Cable tube clip		2
25	EM 63288	Cable No. 1		1
26	BM 63288	Cable No. 2		1
27	BM 63290	Cable No. 3		1
28	BM 63291	Cable No. 4		1
29	BM 63292	Cable No. 5		1
30	BM 63293	Cable No. 6		1
31	BM 60112	Cable tube clip		2
31	BZ 60648	Battery ground connection		1
32	BZ 62492	Battery cable and conduit assembly—battery to starter		1
33	BZ 30307	Junction post		1
33	BO 12128	Screw—junction post to cowl		2
33	BZ 12799	Nut—junction post to cowl screw		2
33	BO 80582	Instrument lamp and socket complete—R. H. D.		1
34	GO 13733	Clip—large—headlamp wires to frame		10
35	GO 62013	Clip—cable		10
35	BQ 12126	Screw—clip to frame		20

When ordering give letter prefix with symbol number—Example: BX 61531.

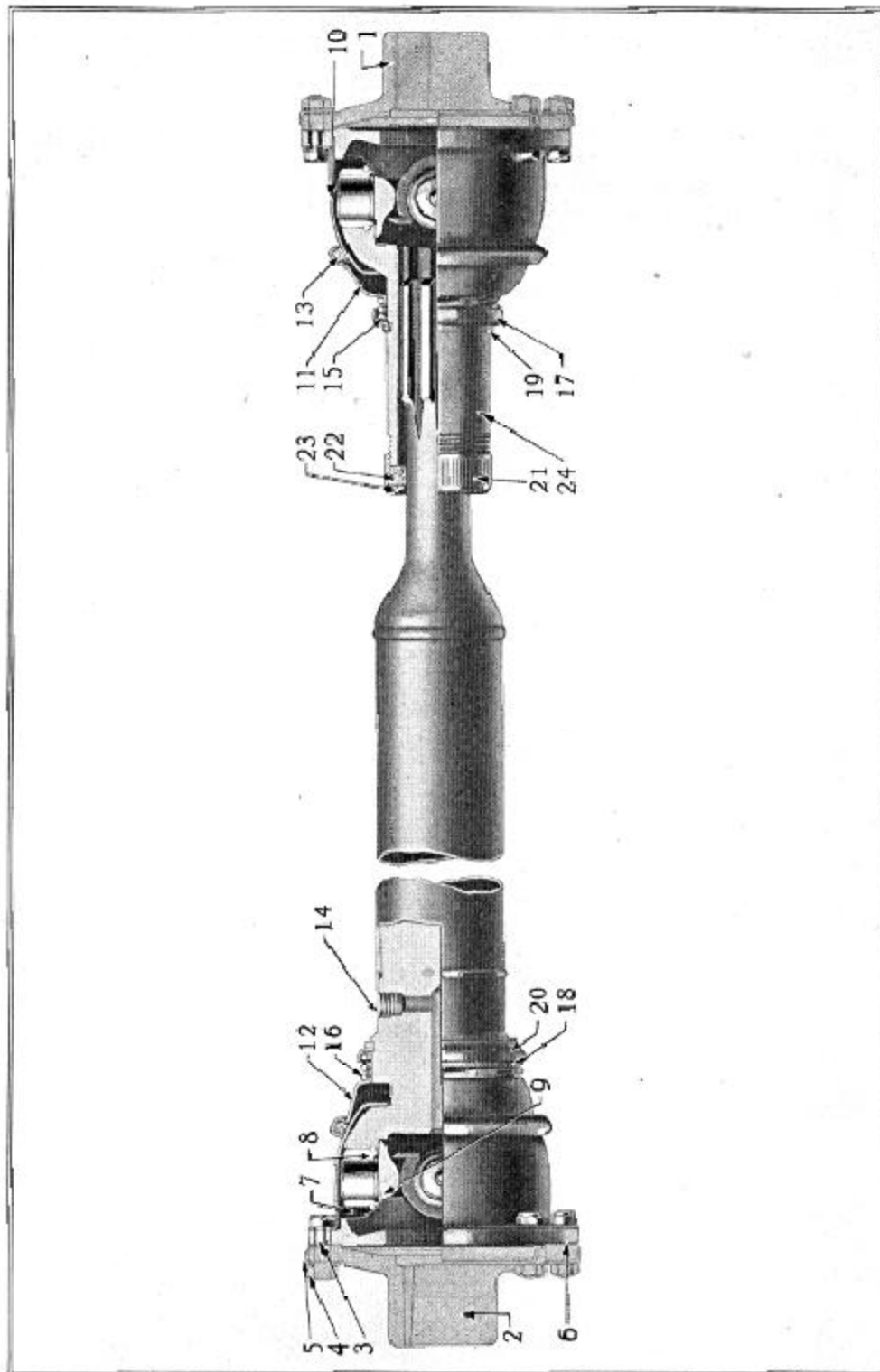

Universal Joints and Propeller Shaft

WIRING—Continued

Illus. No.	Part No.	Description	Specifications	Per Car
...	BZ 12799	Nut—clip to frame screw.....		20
...	GO 31452	Clip—wiring to dash.....		2
...	BO 18459	Screw—wiring to dash clip.....		2
36	GO 60664	Clip—battery positive cable to transmission.....		2
...	BZ 62950	Clip—battery cable.....		1
...	BZ 81728	Clip—starter cable to dash.....		1
...	BO 18165	Terminal—headlamp, side lamp, stoplight wires.....		16
...	BO 18166	Terminal—stoplight wire—starter post to ammeter wire.....		19
...	BO 18168	Terminal—starter post to ammeter wire.....		1
...	BM 18364	Terminal—spark plug cable—spark plug end.....		6
...	BM 70228	Terminal—spark plug cable—distributor end.....		6
...	GO 78146	Terminal—battery cable—starter end.....		1
37	BZ 71432	Terminal—battery cable—battery end.....		1
38	BZ 12843	Screw—terminal to battery post—positive and negative.....		2
39	BZ 12844	Nut—terminal to battery post—positive and negative.....		2
40	BM 219	Screw—negative terminal to frame.....		1
...	BZ 128	Nut—negative terminal to frame screw.....		1
41	BO 70349	Nut—headlamp conduit to radiator.....		2
42	BZ 62871	Headlamp conduit assembly.....		2
...	CZ 61666	Rubber holder—spark plug cables.....		7
43	BZ 81817	Oil gauge switch assembly.....		1
44	BZ 30308	Lighting switch.....		1
45	BZ 70552	Screw—electrolock coil wire.....		2
46	BZ 70553	Screw—electrolock gas and oil gauge wire.....		1

UNIVERSAL JOINTS AND PROPELLER SHAFT

...	CZ 63340	PROPELLER SHAFT AND UNIVERSAL JOINTS ASSEMBLY.....		1
...	BZ 63342	FRONT UNIVERSAL JOINT ASSEMBLY.....		1
...	CZ 63341	PROPELLER SHAFT AND REAR END JOINT ASSEMBLY.....		1
1	BZ 60668	Companion flange—front.....		1
2	BZ 60667	Companion flange—rear.....		8
3	BZ 70032	Bolt—companion flange..... $\frac{1}{2}$ "-28x29/30" special.....		12
4	BZ 70031	Nut—companion flange bolt..... $\frac{1}{2}$ "-28x7/32" special.....		12
5	BZ 54575	Lock—nut.....		12
6	BZ 64205	Flange yoke.....		1
7	BZ 60725	Bushing.....		8
8	BZ 51264	Ring—bushing..... Spicer No. 2 1/2-7-19.....		8
9	BZ 60719	Cross—bushing..... Spicer No. 2-5-24.....		1
10	BZ 64204	Casing—inside.....		2
11	BZ 64201	Casing—outside front.....		1
12	BZ 64200	Casing—outside rear.....		1
13	BZ 64202	Packing—outside casing.....		2
14	BZ 9773	Plug—lubrication.....		2
...	BZ 64209	Casing gasket.....		2
15	BZ 51269	Spring—outside casing front..... Spicer No. 2 1/2-12-19.....		1
16	BZ 64203	Spring—outside casing rear.....		1
17	BZ 60724	Retainer—casing spring front..... Spicer No. 2 1/2-76-19.....		1
18	BZ 64207	Retainer—casing spring rear.....		1
19	BZ 60723	Lock ring—spring retainer front..... Spicer No. 2 1/2-77-19.....		1
20	BZ 64208	Lock ring—spring retainer rear.....		1
21	BZ 51271	Dust cap—front end..... Spicer No. 2-14-19.....		1
22	BZ 51272	Felt washer—front end..... Spicer No. 2-16-13.....		1
23	BZ 51275	Retainer disc—felt washer..... Spicer No. 2-15-13.....		1
24	BZ 63345	Sleeve yoke.....		1
...	BZ 62052	Safety bracket.....		1
...	BT 395	Bolt—safety bracket..... $\frac{5}{16}$ "-18x $\frac{3}{4}$ ".....		2
...	BZ 122	Nut—safety bracket bolt..... $\frac{5}{16}$ "-18x5/16".....		2

STEERING GEAR

...	CZ 63625	STEERING GEAR COMPLETE.....		1
1	CZ 63634	STEERING WHEEL ASSEMBLY.....		1
2	BZ 70540	Nut—steering wheel.....		1
3	BZ 70541	Key—steering wheel..... No. 9 Woodruff special.....		1
...	CZ 63375	CASE AND GEARS COMPLETE.....		1
4	BZ 63382	Case.....		1
5	BZ 63384	Case adjusting stud.....		2
6	BZ 62	Nut—case adjusting stud..... $\frac{1}{2}$ "-24x21/64".....		1
7	BZ 70384	Screw..... $\frac{3}{8}$ "-24x2-5/64".....		1

When ordering give letter prefix with symbol number—Example: BX 61531.

STEERING GEAR—Continued

Illus. No.	Part No.	Description	Specifications	Per Car
8	BZ 63042	Case eccentric adjusting sleeve		1
9	BZ 63043	Case eccentric adjusting sleeve lock ring		1
10	BZ 63385	Gasket—case cover		1
11	BZ 63165	Case cover and frame bracket assembly		1
12	BZ 63051	Stud—case cover		3
	BZ 63060	Stud—case cover		3
	BZ 62	Nut—case cover stud		6
13	BZ 63044	Rivet—eccentric		1
14	CZ 63398	Column		1
15	BZ 63896	Roller bearing cage and rollers assembly—column		2
16	BZ 63402	Roller bearing cage cup—column		2
17	BZ 63899	Worm and bearing assembly		1
	BZ 70541	Key—worm		1
18	BZ 63048	Bushing—worm shaft		2
19	BZ 63386	Worm wheel		1
20	BZ 63393	Steering arm		1
21	BZ 70386	Nut—steering arm to worm wheel	$\frac{1}{4}$ "-16x7/16"	1
22	BZ 63049	Thrust washer—worm wheel	Fibre	1
23	BZ 29784	Adjusting screw—worm wheel		1
24	BZ 70278	Nut—adjusting screw—worm wheel		1
25	BZ 64431	Adjusting nut assembly—worm		1
26	BZ 63379	Dust washer—worm adjusting nut		1
27	BZ 30934	Retainer—worm adjusting nut dust washer		1
28	BZ 63380	Screw—worm adjusting		1
29	BZ 12334	Nut—worm adjusting screw		1
30	BZ 63393	Oil retainer—lower		1
31	BZ 63394	Washer—oil retainer—lower		1
32	BZ 30935	Housing cover gasket		1
	BY 231	Pipe plug—steering gear filler		1
33	BZ 36933	Clamp—jacket tube to worm adjusting nut		1
	BZ 70545	Bolt—jacket tube clamp	5/16"-24x2"	1
	BZ 70543	Nut—jacket tube clamp bolt	5/16"-24x17/64"	1
34	CZ 63378	JACKET TUBE ASSEMBLY (with bushings)		1
35	BZ 63490	Jacket tube bushing		1
36	BZ 80592	Jacket tube bracket		1
	GZ 18338	Screw—jacket tube bracket		1
37	BZ 30507	Light control lever		1
38	BZ 30508	Lock wire—light control lever		1
39	BZ 63397	Light tube and plate		1
40	BZ 63065	Silencer—light tube		1
41	BZ 63062	Throttle control lever		1
42	BZ 63869	Friction band—throttle lever		1
	BZ 63870	Friction band reinforcement		1
43	BZ 63396	Throttle tube and plate		1
44	BZ 63395	Silencer—throttle tube—upper		1
45	BZ 63068	Silencer—throttle tube—lower		1
46	BZ 70390	Screw—friction band	No. 6-32x $\frac{1}{2}$ "	1
	BZ 70391	Nut—friction band screw	No. 6-32x $\frac{1}{2}$ " sq. nut	1
47	BZ 63391	Control bracket—lower		1
48	BZ 70549	Screw—control bracket	$\frac{1}{4}$ "-20x $\frac{1}{2}$ " U. S.	1
	BZ 63020	Throttle lever assembly—lower		1
49	BZ 63024	Washer—throttle lever stop		1
50	BZ 63025	Spacer—throttle lever		1
	BZ 63030	Throttle lever—lower		1
51	BZ 70388	Screw	$\frac{1}{2}$ "-20x $\frac{1}{4}$ "	1
52	BM 272	Nut	$\frac{1}{4}$ "-20x7/32"	1
	BZ 63031	Throttle lever stop		1
53	BZ 62849	Ring—throttle and light lever—outer		1
54	BZ 62860	Lock—throttle and light lever ring		1
55	BZ 30509	Horn button		1
56	BZ 30513	Spring—horn button		1
	BZ 62088	Washer—horn button contact		1
57	BZ 63275	Horn wire assembly		1
58	BZ 30824	Nut—light tube to switch		1
59	BZ 30308	Switch—lighting—lower		1

DRAG LINK

	CZ 62744	DRAG LINK ASSEMBLY	1
	CZ 62746	Drag link	1
	BZ 60532	Ball seat	4
	BZ 60533	Plug	2
	BZ 60534	Spring	2
	BZ 9844	Boot—front	1
	BZ 22166	Boot—rear	1

When ordering give letter prefix with symbol number—Example: BX 61531.

TIRE CARRIER

Illustr. No.	Part No.	Description	Specifications	Per Car
...	BZ 64383	Fender tire support.....		1
...	BO 81732	Lock—spare tire.....		1
...	BO 31210	Key—spare tire lock.....		1
...	BZ 81679	Bracket—spare tire to dash.....		1
...	BZ 908	Bolt—spare tire to dash bracket.....		3
...	BZ 122	Nut—spare tire to dash bracket bolt.....		3
...	BZ 81677	Bolt—spare tire clamp.....		1
...	BZ 83292	Clamp—spare tire.....		1
...	BZ 83169	Stirrup and T-nut assembly.....		1
...	BZ 83164	Brace—spare tire to dash.....		1

FENDERS

...	A 83160	Front fender—R. H. (with well).....	All models.....	1
...	A 81091	Front fender—L. H.....	All models.....	1
...	A 83030	Rear fender—R. H.....	Dover Cab.....	1
...	A 83031	Rear fender—L. H.....	Dover Cab.....	1
...	A 81244	Rear fender—R. H.....	Panel Delivery.....	1
...	A 81245	Rear fender—L. H.....	Panel Delivery.....	1
...	A 84425	Rear fender—R. H.....	Express, Canopy, Screen Canopy.....	1
...	A 84426	Rear fender—L. H.....	Express, Canopy, Screen Canopy.....	1
...	A 84565	Rear fender assembly—R. H.....	Hercules Bodies.....	1
...	A 84566	Rear fender assembly—L. H.....	Hercules Bodies.....	1
...	BZ 84427	Rear fender—body bracket.....		2
...	GZ 12275	Bolt.....	5/16"-18x1".....	12
...	BZ 122	Nut.....	5/16"-18x5/16".....	14
...	BO 12120	Nut.....	3/4"-20x1 1/4" sq.....	2
...	BZ 70139	Screw.....	1/4"-20x3/4".....	2
...	BO 18447	Screw.....	No. 10-32x3/4".....	20
...	BZ 12799	Nut.....	No. 10-32x3/4".....	20
...	BO 70452	Washer.....	1/4" countersunk brass.....	2
...	GZ 10214	Bolt.....	1/2"-13x1 1/4".....	2

RUNNING BOARDS

...	CZ 83278	RUNNING BOARD COMPLETE—R. H.....		1
...	CZ 83279	RUNNING BOARD COMPLETE—L. H.....		1
...	CZ 78638	Moulding.....		2
...	BZ 18107	Rivet.....	9/64"x3/8" split.....	22
...	CZ 83277	Covering.....	Rubber.....	2

RUNNING BOARD SPLASH GUARD

...	A 81073	Running board splash guard—R. H.....		1
...	A 81074	Running board splash guard—L. H.....		1
...	BO 18447	Screw.....	No. 10-32x3/4".....	20
...	BZ 12799	Nut.....	No. 10-32x3/4".....	20
...	BZ 83080	Steering gear hole cover.....		1

MOTOR, RADIATOR AND REAR SPLASH GUARDS

...	A 62569	Motor splash guard—front.....		1
...	A 64326	Motor splash guard assembly—R. H.....		1
...	BO 64327	Motor splash guard assembly—L. H.....		1
...	BO 12126	Bolt.....	No. 10-32x3/4".....	6
...	BZ 12799	Nut.....	No. 10-32x3/4".....	8
...	BM 12498	Screw.....	3/4"-20x7/16".....	5
...	BZ 18069	Screw.....	No. 10-32x3/4".....	2
...	BZ 61513	Flywheel splash guard.....		1
...	BT 395	Bolt.....	5/16"-18x5/8".....	1
...	BZ 122	Nut.....	5/16"-18x5/16".....	3
...	A 83202	Radiator splash guard assembly.....		1
...	A 79401	Rear dust shield assembly (over gas tank) (enam- eled).....		1
...	BZ 70149	Rear dust shield screw.....		4
...	BO 70452	Rear dust shield finish washer.....		4
...	BO 12120	Rear dust shield nut.....		4

When ordering give letter prefix with symbol number—Example: BX 61531.

BONNET ASSEMBLY

Illus. No.	Part No.	Description	Specifications	Per Car
...	A 83114	BONNET COMPLETE (specify color).....		1
...	BZ 83130	BONNET LOCK ASSEMBLY.....		4
...	GO 18342	Screw.....	No. 10-32x $\frac{1}{4}$ "	8
...	BZ 12799	Nut.....	No. 10-32x $\frac{1}{4}$ "	8
...	BO 13362	Handle.....	Enameled	2
...	BO 83132	Catch.....		4

HEADLAMP

...	BO 64313	HEADLAMP COMPLETE.....		2
...	BO 70009	Nut—headlamp to bracket.....		2
...	BO 64315	HEADLAMP DOOR ASSEMBLY.....		2
...	BO 63514	Headlamp lens.....		2
...	BO 30450	Spring—lens.....		2
...	BO 64421	Reflector assembly.....		2
...	BO 30061	Cushion—headlamp lens.....		2
...	BO 31295	Screw—headlamp door.....		2
...	BO 30060	Retainer—door screw.....		2
...	BO 30537	Washer—focus screw backing.....		2
...	BO 70380	Screw—focusing.....		2
...	BO 30370	Screw—backing focus.....		2
...	BO 62973	Spring—focus screw.....		2
...	BO 30371	Connector wires and socket assembly.....		2
...	BO 62885	Arm—headlamp cam.....		2
...	BO 30358	Cam spring.....		2
...	BO 30369	Cam.....		2
...	BO 30373	Cam pin.....		2
...	BO 62869	Lockwasher—anchor bolt.....		2
...	BO 60	Plain washer—anchor bolt.....		2
...	BZ 70009	Anchor bolt nut.....		2
...	BO 64316	Headlamp conduit and plug assembly.....		2
...	BO 30350	Headlamp terminal socket.....		2
...	BO 30351	Headlamp terminal socket sleeve.....		2

STOP AND TAIL LIGHT ASSEMBLY

...	BO 64318	TAIL AND STOP LAMP ASSEMBLY.....		2
...	BO 70313	Nut—lamp to bracket.....		2
...	BO 30379	Lens.....		1
...	BO 64319	Door assembly (includes lens).....		1
...	BO 70365	Screw.....	No. 8-32x $\frac{3}{4}$ " oval head machine screw	2
...	BO 30378	Gasket—lens.....		1
...	BO 70313	Square nut.....	$\frac{1}{4}$ "-20x3/16"x7/16"	2
...	BO 30381	Gasket—license lens.....		1
...	BO 30376	Lens—license.....		1
...	BO 30136	Terminal—complete.....		1
...	BZ 28068	Stoplight switch assembly.....		1
...	BO 12126	Screw—switch to frame.....		2
...	BZ 12799	Nut—switch to frame screw.....		2

LAMP BRACKETS AND TIE BAR

...	CZ 83268	Headlamp tie bar.....		1
...	BZ 70497	Acorn nut—tie bar.....	$\frac{1}{4}$ "-20x7/16"	1
...	BZ 70498	Acorn head bolt.....	$\frac{1}{4}$ "-20x13/16"	1
...	BZ 81554	Headlamp bracket—R. H.....		4
...	BZ 81555	Headlamp bracket—L. H.....		4
...	BZ 70485	Bolt.....	$\frac{3}{8}$ "-16x1 $\frac{1}{4}$ "	4
...	BM 110	Nut.....	$\frac{3}{8}$ "-16x $\frac{3}{4}$ "	4
...	BZ 83249	Tail lamp arm and license tag bracket.....		1

STARTER BUTTON AND WIRE

...	BO 81821	STARTER BUTTON AND WIRE ASSEMBLY.....		1
...	BO 70121	Lockwasher—shakeproof.....	$\frac{3}{8}$ "	1
...	BO 70122	Nut.....	$\frac{3}{8}$ "-24x5/32"	1
...	BO 62269	Starter button wire clamp.....		1
...	BO 62273	Starter cable and dash clip.....		1
...	BO 18447	Screw.....	No. 10-32x $\frac{1}{8}$ "	2
...	BO 18479	Nut.....	No. 10-32x3/16"	2

When ordering give letter prefix with symbol number—Example: BX 61531.

RUBBER MATS AND FELT PADS

Illus. No.	Part No.	Description	Specifications	Per Car
...	CO 83280	FRONT FLOOR MAT AND PAD COMPLETE.....		1
...	BO 84376	Dash pad.....		1

HORN

The horn assembly is serviced by the Hudson Motor Car Co. All horn parts are to be ordered from the E. A. Laboratories Co., Brooklyn, N. Y.

...	BZ 60666	HORN ASSEMBLY.....		1
...	BZ 62304	Horn bracket assembly.....		1

INSTRUMENTS AND MOUNTINGS

...	BO 79755	OIL PRESSURE GAUGE ASSEMBLY.....		1
...	BO 79756	Ammeter assembly.....		1
...	BO 81812	Motor temperature indicator.....		1
...	BO 81811	Gasoline and oil level gauge assembly.....		1
...	BO 70124	Screw.....	No. 8-32x3/16	8
...	BO 81817	Selector switch—gas and oil.....		1
...	BO 81815	Instrument lamp and socket assembly.....	Use 6-8 volt, 3 C. P. bulb	1
...	BO 79601	Anchor clip—upper.....		2
...	BO 79602	Anchor clip—lower.....		2
...	BO 70398	Clinch nut.....	1/2"-20	4
...	BO 78453	Instrument frame and mounting attaching screw.....		4
...	BO 18461	Instrument frame and mounting shakeproof lock-washer.....		4
...	BO 81818	Instrument panel escutcheon plate.....		1
...	BO 83220	Dial—instrument frame.....		1
...	BO 83221	Rim—instrument frame.....		1
...	BO 81845	Base—instrument frame.....		1
...	BO 79757	Glass—instrument frame.....		1

ACCESSORIES

The units listed below are usually termed accessories and are serviced by the manufacturer and its dealers. Parts or complete assemblies should be obtained direct from one of these.

BATTERY

The Electric Storage Battery Co., Philadelphia, Pa.

ELECTRICAL EQUIPMENT

Generator, starting motor, ignition coil and distributor—The Electric Auto-Lite Co., Toledo, Ohio.

SPEEDOMETER

Stewart-Warner Speedometer Corp., Chicago, Ill.

VACUUM TANK

Stewart-Warner Speedometer Corp., Chicago, Ill.

WINDSHIELD CLEANER

Trico Products Corp., Buffalo, New York.

TOOLS

...	BZ 64515	TOOL KIT ASSEMBLY.....		1
...	BZ 63566	STARTING CRANK ASSEMBLY.....		1
...	GZ 11074	Wheel puller.....		1
...	GZ 26557	Wheel puller screw.....		1
...	BZ 29178	Jack.....		1
...	BZ 29179	Jack handle extension.....		1
...	BZ 63425	Oil can.....		1
...	BZ 28620	Oil can holder.....		1
...	BM 22594	Spark plug and main bearing nut wrench.....		1
...	BZ 60625	Eccentric adjusting wrench.....		1
...	BZ 31149	Hub cap wrench.....		1
...	BZ 28533	Valve tappet and oil pump wrench.....		1
...	BZ 31361	Socket wrench wheel pilot.....		2

When ordering give letter prefix with symbol number—Example: BX 61531.

ELECTROLOCK

Illus. No.	Part No.	Description	Specifications	Per Car
...	BZ 63513	ELECTROLOCK ASSEMBLY		2
...	BZ 70552	Screw—coil wires		2
...	BZ 70551	Shakeproof lockwasher—coil wire screw		1
...	BZ 70553	Screw—gas and oil gauge wire		1
...	BZ 70563	Shakeproof lockwasher—gas and oil gauge wire screw		1
...	BZ 64370	Distributor post and base assembly		1
...	BO 30734	Clamp nut—electrolock to instrument panel		2

RIGHT HAND DRIVE PARTS

FRONT AXLE—R. H. D.

...	CX 64276	FRONT AXLE ASSEMBLY		1
...	BX 62708	Steering arm—R. H.		1
...	BX 62709	Steering arm—L. H.		1

FRAME—R. H. D.

...	CF 64456	FRAME ASSEMBLY		1
...	BZ 62777	Bracket—stoplight switch		1

DRAG LINK—R. H. D.

...	CZ 62745	DRAG LINK ASSEMBLY		1
...	CZ 62747	Drag link		1

GASOLINE TUBE—R. H. D.

...	BZ 63367	TUBE ASSEMBLY—vacuum tank to gas tank		1
-----	----------	---------------------------------------	--	---

PEDAL CONTROL—R. H. D.

...	BZ 63283	PEDAL CONTROL ASSEMBLY		1
...	BZ 62313	Clutch pedal lever		1
...	BZ 61430	PEDAL BRACKET ASSEMBLY		1
...	BZ 61231	Clutch pedal		1
...	BZ 61232	Brake pedal		1
...	BZ 60707	Pedal shaft		1
...	BZ 60708	Brake pedal stop pin		1

BRAKE CONTROL—R. H. D. AND L. H. D.

Export. These parts are used in addition to ones listed for domestic cars, page 27.

...	BZ 63245	Brake cross shaft bracket—R. H. D. only		2
...	BZ 122	Nut—brake cross shaft bracket		4
...	BZ 905	Bolt—brake cross shaft bracket		4
...	BZ 63246	Brake cross shaft and lever—L. H. D. Export only		2
...	BZ 7114	Brake cross shaft and lever taper pin		2
...	BZ 63247	Brake cross shaft link—R. H. D. only		2
...	BZ 8583	Clevis pin—cross shaft link		1
...	BZ 70301	Clevis pin—cross shaft link		1
...	BZ 63248	Rear brake release spring—R.H.D. only		2
...	BZ 63249	Cross shaft to rear idler rod—L. H.—R.H.D. only		1
...	BZ 63250	Cross shaft to rear idler rod—R. H.—R.H.D. only		1
...	BZ 8583	Cross shaft to rear idler rod clevis pin		2
...	BZ 70301	Cross shaft to rear idler rod clevis pin		2
...	BZ 62764	Rod—brake pedal to play link—R.H.D. only		1
...	BZ 63251	Hand brake lever to cross shaft link—R.H.D. only		1
...	BZ 6440	Hand brake lever to cross shaft link washer		2
...	BZ 8583	Hand brake lever to cross shaft link clevis pin		1
...	BZ 62758	Brake cross shaft—R.H.D.		2

When ordering give letter prefix with symbol number—Example: BX 61531.

MOTOR

Illus. No.	Part No.	Description	Specifications	Per Car
...	BM 64501	PIPE ASSEMBLY—pump to union.....		1

MOTOR CONTROL—R. H. D.

...	BZ 60703	Accelerator pedal bracket.....		1
...	BZ 63409	Accelerator pedal shaft.....		1
...	BZ 60711	Accelerator lever spring.....		1
...	BZ 63376	Rod—accelerator.....		1
...	BZ 63410	Motor control wire clip assembly.....		1

TRANSMISSION—R. H. D.

...	CT 62306	TRANSMISSION ASSEMBLY.....		1
...	CT 62310	Transmission case.....		1
...	BT 62309	Transmission front bearing cap.....		1
...	BR 64495	Clutch yoke.....		1

HAND BRAKE LEVER—R. H. D.

...	BS 63597	Hand brake lever.....		1
...	BS 62347	Rod—latch.....		1

STEERING GEAR—R. H. D.

...	CZ 63626	STEERING GEAR COMPLETE.....		1
...	CZ 63634	STEERING WHEEL ASSEMBLY.....		1
...	BZ 63381	Nut—steering wheel.....		1
...	CZ 63376	CASE AND GEARS COMPLETE.....		1
...	BZ 63383	Case.....		1
...	BZ 63900	Worm and bearing assembly.....		1
...	BZ 63387	Worm wheel.....		1
...	BZ 63390	Steering arm.....		1
...	BZ 63879	Case cover and frame bracket assembly.....		1
...	BZ 63865	Housing and seal.....		1
...	BZ 63082	Case cover (felt).....		1
...	BZ 63087	Lower column bushing washer.....		1
...	BZ 64466	Jacket tube and bushing assembly.....		1
...	BZ 63037	Horn button retainer.....		1
...	BZ 63053	Horn button retainer ring.....		1
...	BZ 63274	Horn wire assembly.....		1
...	BZ 63080	Insulator—horn, wire, lower.....		1
...	BZ 63868	Case cover washer.....		1

RUBBER MATS AND FELT PADS—R. H. D.

...	CO 83281	FRONT FLOOR MAT AND PAD COMPLETE.....		1
-----	----------	---------------------------------------	--	---

TAIL LIGHT ARM—R. H. D.

...	BZ 83252	Tail light arm and license tag bracket.....		1
-----	----------	---	--	---

DOVER BODIES

PANEL DELIVERY, EXPRESS, CANOPY, SCREEN CANOPY, CAB

BODIES COMPLETE

Illus. No.	Part No.	Description	Specifications	Per Car
...	BO 12320	Body bolt—panel delivery	7/16"-14x3 1/4"	6
...	BO 12351	Body bolt—panel delivery	7/16"-14x4 1/2"	2
...	BO 70573	Body bolt nut—panel delivery	7/16"-14x3 1/4"	12
...	BO 70642	Body bolt nut—panel delivery	7/16"-14x6 1/4"	4
...	BO 80472	Shim—8 required cab, 12 all other models		
...	BO 12351	Body bolt	7/16"-14x4 1/2"	2
...	BO 70642	Body bolt	7/16"-14x6 1/4"	4
...	BO 12351	Body bolt—express, canopy, screen canopy	7/16"-14x4 1/2"	2
...	BO 70642	Body bolt—express, canopy, screen canopy	7/16"-14x6 1/4"	4
...	BO 70655	Body bolt—express, canopy, screen canopy	1/2"-20x1 1/2"	12
...	BO 272	Nut	1/2"-20x3/4"	12
...	CO 84483	Cab complete		1
...	BO 12320	Bolt—cab	7/16"-14x3 1/4"	8
...	BO 70573	Nut—cab	7/16"-14x3 1/4"	8

FRONT SECTION

...	CO 84498	Cowl and dash assembly		1
...	BO 78924	U. S. belt finish panel shim		2
...	BO 81281	Dash to bonnet lacing		2
...	BO 18353	Rivet—dash to bonnet lacing		24
...	CO 84432	Cowl quarter kick panel—R. H.		1
...	CO 84433	Cowl quarter kick panel—L. H.		1
...	BO 18470	Screw (No. 10-32x 1/2" round head)		5
...	CO 12316	Washer (No. 10 countersunk)		5
...	BO 76356	Dash to bonnet hinge bracket		1
...	BO 76390	Plate dash to rod tie rod		1
...	BO 2352	Bolt	5/16"-24x1	1
...	BO 84376	Dash pad		1

COWL VENTILATOR

...	CO 81415	Cover assembly		1
...	BO 81665	Weatherstrip		1
...	BO 81623	Cover hinge adjusting plate		2
...	BO 18464	Screw	1/4"-20x11/16"	4
...	BO 12120	Nut	1/4"-20x 1/8" square	4
...	BO 70519	Rivet	5/16"x13/32"	2
...	BO 81628	Hinge—R. H. on cowl		1
...	BO 81629	Hinge—L. H.—on cowl		1
...	BO 18419	Rivet	3/16"x7/32"	4
...	BO 81636	Control bracket		1
...	BO 70028	Rivet	3/16"x 5/8" truss head	3
...	BO 81641	Drain pipe		1
...	BO 81669	Drain tube (rubber)		1
...	BO 81675	Drain tube clip		3
...	BO 18459	Screw—drain tube clip	No. 20—32x 1/2"	3
...	BO 18479	Nut—drain tube clip		3
...	BO 81667	Ventilator handle		1
...	BO 81645	Handle stud spring		1
...	BO 70499	Clevis pin	1/4"x9/16"	1
...	BO 81644	Spring—cover to instrument panel		2
...	BO 82524	Spring clip		2
...	BO 18453	Spring clip screw		2
...	BO 12120	Spring clip screw nut		2

FRONT PILLAR AND WINDSHIELD PANELS

...	CO 81378	Front pillar assembly		1
...	CO 83228	Windshield belt finish panel		1
...	CO 84413	Windshield header finish panel assembly (lacquer)		1
...	BO 79567	Windshield belt finish panel retainer—R. H.		1
...	BO 79568	Windshield belt finish panel retainer—L. H.		1
...	BO 84414	Rear view mirror and bracket assembly—L. H. D.		1

When ordering give letter prefix with symbol number—Example: BX 61531.

INSTRUMENT PANEL

Illus. No.	Part No.	Description	Specifications	Per Car
...	CO 83224	Instrument panel assembly—L. H. D.		1
...	CO 83225	Instrument panel assembly—R. H. D.		1
...	BO 79147	Steering gear cowl bracket—L. H. D.		1
...	BO 79146	Steering gear cowl bracket—R. H. D.		1
...	BO 79235	Steering gear column suspension bracket clamp		1
...	BO 79238	Steering gear column suspension bracket		1
...	BO 70400	Clinch nut		2
...	BO 70095	Bolt	13/32"x1"	2
...	BO 304	Bolt	5/8"-16x1"	2
...	BO 70573	Nut	7/16"-14x3/4"	4

WINDSHIELD COMPLETE AND FITTINGS

Same as Essex Coach.

WINDSHIELD VISOR

...	CO 84409	Visor—Panel	Biddle & Smart	1
...	CO 81256	Visor—cab, express, canopy and screen canopy		1

CAB SECTION

DOORS

...	CO 84415	Front door—complete—R. H.		1
...	CO 84416	Front door complete—L. H.		1
...	CO 84495	Front skeleton door—R. H.		1
...	CO 84496	Front skeleton door—L. H.		1
...	CO 84422	Door trimboard—R. H.		1
...	CO 84423	Door trimboard—L. H.		1
...	BO 84485	Door trimboard silencer—long		2
...	BO 84486	Door trimboard silencer—short		2
...	BO 78641	Door check strap		2
...	BO 78595	Door check strap retainer		4
...	BO 70304	Screw	No. 10-32x1/4"	8

DOOR LOCKS AND HANDLES

...	BO 84420	Door lock assembly—R. H.		1
...	BO 84421	Door lock assembly—L. H.		1
...	BO 84377	Door outside locking handle—R. H.		1
...	BO 84378	Door outside locking handle—L. H.		1
...	BO 31240	Door key		2
...	BO 79315	Door inside handle		2

DOOR DOVETAILS AND BUMPERS

...	BO 79946	Dovetail—complete—female		2
...	BO 79228	Dovetail case		2
...	BO 18458	Screw	1/4"-20x1 1/2"	4
...	BO 70399	Clinch nut	1/2"-20	4
...	BO 18475	Shakeproof lockwasher	1/2" countersunk	4
...	BO 79150	Dovetail rubber bumper		4
...	BO 79149	Dovetail rubber bumper retainer		2
...	BO 78994	Dovetail—male		2
...	BO 78995	Dovetail plate		2
...	BO 78596	Striker plate		2
...	BO 75151	Door rubber bumper		4
...	BO 75152	Door rubber bumper retainer		4
...	BO 18458	Screw	1/4"-20x1 1/2" oval head	4

DOOR GLASS AND CHANNELS

...	78808	Door glass (not supplied)		2
...	BO 78724	Door glass rubber bumper		2
...	BO 81535	Door glass side channel assembly		4
...	BO 75261	Door glass side channel clip		8
...	BO 70028	Rivet	No. 9x1/2" crown head	8
...	BO 70396	Clinch nut	No. 10-32 round type—long	12
...	BO 78581	Door glass bottom channel assembly—R. H.		1
...	BO 78582	Door glass bottom channel assembly—L. H.		1
...	BO 78823	Cork shim—glass to channel—thin		2
...	BO 78824	Cork shim—glass to channel—medium		2
...	BO 78825	Cork shim—glass to channel—thick		2

When ordering give letter prefix with symbol number—Example: BX 61531.

DOOR WINDOW REGULATORS

Illus. No.	Part No.	Description	Specifications	Per Car
...	BO 79240	Window regulator assembly—R. H.	1
...	BO 79241	Window regulator assembly—L. H.	1
...	BO 77309	Window Regulator handle	2
...	BO 79308	Window regulator handle pin	2
...	BO 79709	Window regulator handle escutcheon spring	2
...	BO 79294	Window regulator handle escutcheon spring plate	2

DOOR WEATHERSTRIPS AND TRIM RETAINERS

...	BO 79044	Door glass weatherstrip and retainer assembly—top—on door	2
...	BO 79043	Door and quarter window/belt weatherstrip and retainer assembly	2
...	BO 84429	Door bottom trim retainer and weatherstrip assembly	2
...	BO 78987	Door trim retainer—R. H.—side	2
...	BO 78988	Door trim retainer—L. H.—side	2

DOOR WINDLACE

...	CO 84453	Lock pillar windlace retainer assembly—R. H.	1
...	CO 84454	Lock pillar windlace retainer assembly—L. H.	1
...	BO 84494	Door header windlace	2
...	BO 84493	Hinge pillar windlace	2

DOOR FINISH STRIPS AND PANELS

...	CO 84457	Door window finish moulding and weatherstrip assembly	2
-----	----------	---	-------	---

FINISH PANELS

...	CO 84413	Windshield leader finish panel assembly	1
...	CO 84430	Door header trim board—R. H.	1
...	CO 84431	Door header trim board—L. H.	1
...	CO 84455	Door header inside panel assembly (lacquer)	1

BODY SECTION

PANELS

...	CO 84402	Side panel complete R. H.—Panel Delivery	Biddle & Smart	1
...	CO 84403	Side panel complete, L. H.—Panel Delivery	Biddle & Smart	1
...	CO 84404	Side door header panel assembly—R. H.	Biddle & Smart	1
...	CO 84405	Side door header panel assembly—L. H.	Biddle & Smart	1
...	CO 84439	Rear corner assembly—R. H.—Express, Canopy, Screen Canopy, Cab	Biddle & Smart	1
...	CO 84440	Rear corner assembly—L. H.—Express, Canopy, Screen Canopy, Cab	Biddle & Smart	1

REAR DOORS

...	CO 84417	Rear door complete—R. H.—Panel Delivery	Biddle & Smart	1
...	CO 84418	Rear door complete—L. H.—Panel Delivery	Biddle & Smart	1
...	CO 84419	Rear door hinge pin, Panel Delivery	Biddle & Smart	1

SIDE SILLS AND FILLERS

...	CO 84467	Side sill assembly—R. H.—Panel Delivery	1
...	CO 84468	Side sill assembly—L. H.—Panel Delivery	1
...	CO 84473	Sill wood filler—R. H.—Panel Delivery	1
...	CO 84474	Sill wood filler—L. H.—Panel Delivery	1
...	CO 84463	Side sill assembly—R. H.—Cab, Express, Canopy, Screen Canopy	1
...	CO 84464	Side sill assembly—L. H.—Cab, Express, Canopy, Screen Canopy	1
...	CO 84471	Sill wood filler—R. H.—Cab, Express, Canopy, Screen Canopy	1
...	CO 84472	Sill wood filler—L. H.—Cab, Express, Canopy, Screen Canopy	1
...	CO 75021	Sill center cross member assembly	1
...	CO 77333	Sill front cross member assembly	1
...	BO 80156	Sill No. 2 anchor bracket assembly	1

When ordering give letter prefix with symbol number—Example: BX 61531.

FLOOR SECTION

Illus. No.	Part No.	Description	Specifications	Per Car
CO 84400		Platform assembly	Biddle & Smart	1
CO 84406		Floor strips—P.N.L.	Biddle & Smart	2
CO 82308		Battery cover assembly		1
CO 75141		Front floor board assembly—wood		1
CO 80607		Floor board center—right		1
CO 84412		Folding seat assembly	Biddle & Smart	1
CO 84451		Tool box assembly	Biddle & Smart	1
CO 84407		Partition board	Biddle & Smart	1
BO 83276		Folding seat floor mat		1
CO 79462		Toe plate assembly		2
CO 76391		Front floor board—steel		1
CO 81374		Toe board riser assembly—R. H.		1
CO 81374		Toe board riser assembly—L. H.		1
BO 83280		Mat and pad complete—L. H. D.		1
BO 83281		Mat and pad complete—R. H. D.		1

PILLARS AND BRACES

CO 81078		Lock pillar—R. H.		1
CO 81079		Lock pillar—L. H.		1
CO 84441		Rear pillar	Biddle & Smart	2
BO 84443		Rear pillar supporting iron—Canopy, Screen Canopy		
BO 84447		Rear pillar angle brace—Canopy, Screen Canopy	Biddle & Smart	2
BO 81684		Lock pillar to roof filler	Biddle & Smart	2
BO 84428		Front hinge pillar to sill brace tapping plate		2
BO 84429		Front hinge pillar to sill brace tapping plate retainer		2

TOP SECTION

CO 84438		Roof complete—Cab	Biddle & Smart	1
CO 84408		Roof complete—Panel Delivery	Biddle & Smart	1
CO 84437		Roof complete—Canopy & Screen Canopy	Biddle & Smart	1
CO 84434		Side screen assembly—Screen Canopy		2
CO 84435		Front screen assembly—Screen Canopy		1
CO 84436		Rear screen assembly—Screen Canopy		1
BO 84491		Rear screen bracket—R. H.—Screen Canopy		1
BO 84492		Rear screen bracket—L. H.—Screen Canopy		1
BO 84444		Front curtain assembly—Canopy, Screen Canopy	Biddle & Smart	1
BO 84445		Side curtain assembly—Canopy, Screen Canopy	Biddle & Smart	2
BO 84446		Rear curtain assembly—Canopy, Screen Canopy	Biddle & Smart	1
CO 84487		Front door drip moulding		1
CO 84488		Front door drip moulding filler		1
BO 84497		Top deck material (cut to size)		1
BO 79849		Locktite binding, 1-3/16 wide (specify length)		As req.

When ordering give letter prefix with symbol number—Example: BX 61531.

