

DELCO

PIECE PARTS CATALOG

HUDSON

1918 to 1919 MODELS



The
Dayton Engineering Laboratories Co.
Dayton, Ohio

DELCO

PIECE PARTS CATALOG

HUDSON

1918 to 1919 MODELS



FIRST EDITION

The
Dayton Engineering Laboratories Co.
Dayton, Ohio

THE DELCO system is the pioneer in the electric starting, lighting and ignition field. Throughout the entire period of electrical development it has led the way.

Our Research and Experimental laboratories have placed DELCO equipment foremost in the Starting, Lighting and Ignition Field.

Practically without exception, the cars with DELCO Equipment stand foremost in their class.

Intelligent automobile buyers have learned that the automobile manufacturer who uses DELCO Equipment is the manufacturer who places QUALITY before PRICE.

When Piece Parts are required use only genuine DELCO parts. Parts made in our factory are tested mechanically and electrically. Order Piece Parts from our authorized service representatives by giving the Piece Parts numbers shown in this Catalog.

**There is one reason for Delco
success --- and that is Delco
performance.**

PRICES

Prices are not shown in this catalog but are in a separate booklet, copy of which is sent with each catalog.

TERMS

Remittance must accompany the order in the form of draft, money order or cash, by registered mail. Personal checks will not be accepted.

If remittance does not accompany the order, shipment will be made C. O. D., or sight draft attached to bill-of-lading.

INDEX

On page iv is an index of the motor car models, by years, showing the electrical system for each model, and the pages on which the description of the piece parts for each complete piece of apparatus, will be found.

On page 22 begins an index in numerical order of all piece parts shown in this catalog, and the page numbers on which each part will be found.

On page iv is a chart showing the complete electrical system used on all models.

TO FIND PIECE PARTS IN CATALOG

Refer to index beginning on page iv and select the motor car model for which the piece part is required. The complete pieces of apparatus which make up the electrical system are listed under each model. When a complete system is not listed, only the parts shown were furnished by Delco.

Opposite each complete piece of apparatus is shown the page number on which its description of piece parts begins. Preceding the description of piece parts, on the page shown under the name of the complete piece of apparatus, its illustration will be found. From the illustration and description, select the part required. If a part is first identified on the illustration, it may be located in the description by referring to its piece number given in the numerical index beginning on page 22, beside which is listed all the page numbers on which the description of that part is found.

HOW TO ORDER PARTS

(A mistake and delay in filling an order for parts may keep an automobile out of service for a longer time than is necessary. It is often difficult to fill orders for piece parts. To avoid delay and mistakes, give all or as much as possible, of the information requested below.)

In the description of the piece parts, the numbers in the column at the extreme left of each page are the piece numbers of the parts.

The number in the third column represent the quantity of each piece part required in the assembly under which it is listed. (These numbers do not necessarily represent the quantity of each piece part required for the complete piece of apparatus).

On all orders, the piece number, name of piece and quantity of parts wanted on the order, should be given. However, if there is any doubt regarding the correctness of the piece number of the part required, send a sketch and explain where the part is used, or send in the old part as a sample, transportation charges prepaid. (Unless instructions accompany to return the sample, it will be scrapped).

In addition to the above, give the name, year, model, and serial number of the car for which the piece parts are required. Also give the serial number or date, and number of the complete piece of apparatus in which the part is to be used.

Write plainly the name and address to which the shipment is to be made. Give shipping instructions, i. e. freight, express, parcel post insured.

In all cases where the serial number of the complete piece of apparatus is furnished with the order for repair parts, parts will be shipped to serial number, regardless of whether the part number given is correct or not.

If parts are wanted for stock only, it is unnecessary to give serial number.

STORAGE BATTERIES

We do not sell storage batteries or storage battery parts. All orders for batteries or their parts must be placed with the storage battery manufacturers or their representatives.

CLAIMS FOR SHORTAGE, DAMAGE, AND ERROR

Claims for shortage or errors in packing must be made immediately upon receipt of the shipment, and must be accompanied by the original packing slip.

Claims for damage or shortages during transfer should be filled with the transportation company by the consignee. Our responsibility ceases upon delivery of the shipment to the transportation company. The transportation company's receipt for the shipment is evidence that they have received the shipment as billed, and in good condition.

Index of 1918 and 1919 Hudson Models Using Delco Equipment

Under each Model is listed the complete Electrical System used on that Model, and the page number on which the description of piece part begins.

Super-Six J Model 1918 Hudson

Delco system 113		Page No
No. 82	MOTOR GENERATOR	3
No. 12207	MOTOR CLUTCH	7
No. 5134	AUTOMATIC DISTRIBUTOR	9
No. 2127	IGNITION COIL	11
No. 1106	COMBINATION SWITCH	13

Super-Six Model 1919 Hudson

Delco System 216		Page No.
No. 140	MOTOR GENERATOR	16
No. 13861	MOTOR CLUTCH	20
No. 5134	AUTOMATIC DISTRIBUTOR	21
No. 2127	IGNITION COIL	21
No. 1106	COMBINATION SWITCH	21

Chart Showing Hudson Models and Delco Apparatus Used on Each Model

Hudson Models	Year Used	Delco System	Motor Generator	Motor Clutch	Automatic Distributor	Ignition Coil	Combination Switch
Super-Six J	1918	113	82	12207	5134	2127	1106
Super-Six	1919	216	140	13861	5134	2127	1106

Hudson 1918—Super-Six—Model J

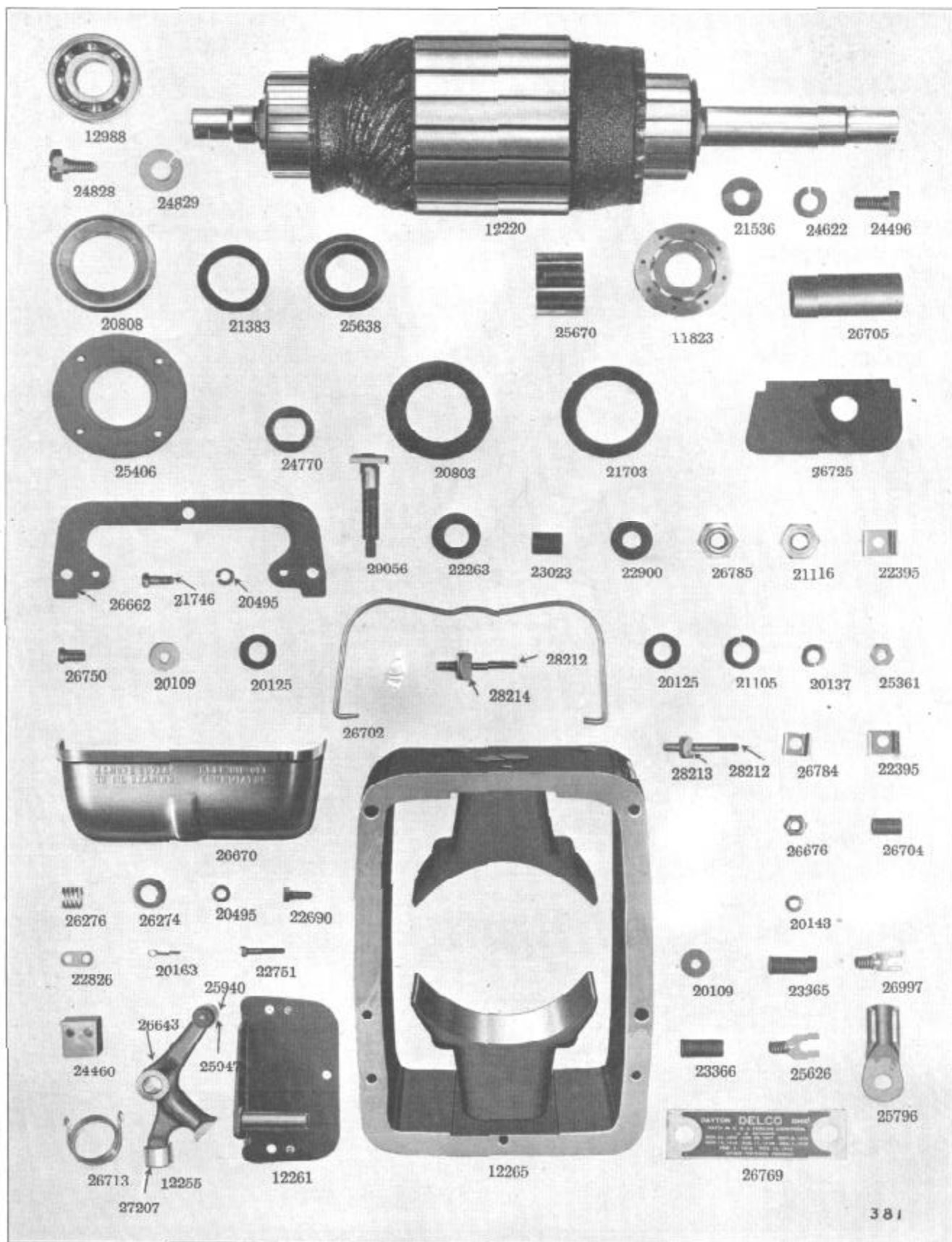

No. 82 MOTOR GENERATOR

Hudson 1918—Super-Six—Model J

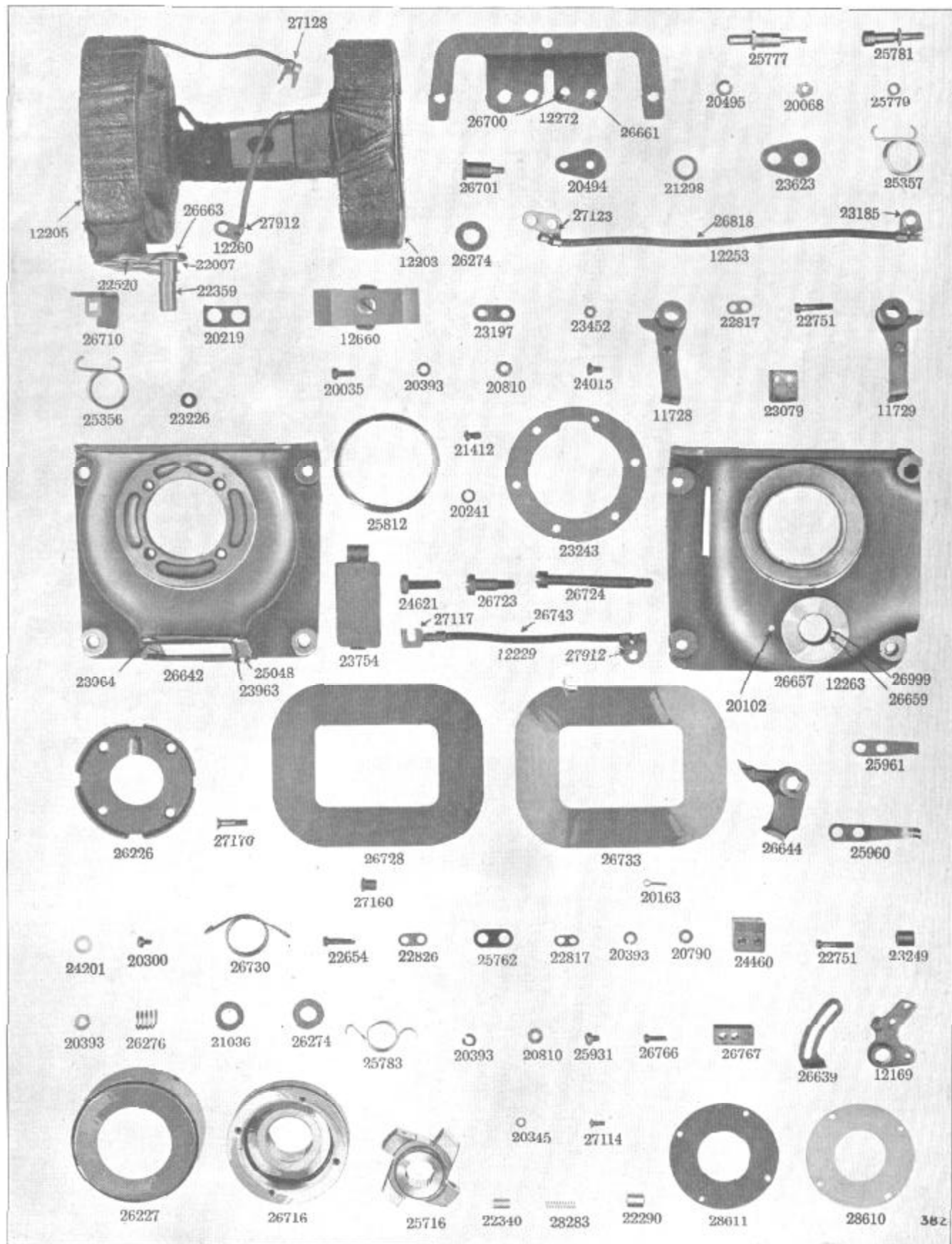

No. 82 MOTOR GENERATOR

HUDSON 1918 SUPER-SIX MODEL J

DELCO SYSTEM 113

No. 82. MOTOR GENERATOR

Illustrated on pages 1 and 2

Piece Number	NAME OF PART	Quantity Required
82	MOTOR GENERATOR	1
12265	Generator Frame Assembly (Includes the next 2 Items)	1
22065	Screw for Pole Piece	2
20039	Dowel Pin for Pole Piece	4
12260	Field Coil Assembly Complete (Includes the next 20 Items) (Do not count old style parts)	1
12203	Upper Field Coil Assembly Complete (Includes the next Item)	1
27128	Clip on Shunt Field Lead for Stud 28212	1
12205	Lower Field Coil Assembly Complete (Includes the next Item)	1
27912	Clip on Lead for Generator Brush Holder Bracket Assembly 12273	1
28904	Insulating Sleeve for Upper and Lower Field Coil connecting Lead (Not shown in Illustration)	1
24008	Clip on Lead for Generator Brush Holder Bracket Assembly 12273 (Old Style) before Serial No. 549843	1
12267	Upper Motor Brush Plate Assembly Complete (Includes the next 2 Items)	1
22359	Stud for Holding Grounded Motor Brush Arm Assembly 12251	1
22007	Plain Washer for Stud 22359	1
22520	Rivet for attaching Upper Brush Plate Assembly 12267	2
26710	Clip for Switch Spring 25960 on Upper Motor Brush Plate Assembly 12267	1
23226	Insulating Bushing for Screw 20035	2
20219	Insulator for Clip 26710	2
23197	Lock Plate for Screw 20035	1
20035	Screw for retaining Clip 26710	2
24015	Screw for retaining Lead To Clip 26710	1
23452	Nut for Screw 24015	1
20393	Lock Washer for Nut 23452	1
20810	Plain Washer for Nut 23452	1
28902	Insulator for Series Strap on Field Coil Assembly 12260 (Inner) (Not shown in Illustration)	1
28903	Insulator for Series Strap on Field Coil Assembly 12260 (Outer) (Not shown in Illustration)	1
29722	Shield for Field Coil Assembly 12260	2
26733	Shield (Metal) for Lower Field Coil Assembly 12205	1
28211	Insulating Block for Stud 28212 (Not shown in Illustration)	1
29056	Stud for Motor Terminal	1
23023	Insulating Bushing for Stud 29056	1
22263	Insulating Washer for Stud 29056	2
22900	Plain Washer for Nut 21116	1
21116	Nut for Stud 29056 (Large)	1
21105	Lock Washer for Nut 21116	1
26785	Nut for Stud 29056 (Small)	1
22395	Clip for retaining Lead to Stud 29056	1
20137	Lock Washer for Nut 25361	1
28214	Nut for Stud 28212 (Generator Terminal, Large)	1
26725	Insulator (Fish Paper) on Inside of Frame for Stud 29056	1
26769	Name Plate for Motor Generator	1
12229	Switch to Terminal Lead Assembly Complete (Includes the next 2 Items)	1
27117	Clip for Switch End of Lead Assembly 12229	1
27912	Clip for Terminal End of Lead Assembly 12229	1
28212	Stud for connecting Generator and Shunt Field	2
28585	Clip for Terminal End of Lead Assembly 12229 (Old Style) before Serial No. 549843	1
26675	Stud for connecting Shunt Field (Old Style) before Serial No. 549843	1
26677	Stud for connecting Generator Field (Old Style) before Serial No. 549843	1
20791	Lock Washer for Stud 26677 (Old Style) before Serial No. 549843	1
20495	Lock Washer for Stud 26675 (Old Style) before Serial No. 549843	1
21036	Insulating Washer for Studs 26675 and 26677 (Old Style) before Serial No. 549843	2
20109	Plain Washer for Studs 26675 and 26677 (Old Style) before Serial No. 549843	2
25361	Nut for Stud 26675 (Old Style) before Serial No. 549843	1
28213	Nut for Stud 28212 (Shunt Field Terminal) (Large)	1
20143	Lock Washer for Nut 26676	2
26704	Insulating Bushing for Stud 28212	2
20125	Insulating Washer for Stud 28212 (Outside)	2

No. 82. MOTOR GENERATOR—Cont'd

Piece Number	NAME OF PART	Quantity Required
20109	Plain Washer for Stud 28212	2
22395	Clip for retaining Lead on Stud 28212 (Generator Terminal)	1
25361	Nut on Stud 29056 for retaining (lip 22395	1
26784	Clip for retaining Lead on Stud 28212 (Shunt Field Terminal)	1
26676	Nut for retaining Clips 26784 and 22395	2
26662	Plate on Generator Frame Assembly 12265 for attaching Upper Motor Brush Plate Assembly 12267	1
26750	Screw for attaching Plate 26662	3
21746	Screw for attaching tipper Motor Brush Plate Assembly 12267	2
26664	Insulating Bushing for Screw 21 746 (Not shown in Illustration)	2
2(1125	Insulating Washer for Screw 21746	4
20109	Plain Washer for Screw 21746	2
20495	Lock Washer for Screw 21 746	2
12251	Grounded Motor Brush Arm Assembly Complete (Includes the next 14 Items)	1
26644	Brush Arm for (grounded Motor Brush Arm Assembly 12251	1
24460	Brush for Brush Arm 26644	1
22751	Screw for attaching Brush 24460	2
22826	Lock Plate for Screw 22751	1
25960	Spring on Generator Switch for Grounded Motor Brush Arm Assembly 12251	1
25961	Plate for Spring 25960	1
25762	Insulating Plate for Screw 22654	3
27160	Insulating Bushing for Screw 22654	2
30065	Screw for attaching Spring 25960	2
20790	Plain Washer for Screw 22654	2
20393	Lock Washer for Screw 22654	2
12253	Grounded Motor Brush Arm to Generator Brush Bracket Lead Assembly Complete (Includes the next 2 Items)	1
27123	Clip for Brush Arm End of Lead Assembly 12253	1
28585	Clip for Brush Bracket End of Lead Assembly 12253	1
26730	Spring for Grounded Motor Brush Arm Assembly 12251 (Outer)	1
26276	Spring for Grounded Motor Brush Arm Assembly 12251 (Inner)	1
26274	Insulating \Washer for Grounded Motor Brush Arm Assembly 12251 (Under Cotter Pin 20163).	1
20163	Cotter Pin for retaining Grounded Motor Brush Arm Assembly 12251	1
12269	Generator End Frame Assembly Complete (Includes the next 11 Items)	1
12624	End Frame Assembly (Includes the next 5 Items)	1
23754	Slide Plate for End Frame 26642	1
23963	Guide for retaining Slide Plate 23754 (Outer)	1
23964	Guide for retaining Slide Plate 23754 (Inner)	1
25048	Rivet for retaining Guides 23963 and 23964	4
24111	Felt Plug for Oil Hole in End Frame 26642 (Not shown in Illustration)	1
12988	Ball Bearing Assembly for Clutch End of Armature Shaft	1
26226	Retainer for Ball Bearing Assembly 12988 (Outer)	1
25406	Retainer for Ball Bearing Assembly 12988 (Inner)	1
27170	Screw for retaining Retainers 26226 and 25406	4
21383	Washer (Felt) for Ball Bearing Assembly 12988	2
12270	Generator Clutch Assembly Complete (Includes the next 9 Items)	1
26716	Shell for Generator Clutch Assembly 12270	1
25716	Cam for Generator Clutch Assembly 12270	1
22290	Roll for Cam 25716	4
22340	Plunger for Roll 22290	4
28283	Spring for Plunger 22340	4
2861.0	Retainer for Roll 22290 (Inner)	1
2861.1	Retainer for Roll 22290 (Outer)	1
27114	Screw for retaining Retainers 28610 and 28611	4
20345	Lock Washer for Screw 27114	4
1.1823	Inner Race and Rolls Assembly for Pinion End of Amature Shaft	1
12220	Armature Assembly for Motor Generator	1
21703	Oil Retainer (Felt) for Inner Race and Rolls Assembly 11823 (Outer)	1
20803	Oil Retainer (Felt) for Inner Race and Rolls Assembly 11823 (Inner)	1
20808	Retainer for Oil Retainer 20803	1
24622	Lock Washer for Clamp Screw 24496.	1
21536	Clamp Washer for Motor Pinion 25670	1
24496	Clamp Screw for Motor Pinion 25670	1
24829	Lock Washer for Clamp Screw 24828	1
24770	Clamp Washer for Generator Clutch Assembly 12270	1
24828	Clamp Screw for Generator Clutch Assembly 12270	1
25638	Spacing Collar for retaining Inner Race and Balls Assembly 11823 (Outer)	1
26705	Spacing Sleeve on Armature Shaft for Spacing Collar 25638	1
25670	Motor Pinion for Armature Shaft	1
26227	Cover for Generator Clutch Assembly 12270	1

No. 82. MOTOR GENERATOR—Cont'd

Piece Number	NAME OF PART	Quantity Required
12264	Motor End Frame Assembly Complete (Includes the next 9 Items)	1
12263	Motor End Frame Assembly (Includes the next 3 Items)	1
26999	Retainer (Felt) on End Frame Assembly 12263 for Shift Rod	1
26659	Plate for retaining Retainer 26999	1
20102	Rivet for retaining Plate 26659	2
25812	Outer Race for Inner Race and Rolls Assembly 11823	1
23243	Retainer for Outer Race 25812 (Inner)	1
21412	Screw for retaining Retainer 23243	3
20241	Lock Washer for Screw 21412	3
24111	Felt Plug for Oil Hole in Motor End Frame Assembly 12264 (Not shown in Illustration)	1
12262	Lower Motor Brush Plate Assembly Complete (Includes the next 16 Items)	1
12261	Lower Motor Brush Plate Assembly (Includes the next 3 Items)	1
26709	Stud for holding lower Motor Brush Arm Assembly 122.52	1
26781	Instruction Plate on Plate 26647 (Not shown in Illustration)	1
23627	Rivet for retaining Instruction Plate 26781 (Not shown in Illustration)	2
12252	Lower Motor Brush Arm Assembly Complete (Includes the next- 7 Items)	1
12255	Lower Brush Arm Assembly (Includes the next 3 Items)	1
27207	Roll for Brush Arm 26643 (Lower)	1
25940	Roll for Brush Arm 26643 (Upper)	1
25947	Plain Washer for retaining Rolls 27207 and 25940	2
24460	Brush for Lower Motor 'Brush Arm Assembly 12252	1
22826	Lock Plate for Screw 22751	1
22751	Screw for attaching Brush 24460	2
26713	Spring for Lower Motor Brush Arm Assembly 12252 (Outer)	1
26276	Spring for Lower Motor Brush Arm Assembly, 12252 (Small) (Inner)	1
26274	Plain Washer for retaining Lower Motor Brush Arm Assembly 12252	1
20163	Cotter Pin for retaining Washer 26274_	1
12272	Generator Brush Holder Bracket Assembly (Includes the next Item)	1
26700	Spring Stud for Bracket Assembly 12272	1
1.1813	Generator Brush Arm Assembly Complete (Right) (Includes the next 5 Items)	1
11728	Generator Brush Arm Assembly (Right) (Includes the next item)	1
25491.	Spring Stud for Brush Arm 25358 (Not shown in Illustration)...	1
23079	Brush for Generator Brush Arm Assembly 11728	1
22751	Screw for Attaching Brush 23079	2
2281.7	Lock Plate for Screw 22751	1
11814	Generator Brush Arm Assembly Complete (Left) (Includes the next 5 Items)	1
11729	Generator Brush Arm Assembly (Left) (Includes the next Item)	1
25491	Spring Stud for Brush Arm 25359 (Not shown in Illustration)	1
23079	Brush for Generator Brush Arm Assembly 11729	1
22751	Screw for attaching Brush 23079	2
22817	Lock Plate for Screw 22751	1
1.2170	Third Generator Brush Arm Assembly Complete (Includes the next 9 Items)	1
12169	Third Generator Brush Arm Assembly (Includes the next Item)	1
25491	Spring Stud for Brush 26640	1
26639	Extension Brush Arm for Third Generator Brush Arm Assembly 12170..	1
26767	Third Brush for Extension Brush Ann 26639	1
22817	Lock Plate for Screw 26766	1
26766	Screw for attaching Third Brush 26767	2
25931	Screw for attaching Extension Brush Arm 26639. . .	2
20393	Lock Washer for Screw 25931	2

No. 82. MOTOR GENERATOR—Cont'd

Piece Number	NAME OF PART	Quantity Required
		2
20810	Plain Washer for Screw 25931	1
25356	Spring for Generator Brush Arm Assembly 11814	1
25357	Spring for Generator Brush Arm Assembly 11813	1
25783	Spring for Third Generator Brush Arm Assembly 12170	2
20494	Plate for Studs 25781 and 25777	2
23623	Insulator for Studs 25781 and 25777	1
26701	Stud for holding Generator Brush Arm Assembly 11813	2
23249	Insulating Bushing for Studs 25781 and 25777	3
20068	Nut for attaching Studs 25781, 25777 and 26701	3
20495	Lock Washer for Nut 20068	1
25777	Stud for holding Third Generator Brush Arm Assembly 12170 and Generator Brush Arm Assembly 11814	1
25781	Spring Stud for Third Generator Brush Arm Assembly 12170	1
25784	Insulating Sleeve for Spring Stud 25781 (Not shown in Illustration)	1
25779	Insulating Bushing on Stud 25777 for Third Generator Brush Arm Assembly 12170	1
21036	Insulating Washer for Third Generator Brush Arm Assembly 12170 (Inner)	1
21298	Insulating Washer for Third Generator Brush Arm Assembly 12170 (Outer)	1
25723	Cotter Pin for retaining Third Generator Brush Arm Assembly 12170 (Not shown in Illustration)	1
24201	Plain Washer under Cotter Pin 25723	1
20300	Screw for attaching Lead to Third Generator Brush Assembly 12170	1
20393	Lock Washer for Screw 20300	1
12660	Motor End Frame Cover Plate Assembly Complete	1
22690	Screw for attaching Lower Motor Brush Plate Assembly 12262	1
20495	Lock Washer for Screw 22690	3
26750	Screw for attaching Generator Brush Holder Bracket Assembly 12273	3
26723	Screw for attaching Generator End Frame Assembly 12269 (Dowel)	3
24621	Screw for attaching Generator End Frame Assembly 12269 (Plain)	2
26724	Screw for attaching Motor End Frame Assembly 12264 (Round Head) (Dowel)	2
26723	Screw for attaching Motor End Frame Assembly 12264 (Hexagon Head) (Dowel)	1
24621	Screw for attaching Motor End Frame Assembly 12264 (Plain)	1
26670	Top Cover for both Ends of Motor Generator	2
26702	Fastener for retaining Top Cover 26670	2
25626	Terminal Clip for Generator and Battery Terminals	2
23365	Fibre Ferrule for Clip 25626	2
26997	Terminal Clip for Field Terminal	1
23365	Fibre Ferrule for Terminal Clip 26997	1
25796	Motor Terminal Clip	1

HUDSON 1918 SUPER-SIX - MODEL J

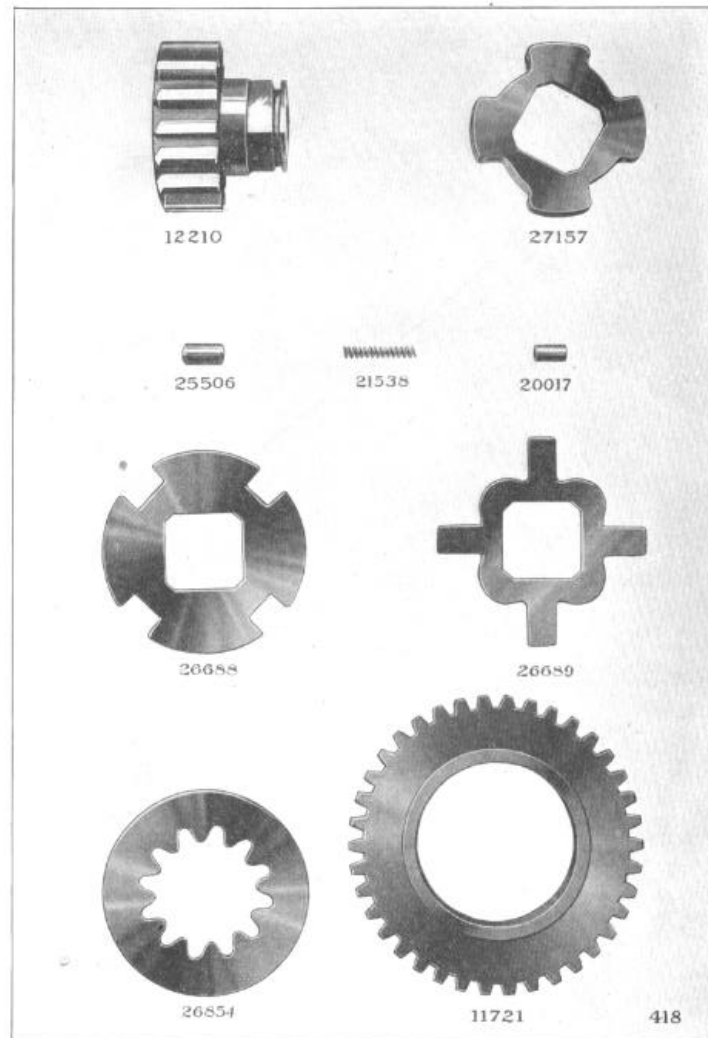

No. 12207 MOTOR CLUTCH
(Illustrated on page 7)

Piece Number	NAME OF PART	Quantity Required
12207	MOTOR CLUTCH COMPLETE (Includes the next 9 Items)	1
12210	Pinion Assembly	1
11721	Gear Assembly	1
27157	Cam for Gear Assembly 11721	1
25506	Roll for Cam 27157	4
20017	Plunger for Roll 25506	4
21538	Spring for Plunger 20017	4
26854	Retainer for Roll 25506 (Inner)	1
26688	Retainer for Roll 25506 (Outer)	1
26689	Retainer for retaining Retainer 26688	1

Hudson 1918 Super-Six - Model J

No. 5134 DISTRIBUTOR

(Illustrated on page 8)

Piece Number	NAME OF PART	Quantity Required
5134	DISTRIBUTOR COMPLETE	1
12306	Housing Assembly Complete (Includes the next 7 Items)	1
23432	Clip for Distributor Head Assembly 11839 (With Clip 23433)	1
23433	(lip for Distributor Head Assembly 11839 (Long Tongue Clip)	1
24664	Clip for Distributor Head Assembly 11839 (Single)	1
25048	Rivet for retaining Clips 23432 and 23433	2
25049	Rivet for retaining (lip 24664	1
26137	Stud for retaining Clip 24664	1
20775	Cup for Housing 26841	1
1.2307	Distributor Mounting Plate Assembly Complete (Includes the next 13 Items)	1
12308	Distributor Mounting Plate Assembly (Includes the next 2 Items)	1
26868	Plate for Distributor Mounting Plate Assembly 12308 (Not shown in Illustration)	1
20775	(up for Plate 26868	1
26865	Connector Plate for Distributor Mounting Plate Assembly 12308 (Not shown in Illustration)	1
26856	Insulating Plate for Connector Plate 26865 (Not shown in Illustration)	1
26867	Plate for retaining Contact Screw Assembly 12411 (Not shown in Illustration)	1
27228	Stud for Holding Distributor Mounting Plate Assembly 12307 (Not shown in Illustration)	3
26293	Insulating Bushing for Stud 27228 (Not shown in Illustration)	3
26284	Stud for retaining Contact Arm Assembly 12413 (Not shown in Illustration)	1
28834	Nut for Stud 26284 (Not shown in Illustration)	1
27132	Lock Washer for Nut 28834 (Not shown in Illustration)	1
24336	Insulating Washer for Stud 26284 (Not shown in Illustration)	1
26292	Insulating Bushing for Stud 26284 (Not shown in Illustration)	1
26132	Stud for Resistance Unit Assembly 12029	1
22616	Plain Washer for Stud 26132	1
20704	Nut for Retaining Stud 26132	1
20791	Lock Washer for Nut 20704	1
20310	Plain Washer for Nut 20704	1
23410	Insulating Washer for Nut 20704	1
20076	Insulating Washer for Stud 26132	1
22738	Insulating Bushing for Stud 26132	1
26208	Nut for Retaining Resistance Unit Assembly 12029	1
20495	Lock Washer for Nut 26208	1
12029	Resistance Unit Assembly Complete (Includes the next 5 Items)	1
12013	Resistance Unit Assembly	1
26209	Screw for retaining Clip 26153	1
26207	Nut for Screw 26209	1
20393	Lock Washer for Nut 26207	1
261.53	Clip for retaining Terminal (lip 23374	1
26829	Insulating Bushing for Stud 26137	1
13473	Governor Weight Mounting Plate and Shaft Assembly (Includes the next 3 Items)	1
12312	Governor Weight and Mounting Plate Assembly (Service)	1
26855	Shaft for Distributor (Outer)	1
28566	Dowel Pin for Shaft 26855	1
26863	Advance Sleeve for Shaft 26855	1
26862	Shaft for Distributor (Inner)	1
25922	Advance Pin for connecting Shafts 26862 and 26855	1
22884	Plain Washer for retaining Advance Pin 25922	2
25921	Clip for retaining Advance Pin 25922	2
27221	Cone for Shaft 26855 (Upper)	1
23720	Clip for retaining Cone 27221	1
27222	Cone for Distributor Shaft 26855 (Lower)	1
27216	Stud for retaining Cones 27221 and 27222	2
21786	Advance Ring for Shaft 26855	1
26973	Pin for Advance Ring	1
10282	Retainer and Balls Assembly	2
21443	Clamp Nut for Shaft 26855	1
21.444	Lock Nut for Clamp Nut 21443	1
29124	Spring for Governor Weight and Mounting Plate Assembly 12312	3
291.25	Clip for Spring 29124 (Not shown in Illustration)	3
27290	Spring for Governor Weight Assembly (Old Style) to be used with all Distributor Housings that are not Stamped with the letter "N"	3

Hudson 1918 Super-Six - Model J

No. 5134 DISTRIBUTOR - Continued

(Illustrated on page 8)

Piece Number	NAME OF PART	Quantity Required
12309	Advance Lever Shaft Assembly Complete (Includes the next 5 Items)	1
12630	Advance Shaft Assembly	1
26933	Lever for Advance Shaft Assembly 12630	1
23144	Screw for retaining Lever 26933	1
23239	Nut for Screw 23144	1
20137	Lock Washer for Nut 23239	1
26869	Sleeve for Advance Shaft Assembly 12630	1
12313	Advance Yoke Assembly	1
21797	Screw for Advance Yoke Assembly 12313	1
25587	Cam for operating Contact Arm Assembly 12413	1
20238	Plain Washer for Cam 25587	1
13474	Distributor Cam Adjustment Screw Assembly for retaining Cam 25587	1
12413	Contact Arm Assembly	1
12411	Contact Screw Assembly	1
26836	Nut for retaining Contact Screw Assembly 12411	1
25723	Cotter Pin for retaining Contact Arm Assembly 12413	1
25634	Spring for Contact Arm Assembly 12413	1
12368	Condenser Assembly (Includes the next 2 Items)	1
25324	Screw for attaching Condenser Assembly 12335	4
23277	Lock Washer for Screw 25324	4
12316	Cover Plate and Name Plate Assembly (Includes the next 2 Items)	1
27585	Name Plate for Distributor	1
27995	Rivet for Name Plate 27585	4
26918	Screw for retaining Cover Plate and Name Plate Assembly 12316	4
28031	Lock Washer for Screw 26918	4
12167	Distributor Rotor Assembly Complete (Includes the next 2 Items) (Do not count Old Style Parts)	1
26645	Connector for Distributor Rotor Assembly 12167 (Old Style)	1
23142	Screw for Connector 26645 (Old Style)	1
24414	Spring for Brush 23895	1
23895	Brush for Distributor Rotor Assembly 12167	1
11839	Distributor Head Assembly Complete (Not shown in Illustration) (Includes the next 2 Items) (Do not count Old Style Parts)	1
21425	Plunger (Old Style) for Distributor Head Assembly 11839 (Approximately 1/2" Diameter)	1
27608	Plunger for Distributor Head Assembly 11839 (Approximately 1/2" Diameter) (Not shown in Illustration)	1
21424	Spring (Old Style) for Plunger 21425 (Approximately 1/2" Diameter)	1
27607	Spring for Plunger 27608 (Approximately 1/2" Diameter) (Not shown in Illustration)	1
11770	High Tension Terminal Assembly (Not shown in Illustration)	7
25729	Rubber Washer for High Tension Terminal Assembly 11770 (Not shown in Illustration)	7
23374	Terminal Clip for connecting Distributor (Not shown in Illustration)	1
12741	Wrench for Distributor (Not shown in Illustration)	1

HUDSON 1918 SUPER-SIX - MODEL J

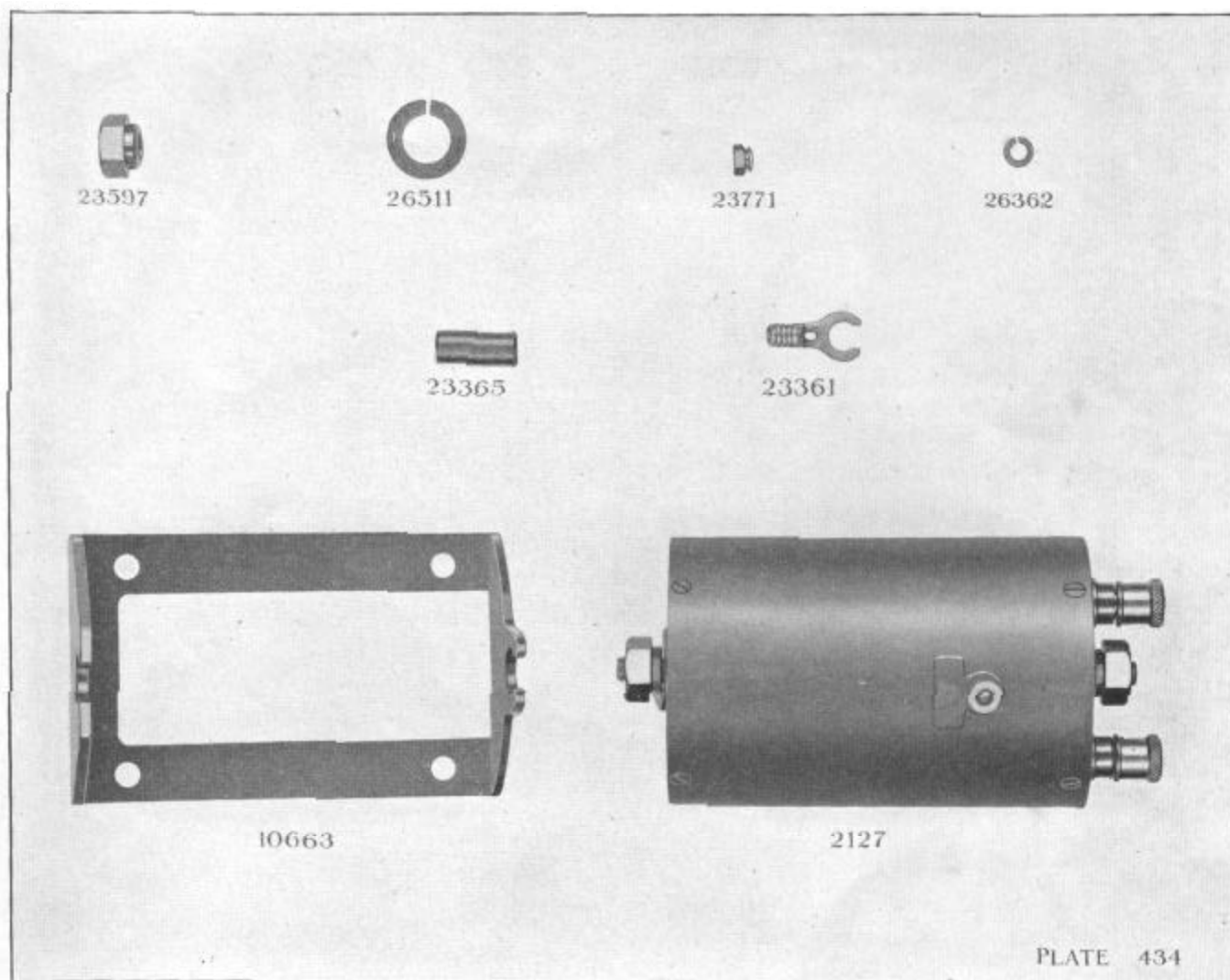

No. 2127 IGNITION COIL

(Illustrated on page 11)

Piece Number	NAME OF PART	Quantity Required
2127	IGNITION COIL COMPLETE	1
23771	Nut for High Tension Terminal	1
26362	Lock Washer for Nut 23771	1
23597	Nut for retaining Bracket Assembly 10663	2
26511	Lock Washer for Nut 23597	2
10663	Bracket Assembly	1
23361	Terminal Clip for connecting Ignition Coil 2137	2
23365	Fibre Ferrule for Terminal Clip 23361	2

HUDSON 1918 SUPER-SIX - MODEL J

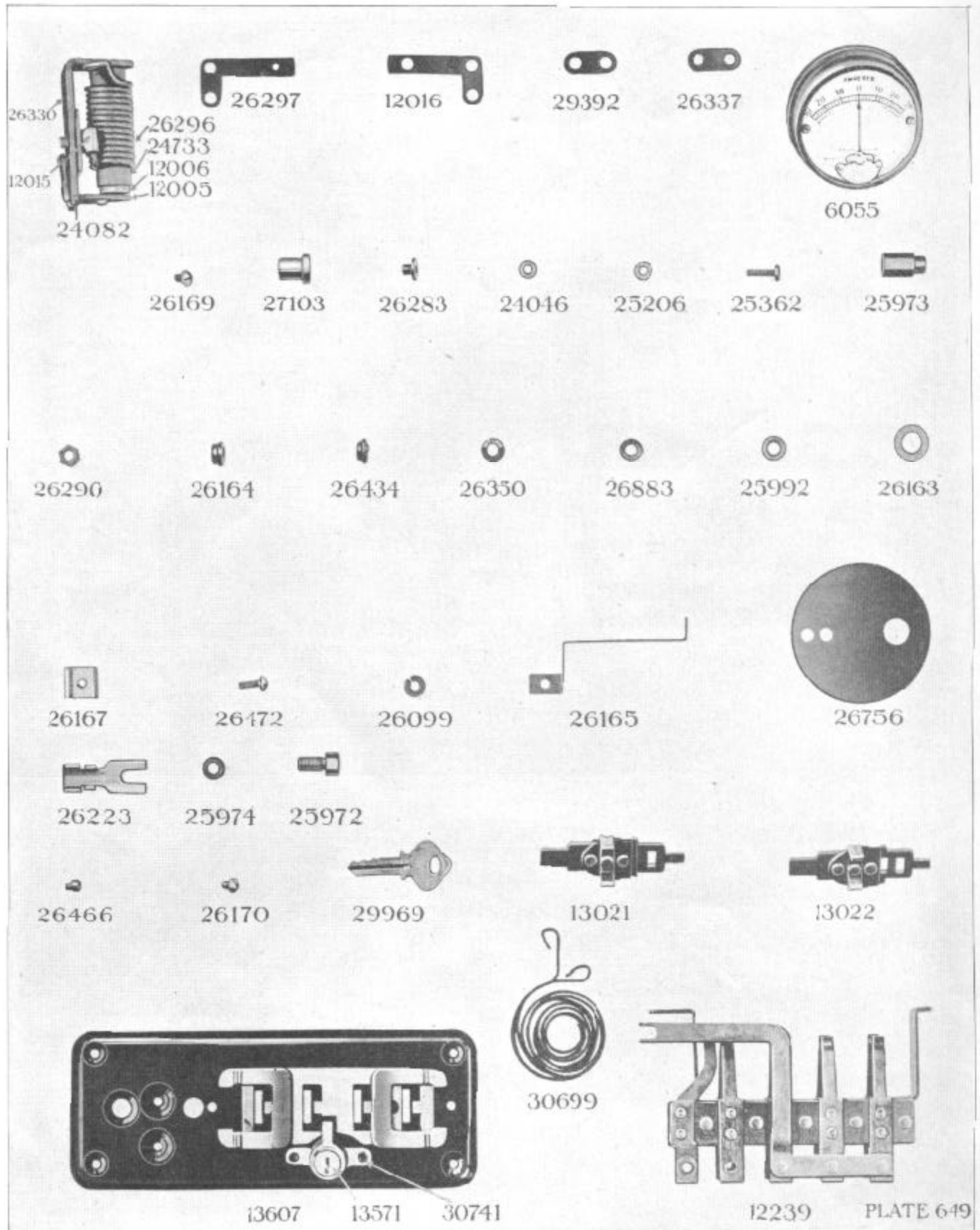

No. 1106 COMBINATION SWITCH

Hudson 1918 Super-Six - Model J

No. 1106 COMBINATION SWITCH

(Illustrated on page 12)

Piece Number	NAME OF PART	Quantity Required
1106	COMBINATION SWITCH COMPLETE	1
13607	Mounting Plate and Locking Device Assembly (Includes the next 3 Items)	1
30741	Rivet for retaining Lock Assembly 13571	2
13571	Lock Assembly for Switch (Includes the next Item)	1
29969	Key for locking Switch (Give Series No. of Lock)	2
12239	Terminal Frame Assembly	1
6055	Ammeter Complete (Includes the next 3 Items)	1
26290	Nut for Ammeter Stud (Short)	1
25973	Terminal Nut (Long)	1
26350	Lock Washer for Nut 26290 and Terminal Nut 25973	2
13021	Plunger Assembly (Ignition)	1
13022	Plunger Assembly (Lighting)	3
27103	Button for Plunger Assemblies 13021 and 13022	4
26883	Plain Washer for Ammeter Stud (Small)	2
26756	Insulator for Ammeter 6055	1
26164	Insulating Bushing for Ammeter Stud (Thick Shoulder)	1
26434	Insulating Bushing for Ammeter Stud (Thin Shoulder)	1
26163	Plain Washer for Ammeter Stud (Large)	1
25992	Insulating Washer for Ammeter Stud	3
26165	Strap for connecting Ammeter 6055 and Terminal Frame Assembly 12239	1
26170	Screw for retaining Terminal Frame Assembly 12239 (Lighting End of Switch)	1
26466	Screw for retaining Terminal Frame Assembly 12239 under Ammeter 6055	1
30699	Resistance Coil for Terminal Frame Assembly 12239	1
26472	Screw for retaining Clip 26167	6
27278	Lock Washer for Screw 26472	6
26167	Clip for retaining Terminal Clip 26223	5
26100	Nut on Screw 26472 for retaining Resistance Coil 26168 (Not shown in Illustration)	1
26162	Plain Washer for Screw 26472 (Not shown in Illustration)	1
26169	Screw for retaining Circuit Breaker 5706	2
5706	Circuit Breaker Complete (Includes the next 20 Items)	1
12016	Contact Spring Assembly (Upper Contact)	1
26297	Spring for operating Armature Assembly 12005	1
29392	Metal Plate under Spring 26297	1
26337	Insulating Plate under Contact Spring Assembly 12016	1
25362	Screw for retaining Contact Spring Assembly 12016	2
26283	Insulating Bushing for Screw 25362	2
25206	Lock Washer for Screw 25362	2
24046	Plain Washer for Screw 25362	2
12072	Circuit Breaker Assembly for Circuit Breaker 5706	1
12005	Armature Assembly	1
26296	Coil for Circuit Breaker 5706	1
12006	Core Assembly	1
24049	Screw for retaining Core Assembly 12006 (Not shown in Illustration)	1
24733	Insulating Sleeve for Core Assembly 12006	1
24082	Pin for retaining Armature Assembly 12005	1
12007	Bracket Assembly (Includes the next 4 Items)	1
12015	Terminal Assembly (Lower Contact)	1
26320	Rivet for retaining Terminal Assembly 12015 (Not shown in Illustration)	2
26327	Insulator for Terminal Assembly 12015 (Not shown in Illustration)	1
26330	Bracket for Bracket Assembly 12007	1
26223	Terminal Clip for connecting Switch	6
25972	Terminal Screw for Terminal Nut 25973	1
25974	Washer for Terminal Screw 25972	1

HUDSON 1919 SUPER-SIX - MODEL J



No. 140 MOTOR GENERATOR

No. 140 MOTOR GENERATOR

HUDSON 1919 SUPER-SIX

DELCO SYSTEM 216

No. 140 MOTOR GENERATOR

Illustrated on pages 14 and 15

Piece Number	NAME OF PART	Quantity Required
140	MOTOR GENERATOR	1
12265	Generator Frame Assembly (Includes the next 2 Items)	1
22065	Screw for Pole Piece	1
20039	Dowel Pin for Pole Piece	4
12260	Field Coil Assembly Complete (Includes the next 20 Items)	1
12203	Upper Field Coil Assembly Complete (Includes the next Item)	1
27128	Clip on Shunt Field Lead for Stud 28212	1
12205	Lower Field Coil Assembly Complete (Includes the next Item)	1
2791.2	Clip on Lead for Generator Brush Holder Bracket Assembly 12273	1
28904	Insulating Sleeve for Upper and Lower Field Coils connecting Lead (Not shown in Illustration)	1
12267	Upper Motor Brush Plate Assembly Complete (Includes the next 2 Items)	1
22359	Stud for holding Grounded Motor Brush Arm Assembly 12251	1
22007	Plain Washer for Stud 22359	1
22520	Rivet for attaching Upper Motor Brush Plate Assembly 12267	2
26710	Clip for Switch Spring 25960 on Upper Motor Brush Plate Assembly 12267	1
23226	Insulating Bushing for Screw 20035	2
20219	Insulator for Clip 26710	2
23197	Lock Plate for Screw 20035	1
20035	Screw for Retaining (lip 26710)	2
24015	Screw for Retaining Lead to Clip 26710	1
23452	Nut for Screw 24015	1
20393	Lock Washer for Nut 23452	1
20810	Plain Washer for Nut 23452	1
28902	Insulator for Series Strap on Field Coil Assembly 12260 (Inner) (Not shown in Illustration)	1
28903	Insulator for Series Strap on Field Coil Assembly 12260 (Outer) (Not shown in Illustration)	1
29722	Shield for Field Coil Assembly 12260 (Insulating)	2
26733	Shield (Metal) for Lower Field Coil Assembly 12205	1
28211	Insulating Block for Stud 28212 (Not shown in Illustration)	1
29056	Stud for Motor Terminal	1
23023	Insulating Bushing for Stud 29056	1
22263	Insulating Washer for Stud 29056	2
22900	Plain Washer for Nut 21116	1
21116	Nut for Stud 29056 (Large)	1
21105	Lock Washer for Nut 21116	1
26785	Nut for Stud 29056 (Small)	1
22395	Clip for Retaining Lead to Stud 29056	1
20137	Lock Washer for Nut 25361	1
28214	Nut for Stud 28212 (Generator Terminal Large)	1
26725	Insulator (Fish paper) on Inside of Frame for Stud 29056	1
26769	Name Plate for Motor Generator	1
12229	Switch to Terminal Lead Assembly Complete (Includes the next 2 Items)	1
27117	Clip for Switch End of Lead Assembly 12229	1
27912	Clip for Terminal End of Lead Assembly 12229	1
28212	Stud for connecting Generator and Shunt Field ..	2
28213	Nut for Stud 28212 (Shunt Field Terminal Large)	1
20143	Lock Washer for Nut 26676	2
26704	Insulating Bushing for Stud 28212	2
20125	Insulating Washer for Stud 28212 (Outside)	2
20109	Plain Washer for Stud 28212	2
22395	Clip for Retaining Lead on Stud 28212 (Generator Terminal)	1
25361	Nut on Stud 29056 for Retaining (lip 22395)	1
26784	Clip for Retaining Lead on Stud 28212 (Shunt Field Terminal)	1
26676	Nut for Retaining Clips 26784 and 22395	2
26662	Plate on Generator Frame Assembly 12265 for attaching Upper Motor Brush Plate Assembly 12267	1
26750	Screw for attaching Plate 26662	3
21746	Screw for attaching Upper Motor Brush Plate Assembly 12267	2
26664	Insulating Bushing for Screw 21746 (Not shown in Illustration)	2
20125	Insulating Washer for Screw 21746	4

Hudson 1919 Super-Six

No. 140 MOTOR GENERATOR - Continued

(Illustrated on pages 14 and 15)

Piece Number	NAME OF PART	Quantity Required
20109	Plain Washer for Screw 21746	2
20495	Lock Washer for Screw 21746	2
12251	Grounded Motor Brush Arm Assembly Complete (Includes the next 15 Items)	1
26644	Brush Arm for Grounded Motor Brush Arm Assembly 12251. .	1
24460	Brush for Brush Arm 26644	1
22751	Screw for attaching Brush 24460	2
22826	Lock Plate for Screw 22751	1
25960	Spring on Generator Switch for Grounded Motor Brush Arm Assembly 12251	1
25961	Plate for Spring 25960	1
25762	Insulating Plate for Screw 30065	3
27160	Insulating Bushing for Screw 30065	2
304)65	Screw for attaching Spring 25960	2
20790	Plain Washer for Screw 30065	2
20393	Lock Washer for Screw 30065	2
12253	Grounded Motor Brush Arm to Generator Brush Bracket Lead Assembly Complete (Includes the next 2 Items)	1
27123	Clip for Brush Arm End of Lead Assembly 12253	1
28585	Clip for Brush Bracket End of Lead Assembly 12253	1
26730	Spring for Grounded Motor Brush Arm Assembly 12251 (Outer)	1
26276	Spring for Grounded Motor Brush Arm Assembly 12251 (Inner)	1
26274	Insulating Washer for Grounded Motor Brush Arm Assembly 12251 under Cotter Pin 20163	1
20163	Cotter Pin for Retaining Grounded Motor Brush Arm Assembly 12251	1
12272	Generator Brush Holder Bracket Assembly (Includes the next Item)	1
26700	Spring Stud for Generator Brush Holder Bracket Assembly 12273 -	1
11813	Generator Brush Arm Assembly Complete (Right) (Includes the next 5 Items)	1
11728	Generator Brush Arm Assembly (Right) (Includes the next Item)	1
25491	Spring Stud for Generator Brush Arm Assembly 11728	1
23079	Brush for Generator Brush Arm Assembly 11728	1
22751	Screw for attaching Brush 23079	2
22817	Lock Plate for Screw 22751	1
11814	Generator Brush Arm Assembly Complete (Left) (Includes the next 5 Items)	1
11729	Generator Brush Arm Assembly (Left) . (Includes the next Item)	1
25491	Spring Stud for Brush Arm Assembly 11729	1
23079	Brush for Generator Brush Arm Assembly 11729	1
22751	Screw for attaching Brush 23079	2
22817	Lock Plate for Screw 22751	1
12170	Third Generator Brush Arm Assembly Complete (Includes the next 9 Items)	1
12169	Third Generator Brush Arm Assembly. . . (Includes the next Item)	1
25491	Spring Stud for Third Generator Brush Arm Assembly 12169	1
26639	Extension Brush Arm for Third Generator Brush Arm Assembly 12170	1
26767	Third Brush for Extension Brush Arm 26639	1
22817	Lock Plate for Screw 26766	1
26766	Screw for attaching Third Brush 26767	2
25931	Screw for attaching Extension Brush Arm 26639	2
20393	Lock Washer for Screw 25931	2
20810	Plain Washer for Screw 25931	2
25356	Spring for Generator Brush Arm Assembly 11814	1
25357	Spring for Generator Brush Arm Assembly 11813	1
25783	Spring for Third Generator Brush Arm Assembly 12170	1
20494	Plate for Studs 25781 and 25777	2
23623	Insulator for Studs 25781. and 25777	2
26701	Stud for Holding Generator Brush Arm Assembly 11813	1
23249	Insulating Bushing for Studs 25781 and 25777	2
20068	Nut for attaching Studs 25781, 25777 and 26701	3
20495	Lock Washer for Nut 20068	3
25777	Stud for holding Third Generator Brush Arm Assembly 12170 and Generator Brush Arm Assembly 11814	1
25781	Spring Stud for Third Generator Brush Arm Assembly 12170	1
25784	Insulating Sleeve for Spring Stud 25781	1
25779	Insulating Bushing on Stud 25777 for Third Generator Brush Arm Assembly 12170	1

Hudson 1919 Super-Six

No. 140 MOTOR GENERATOR - Continued

(Illustrated on pages 14 and 15)

Piece Number	NAME OF PART	Quantity Required
21036	Insulating Washer for Third Generator Brush Arm Assembly 12170 (Inner)	
21298	Insulating Washer for Third Generator Brush Arm Assembly 12170 (Outer)	
25723	Cotter Pin for Retaining Third Generator Brush Arm Assembly 12170 (Not shown in Illustration)...	
24201	Plain Washer under Cotter Pin 25723	
20300	Screw for attaching Lead to Third Generator Brush Arm Assembly 12170. .	
20393	Lock Washer for Screw 20300	
13892	Motor End Frame Assembly Complete (Includes the next 13 Items)	
12263	Motor End Frame Assembly (Includes the next 3 Items)	
26999	Retainer (Felt) on End Frame Assembly 12263 for Shift Rod	
26659	Plate for Retaining Retainer 26999	
20102	Rivet for Retaining Plate 26659	
11698	Roller Bearing Assembly for Pinion End of Armature Shaft (Includes the next 2 Items)	
11.823	Inner Race and Rolls Assembly	
25812	Outer Race for Inner Race and Rolls Assembly 11823	
23243	Retainer for Roller Bearing Assembly 11698 (Inner)	
21412	Screw for Retaining Retainer 23243	
20241.	Lock Washer for Screw 21412	
24111	Felt Plug for Oil Hole in Motor End Frame Assembly 13892 (Not shown in Illustration)	
21703	Felt Washer for Roller Bearing Assembly 11698 (Outer) and 2080	
20803	Felt Washer for Roller Bearing Assembly 11698 (Inner)	
12262	Lower Motor Brush Plate Assembly Complete (Includes the next 16 Items)	
12261	Lower Motor Brush Plate Assembly (Includes the next 3 Items)	
26709	Stud for holding Lower Motor Brush Arm Assembly 12252	
PAGE 6	NO. 140 MOTOR GENERATOR - HUDSON	
26781	Instruction Plate on Plate 26647 (Not shown in Illustration)	
23627	Rivet for Retaining Instruction Plate 26781 (Not shown in Illustration)	
12252	Lower Motor Brush Arm Assembly Complete (Includes the next 7 Items)	
12255	Lower Brush Arm Assembly (Includes the next 3 Items)	
27207	Roll for Brush Arm 26643 Lower	
25940	Roll for Brush Arm 26643 Upper	
25947	Plain Washer for Retaining Rolls 27207 and 25940	
24460	Brush for Lower Motor Brush Arm Assembly 12252	
22826	Lock Plate for Screw 22751	
22751	Screw for attaching Brush 24460	
26713	Spring for Lower Motor Brush Arm Assembly 12252 (Outer)	
26276	Spring for Lower Motor Brush Arm Assembly 12252 (Inner) (Small)	
26274	Plain Washer for Retaining Lower Motor Brush Arm Assembly 12252	
20163	Cotter Pin for retaining Washer 26274	
12660	Motor End Frame and Cover Plate Assembly	
12269	Generator End Frame Assembly Complete (Includes the next 11 Items)	
12624	End Frame Assembly (Includes the next 5 Items)	
23754	Slide Plate for End Frame Assembly 12269	
23963	Guide for Retaining Slide Plate 23754 (Outer)	
23964	Guide for Retaining Slide Plate 23754 (Inner)	
25048	Rivet for Retaining Guides 23963 and 23964 .	
24111	Felt Plug for Oil Hole in End Frame Assembly 12269 (Not shown in Illustration)	
12988	Ball Bearing Assembly for Clutch End of Armature Shaft	
26226	Retainer for Ball Bearing Assembly 12988 (Outer)	
25406	Retainer for Ball Bearing Assembly 12988 (Inner)	
27170	Screw for Retaining Retainer 26226 and 25406	
21383	Washer (Felt) for Ball Bearing Assembly 12988	
12220	Armature Assembly for Generator	
13893	Generator Clutch Assembly Complete (Includes the next 9 Items)	
30290	Shell for Generator Clutch Assembly 13893	
30292	Cam for Generator Clutch Assembly 13893	

Hudson 1919 Super-Six

No. 140 MOTOR GENERATOR - Continued

(Illustrated on pages 14 and 15)

Piece Number	NAME OF PART	Quantity Required
27714	Plunger for Roll 27714	3
20017	Spring for Plunger 20017	3
20024	Retainer for Roll 27 714 (Inner)	3
30291	Retainer for Roll 27714 (Outer)	1
30526	Screw for Retaining Retainer 30291 and 30526	1
27114	Lock Washer for Screw 27114	4
20345	Screw for attaching Lower Motor Brush Plate Assembly 12262	4
22690	Lock Washer for Screw 22690	3
20495	Roll for Cam 30292	3
26750	Screw for attaching Generator Brush Holder Bracket Assembly 12273	3
26723	Screw for attaching Generator End Frame Assembly 12269 (Dowel)	2
24621	Screw for attaching Generator End Frame Assembly 12269 (Plain)	2
26724	Screw for attaching Motor End Frame Assembly 13892 (Round Head and Dowel)	1
26723	Screw for attaching Motor End Frame Assembly 13892 (Hexagon Head and Dowel)	1
24621	Screw for attaching Motor End Frame Assembly 13892 (Plain)	2
20808	Retainer for Oil Retainer 20803	1
24622	Lock Washer for Clamp Screw 24496	1
21536	Clamp Washer for Motor Pinion	1
24496	Clamp Screw for Motor Pinion	1
24829	Lock Washer for Clamp Screw 24828	1
24770	Clamp Washer for Generator Clutch Assembly 13893	1
24828	Clamp Screw for Generator Clutch Assembly 13893	1
25638	Spacing Collar on Armature Shaft next to Roller Bearing Assembly 11.698	1
26705	Spacing Sleeve on Armature Shaft for Spacing Collar 25638	1
25670	Motor Pinion for Armature Shaft (Used temporarily as 30522 Pinion is not available)	1
30522	Motor Pinion for Armature Shaft	1
26277	Cover for Generator Clutch Assembly 13893	1
26670	Top Cover for both Ends of Motor Generator	2
26702	Fastener for Retaining Top Cover 26670	2
25626	Terminal Clip for Generator and Battery Terminal	2
23365	Fibre Ferrules for Terminal Clip 25626	2
26997	Terminal Clip for Field Terminal	1
23365	Fibre Ferrule for Terminal Clip 26997	1
25796	Motor Terminal Clip	1

Hudson 1919 Super-Six

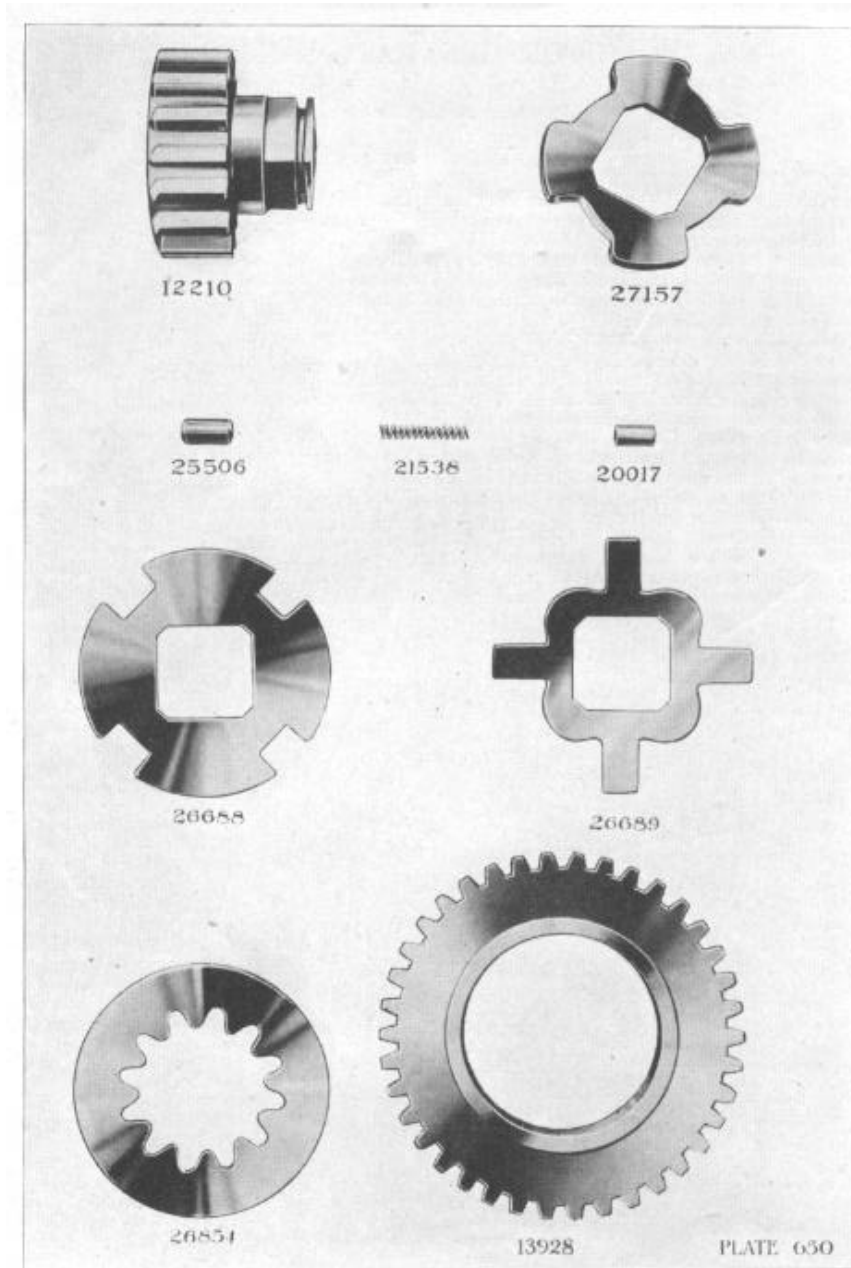
**No. 13861 MOTOR CLUTCH**

(Illustrated on page 20)

Piece Number	NAME OF PART	Quantity Required
13861	MOTOR CLUTCH COMPLETE (Includes the next 9 Items)	1
12210	Pinion Assembly	1
13928	Gear assembly	1
27157	Cam for Gear Assembly 13928	1
15506	Roll for Cam 27157	4
20017	Plunger for Roll 25506	4
21538	Spring for Plunger 20017	4
26854	Retainer for Roll 25506 (Inner)	1
26688	Retainer for Roll 25506 (Outer)	1
26689	Retainer for retaining Retainer 26688	1

Hudson 1919 Super-Six

No. 5134 DISTRIBUTOR

(For description of Piece Parts see page 9 under Hudson 1918 Super-Six Model J)

No. 2127 IGNITION COIL

(For description of Piece Parts see page 11 under Hudson 1918 Super-Six Model J)

No. 1106 COMBINATION SWITCH

(For description of Piece Parts see page 13 under Hudson 1918 Super-Six Model J)

Part No.	Shown On Page Nos.	Part No.	Shown On Page Nos.	Part No.	Shown On Page Nos.	Page No.	Shown On Page Nos.
82	3	13022	13	22817	5-1.7	25729	10
140	16	13473	9	22826	4-5-17-18	25762	4-17
1106	13-21	13474	10	22884	9	25777	6-17
2127	11-21	13571	13	22900	3.-16	25779	6--17
5134	9-21	13607	13	23023	3-16	25781	6-17
5706	13	13861	20	23079	5-17	25783	6--17
6055	13	13892	18	23142	10	25784	6-17
10282	9	13893	18	23144	10	25796	6-19
10663	11	13928	20	23197	3-16	25812	5-18
11698	16	20017	7-18-20	23226	3-16	25921	9
11721	17	20024	18	23239	0	25922	9
11728	5-17	20035	3-16	23243	5-18	25931	5-17
11729	5-17	20039	3-16	23249	6--17	25940	5-18
11770	10	20068	6-17	23277	10	25947	5--18
11813	5-17	20076	9	23361	11	25960	4--17
11814	5-17	20102	5-18	23365	6--11-19	25961	4-17-
11823	4-18	20109	3-4-16-17	23374	10	25972	13
11839	10	20125	3-4-16	23410	9	25973	13
12005	13	20137	3-10-16	23432	9	25974	13
12006	13	20143	3-16	23433	9	25992	1.3
12007	13	20163	4-5-17-18	23452	3-16	26100	13
12013	9	20219	3-16	23597	11	26132	9
12015	13	20238	10	23623	6-17	26137	9
12016	13	20241	5-18	23627	5-18	26153	9
12029	9	20300	6-17	23720	9	26162	13
12072	13	20310	9	23754	4-18	26163	13
12167	10	20345	4-18	23771	11	26164	13
12169	5-17	20393	3-4-5-6-9-16-	23895	10	26165	13
12170	5-17		17	23963	4-18	26167	13
12203	3-16	20494	6-17	23964	4-18	26169	13
12205	3-16	20495	3-4-6-9-17-18	24008	3	26170	13
12207	7	20704	9	24015	3-16	26207	9
12210	7-20	20775	9	24046	13	26208	9
12220	4-18	20790	4-17	24049	13	26209	9
12229	3-16	20791	3-9	24082	13	26223	13
12239	13	20803	4-18	24111	4-5-18	26226	4-18
12251	4-17	20808	4--19	24201	6-17	26227	4
12252	5-18	20810	3- 6-16-17	24336	9	26274	4-5-17-18
12253	4-17	21036	3-6-17	24414	10	26276	4-5-17-18
12255	5-18	21105	3-16	24460	4-5-17-18	26277	19
12260	3-16	21116	3-16	24496	4-19	26283	13
12261	5-18	21298	6-17	24621	6-19	26284	9
12262	5-18	21383	4-18	24622	4-19	26290	13
12263	5-18	21412	5-18	24664	9	26292	9
12264	5	21424	10	24733	13	26293	9
12265	3-16	21425	10	24770	4-19	26296	13
12267	3-16	21443	9	24828	4-19	26297	13
12269	4-18	21444	9	24829	4-19	26320	13
12270	4	21536	4-19	25048	4-9-18	26327	13
12272	5-17	21538	7-20	25049	9	26330	13
12306	9	21703	4-18	25206	13	26337	13
12307	9	21746	4-16	25324	10	26350	13
12308	9	21786	9	25356	6-17	26362	11
12309	10	21797	10	25357	6-17	26434	13
12312	9	22007	3-16	25361	3-4-16	26466	13
12313	10	22065	3-16	25362	13	26472	13
12316	10	22263	3-16	25406	4-18	26511	11
12368	10	22290	4	25491	5-17	26639	5-17
12411	10	22340	4	25506	7-20	26644	4-17
12413	10	22359	3-16	25587	10	26645	10
12624	4-18	22395	3-4-16	25626	6-19	26659	5-18
12630	10	22520	3-16	25634	10	26662	4-16
12660	6-18	22616	9	25638	4-19	26644	4-16
12741	10	22690	6-18	25670	4-19	26670	6-19
12988	4-18	22738	9	25716	4	26675	3
13021	13	22751	4-5-17-18	25723	6-10-17	26676	4-16

Part No.	Shown On Page Nos.	Part No.	Shown On Page Nos.	Part No.	Shown On Page Nos.	Page No.	Shown On Page Nos.
26677	3	26784	4-16	27128	3-16	28283	4
26688	7-20	26785	3-16	27132	9	28566	9
26689	7-20	26829	9	27157	7-20	28585	3-4-17
26700	5-17	26836	10	27160	4-17	28610	4
26701	6-17	26854	7-20	27170	4-18	28611	4
26702	6-19	26855	9	27207	5-18	28834	9
26704	3-16	26856	9	27216	9	28902	3-16
26705	4-19	26862	9	27221	9	28903	3-16
26709	5-18	26863	9	27222	9	28904	3-16
26710	3-16	26865	9	27228	9	29056	3-16
26713	5-18	26867	9	27278	13	29124	9
26716	4	26868	9	27290	9	29125	9
26723	6-19	26869	10	27585	10	29392	13
26724	6-19	26883	13	27607	10	29722	3-16
26725	3-16	26918	10	27608	10	29969	13
26730	4-17	26933	10	27714	18	30065	4-17
26733	3-16	26973	9	27912	3-16	30290	18
26750	4-6-16-19	26997	6-19	27995	10	30291	18
26756	13	26999	5-18	28031	10	30292	18
26766	5-17	27103	13	28211	3-16	30522	19
26767	5-17	27114	4-18	28212	3-16	30526	18
26769	3-16	27117	3-16	28213	3-16	30699	13
26781	5-18	27123	4-17	28214	3-16	30741	13

